



## Prairie Winds Park Preferred Concept Overview

CPS2015-0417 Prairie Winds Park DDP - Att 2.pdf  
ISC: UNRESTRICTED



**Park Centre Area**

The proposed redevelopment of Prairie Winds Park includes the creation of a new park centre area. With the relocation of the tennis courts, the park centre area will include a new plaza that welcomes visitors and functions as the park's main entry.

The main entry plaza will provide access to:

- The main parking lot;
- A new, large playscape for all ages;
- A new basketball court and upgraded skating rink;
- A water play area which includes a rebuilt wading pool with lazy river, spray park (completed in 2014) and more spots for picnicking;
- Walking paths to access all parts of the park, and;
- A renovated and expanded park centre building.

**Park Centre Building**

A renovated and expanded park centre building will better serve the needs of park users by providing year-round access to modern, accessible washrooms.

Upgraded change rooms will be open during the summer, and a bright, new warm-up space will be available for people using the park in the winter.

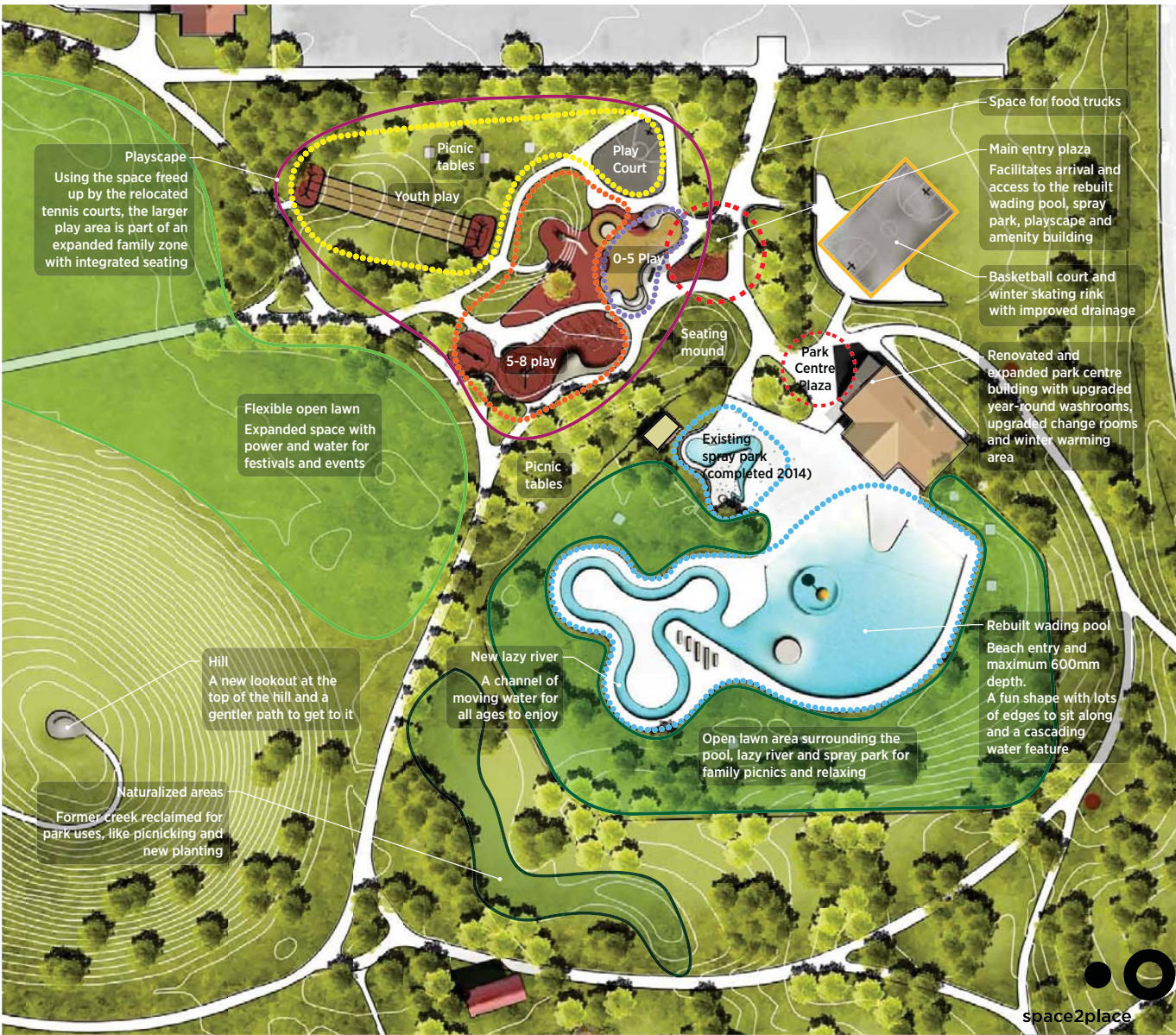

Prairie Winds Park  
**Park Centre Area**

