

Proposed Outline Plan

OUTLINE PLAN 1:1000

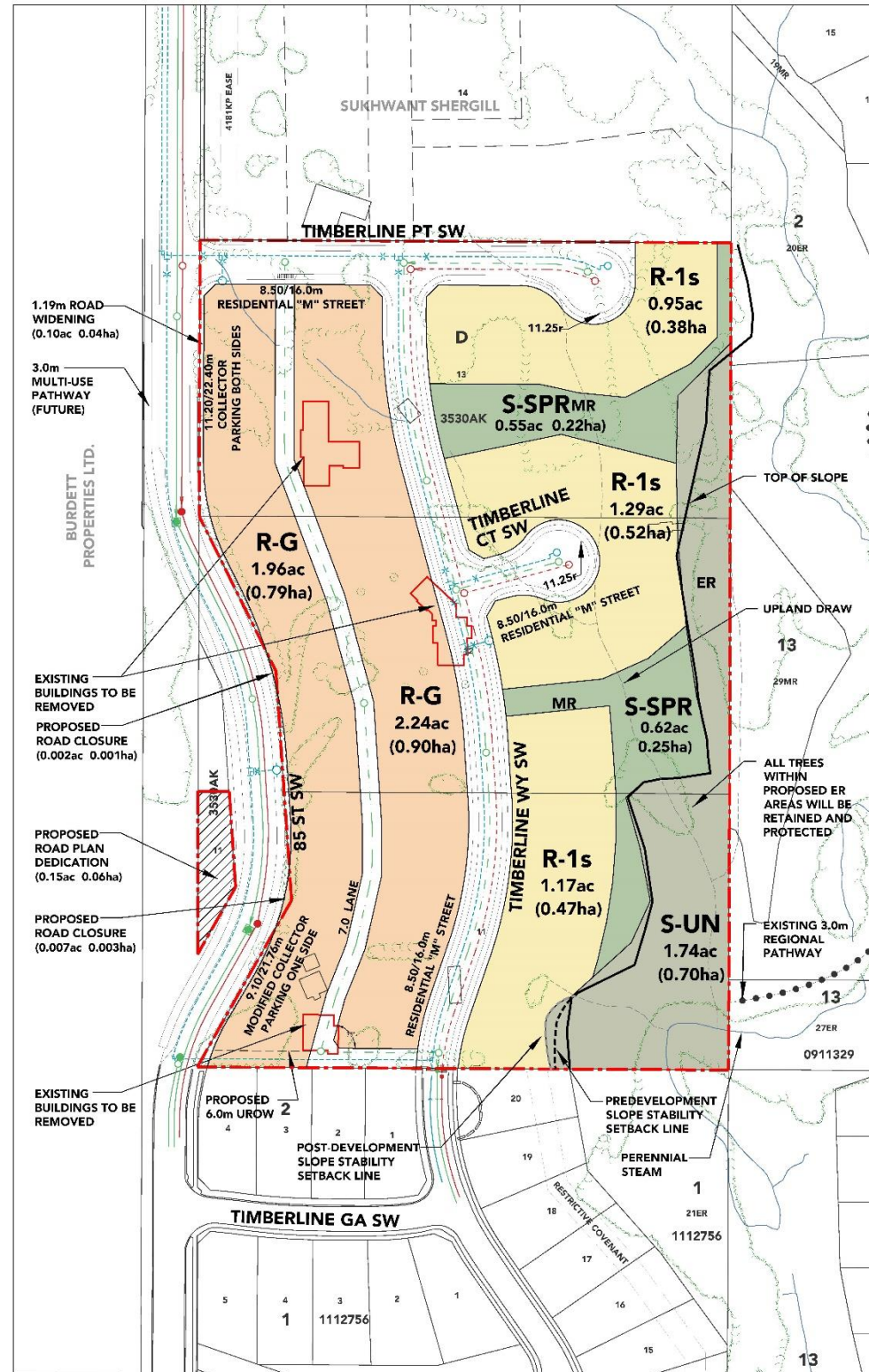

STREET SECTIONS nts.

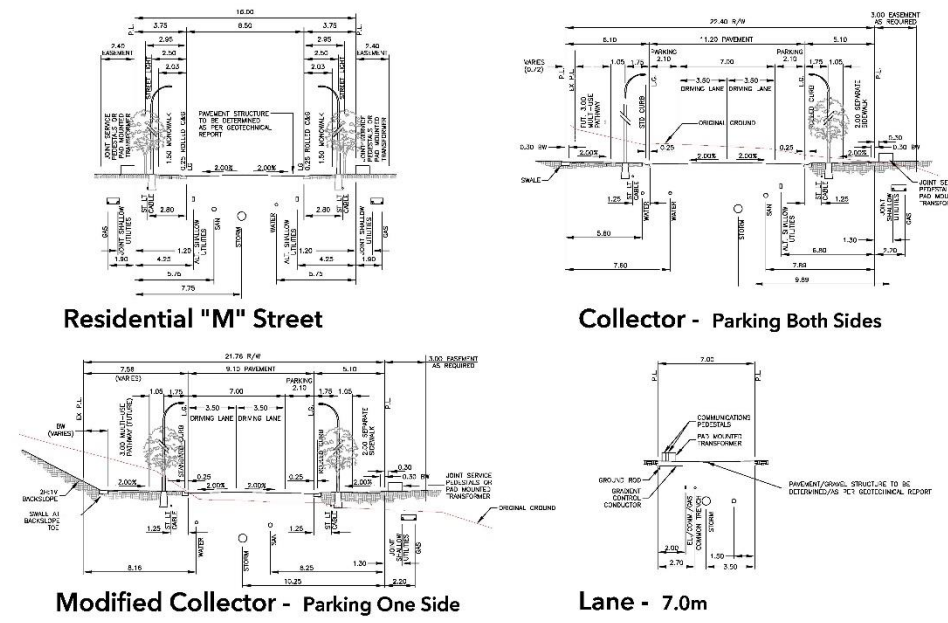

LAND USE REDESIGNATION 1:2000

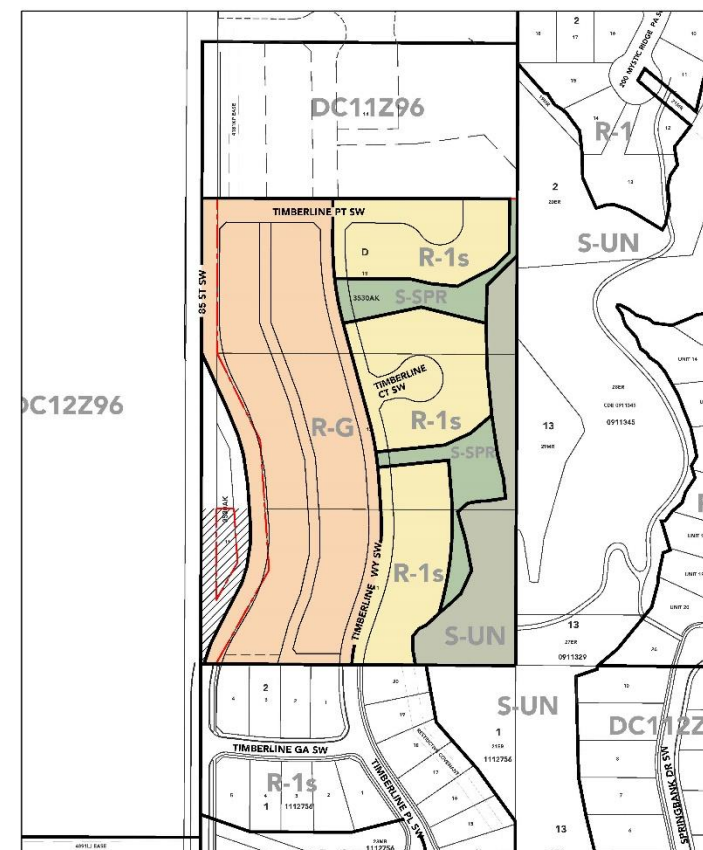

OUTLINE PLAN STATISTICS

	±Acres	±Hectares	%
Total Site Areas	13.47	5.451	
Special Purpose (S-UN) Urban Nature District	1.74	0.704	
Net Developable	11.73	4.747	100.00
Residential (R-1s) Residential One Dwelling District	3.41	1.380	29.07
Residential (R-G) Low Density Mixed Housing District	4.20	1.699	35.80
Special Purpose (S-SPR) School, Park & Community Reserve District	1.17	0.474	10.00
Roads/ Lanes & Road Widening	2.95	1.195	25.14

LAND USE STATISTICS

	±Acres	±Hectares
DC11296 to R-1s	4.98	1.853
DC11296 to R-G	5.35	2.165
DC11296 to S-UN	1.74	0.704
DC11296 to S-SPR	1.27	0.513
DC11296 to DC11296	0.53	0.216

LEGEND

- Outline Plan Boundary
- Existing 3.0m Regional Pathway
- Contours (0.25m Intervals)
- Perennial Stream
- Existing Vegetation
- Upland Draw
- Proposed Sanitary Line
- Proposed Water Line
- Proposed Storm Line
- Existing Sanitary Line
- Existing Water Line
- Existing Storm Line



5119 Elbow Drive SW  
Suite 460  
Calgary, AB  
T2V 1H2

**APPLICATION TYPE**  
OUTLINE PLAN / LAND USE  
REDESIGNATION & ROAD CLOSURE

**CLIENT**  
TRUMAN DEVELOPMENT  
CORPORATION

**PROJECT NUMBER**  
LOC 2018 0226  
18-034

**LEGAL ADDRESS**  
2938, 3028 AND 3118  
85th STREET SW

**DATE**  
2019.05.13

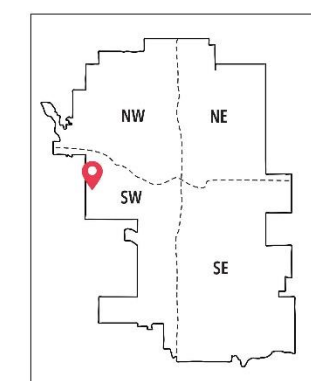

**SCALE**  
AS NOTED

**FIGURE S1**  
OUTLINE PLAN