

Underpass Project Overview

1.1 Project Vision

Make life better everyday by transforming an ordinary space into an extraordinary experience

1.2 Project Boundary



1.3 Project Site Photos

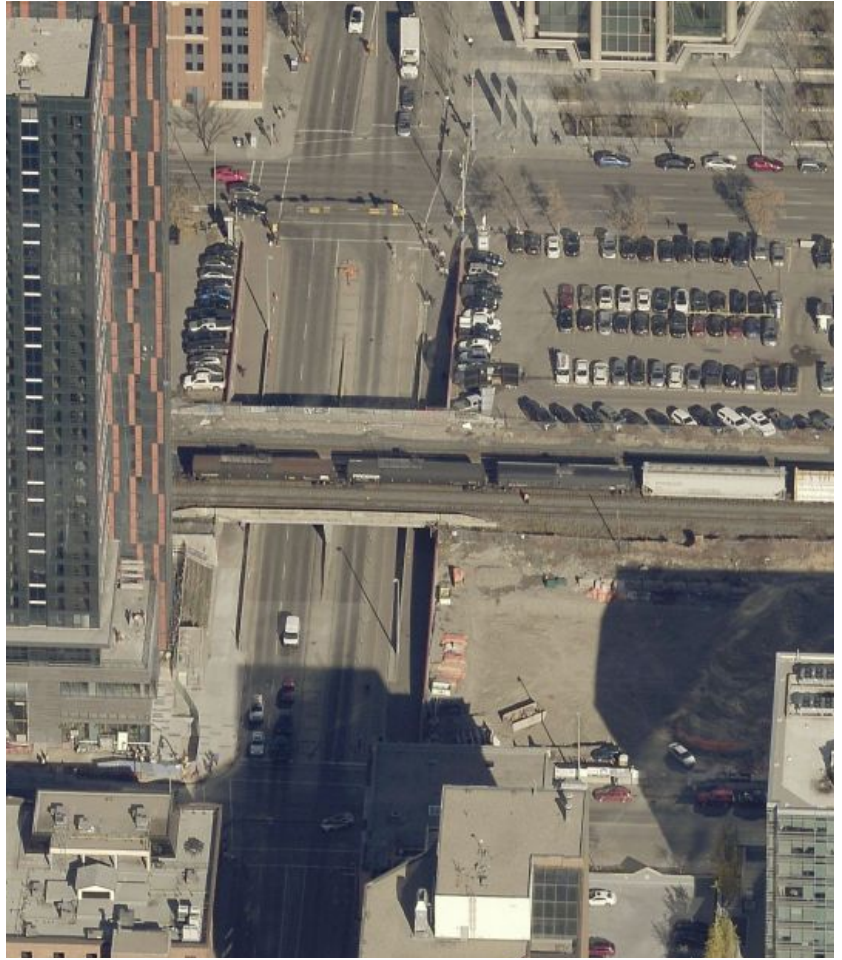

1.4 What We've Heard

What works well?

- Generous sidewalk widths
- The cycle track
- Connection between Beltline and Centre City

What are the issues?

- Lighting + perceptions of safety
- Sidewalk surface
- Maintenance and cleanliness
- Wasted space in the median could be redistributed

What are the opportunities?

- Incorporate greenery
- Addition of public art
- Improve pedestrian lighting
- Make the cycle track permanent
- Repurpose underutilized space
- Integrate with new and future development

1.5 Translating observation + input

Formulating a vision and goals into measurable objectives



1.6 Concept Site Plan (for engagement)

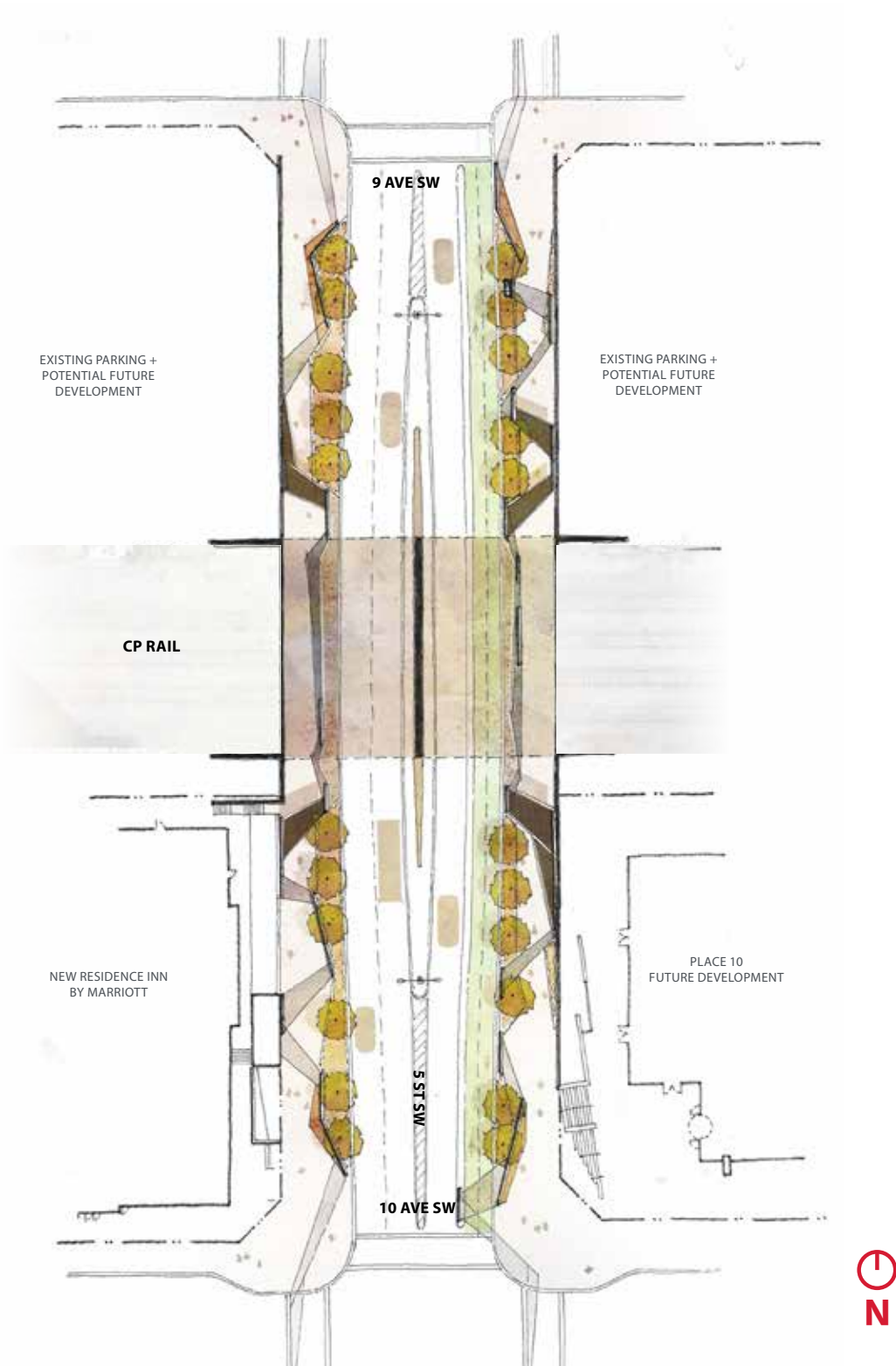

1.7 Concept Perspective (for engagement)

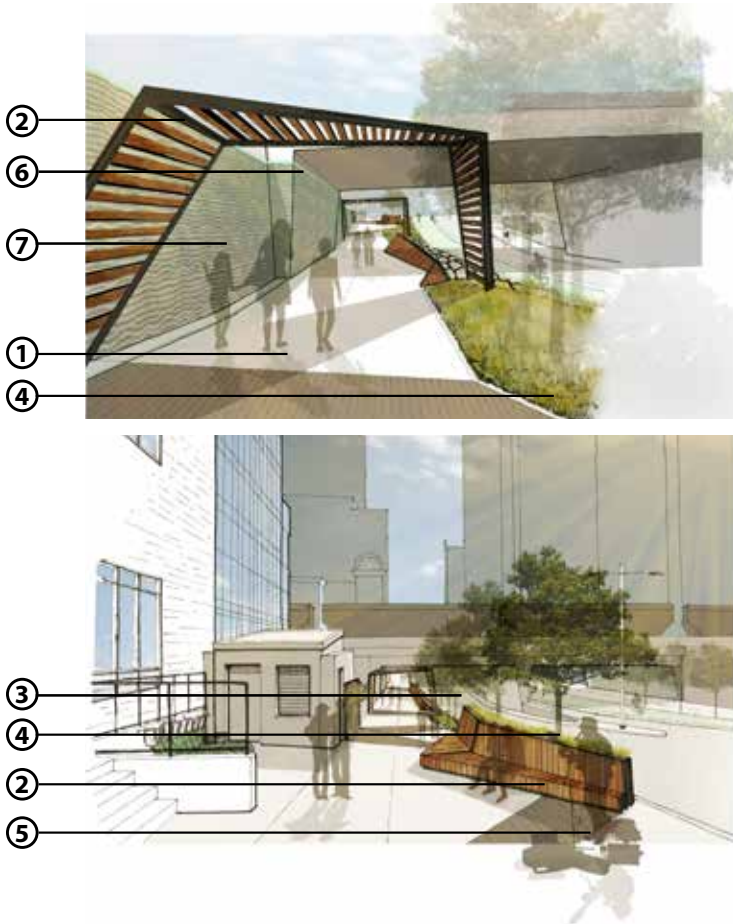

- ① **Pedestrian Safety and Comfort** M+F S+S
 - Wide sidewalks to remain
 - Wider crosswalks
 - Compressed space to discourage lingering at underpass
 - Guardrails and vegetation to separate pedestrians and vehicles
- ② **Architectural Elements to Add Park-Like Feel** S+S D+A
 - Overhead canopies
 - Leaning rails / protective edges
 - Guardrails
 - Low walls
- ③ **Narrowed Vehicular Lanes** M+F
 - Additional space for pedestrians
 - Additional space for plant materials
- ④ **Planting** M+F D+A
 - Site-specific trees, grasses and groundcovers provide windbreak and softer aesthetic
 - Park-like environment
- ⑤ **Improved Corner Conditions** S+S D+A
 - Designated areas for gathering and busking
 - Better interface with adjacent properties
- ⑥ **Lighting** M+F S+S
 - Enhanced pedestrian lighting at underpass for year-round use, day + night
 - Accent lighting throughout
- ⑦ **Public Art** M+F D+A
 - Art integrated with design

1.8 Concept Perspective (revised design)



Work in progress — what remains from the previous concept?

- Address unsightly and deteriorated elements
- Keep the linear park feel w/ trees and vegetation
- Integrate art + design into a seamless pedestrian experience

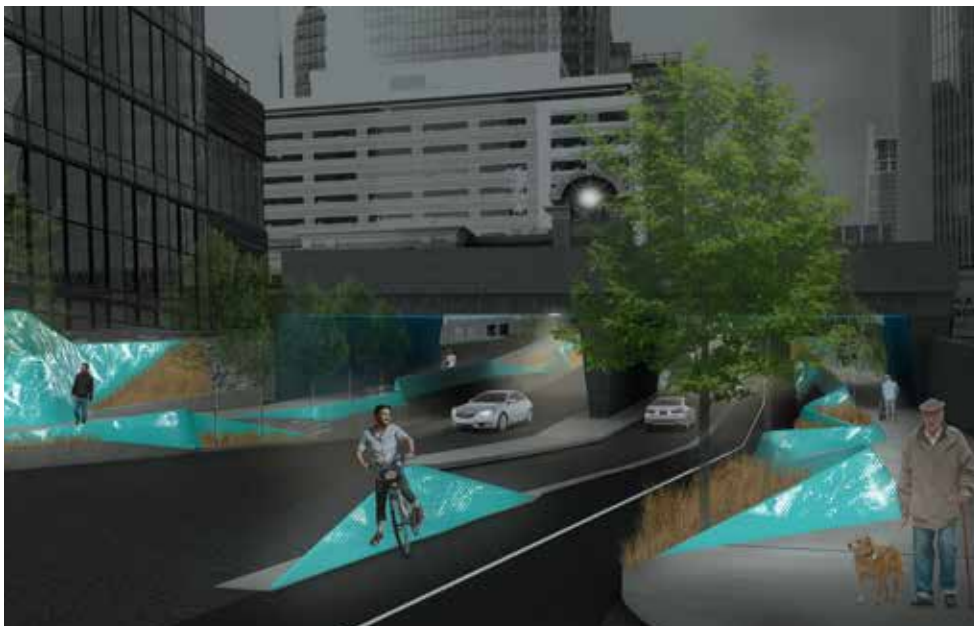

Work in progress — what's changing?

- Remove overhead wood canopies
- Remove public seating
- More pedestrian lighting
- Improved looks of Water Resources pump station building
- Refine design to improve ease of operations and maintenance