

North Calgary Regional Transportation Study

Kara Wolfe, P. Eng.
Manager, Network Planning

Intergovernmental Affairs Committee

May 16, 2019



Presentation Outline

- I. Study Background
- II. Study Process
- III. Evaluation Framework
- IV. Growth Assumptions
- V. Transit Network
- VI. Transportation Network Findings
- VII. Project Prioritization
- VIII. Next Steps





Study Background

- I. Request from Alberta Transportation Deputy Minister to Calgary, RVC and Airdrie
- II. Cochrane and Chestermere – group expanded
- III. North Calgary Region Committee (NCRC) – Five municipalities and Alberta Transportation
- IV. Technical work and facilitation of NCRC collaboration by ISL
- V. Project milestones and key decisions - consensus of the NCRC
- VI. CMRB participated in meetings

Study Area

NCRTS Study Area
(this study)

CMRB Boundary

S&ECRTS Study Area
(underway now)

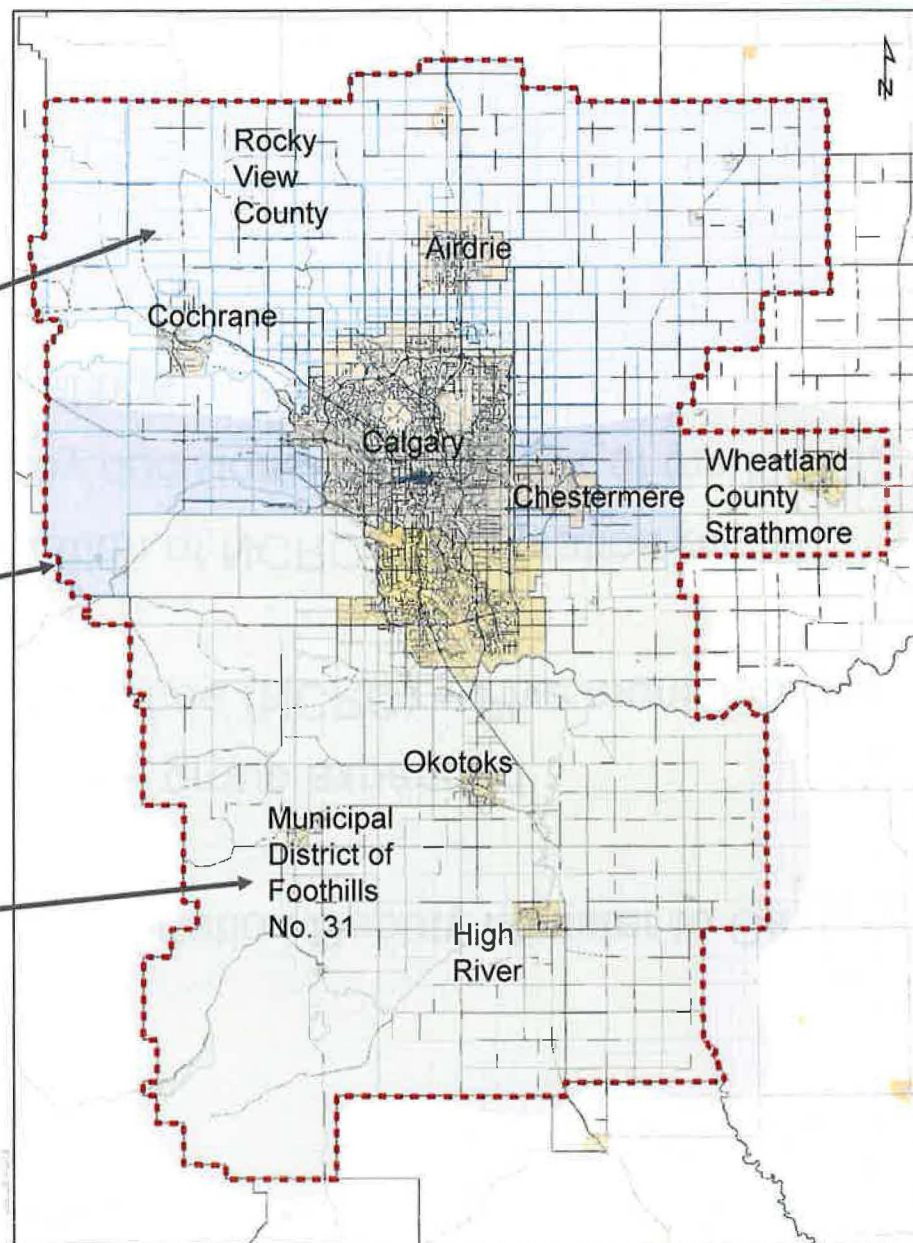



Study Process

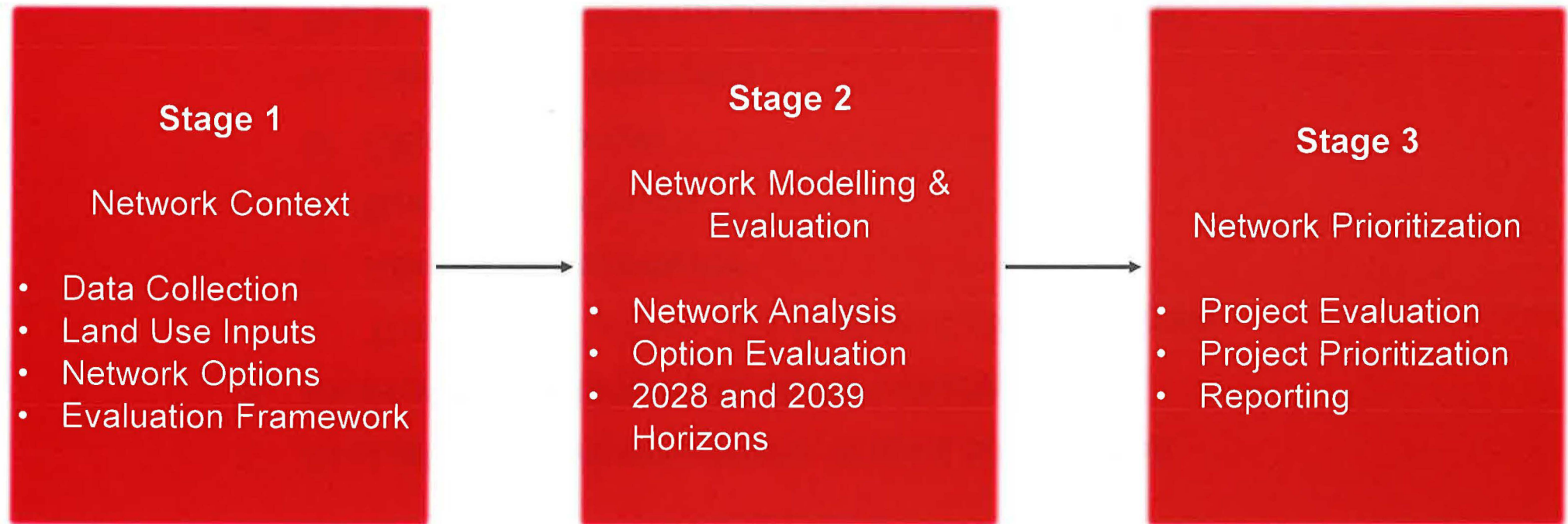

Evaluation Framework

- I. Evaluation of network options, project prioritization
- II. Referenced existing frameworks including:
 - i. The City of Calgary TIIP Multiple Criteria Analysis
 - ii. Alberta Transportation
 - iii. Rocky View County
 - iv. City of Edmonton
 - v. International examples
- III. Study-specific framework developed with the NCRC
- IV. “Multiple Account Evaluation” (MAE) model



Evaluation Framework

Category / Weighting	Criterion
Regional Growth / Economy 30%	Supports Priority Growth Areas
	Supports Multiple Municipal Partners
	Supports Investment / Expansion
	Supports Goods Movement
	Supports Employment Areas
Performance / Efficiency 30%	VkmT (Vehicle Kilometers Traveled)
	Capacity Improvement
	Safety Improvement
	Travel Time Savings
User Service / Connectivity / Choice 25%	Network Connectivity
	Connecting Multiple Communities
	Supports Primary / Regional Transit
Environmental 10%	GHG Emissions
	Land Preservation
	Impact on Environmental Features
Financial 5%	Benefit / Cost Ratio
	Capital Cost
	Use of Existing Infrastructure

Growth Assumptions

North Calgary Region*	Population	Jobs
2015 (Baseline)	1.00 Million	0.61 Million
2028 (10-Year)	1.36 Million	0.88 Million
2039 (20-Year)	1.65 Million	1.08 Million
Overall Growth	+65%	+75%

* North Calgary Region only includes area ~north of Glenmore Trail

Transportation Network

- I. Candidate projects
- II. Three categories:
 - i. Corridor projects 98 Projects
 - ii. Interchange projects 40 Projects
 - iii. Transit projects 23 Projects
 - 161 Projects
- III. CTP, Investing in Mobility, Route Ahead and ASPs
- IV. Skeletal / penetrator corridors
- V. Major goods movement / intermodal corridors
- VI. Analysis and evaluation to classify all projects

Transportation Network

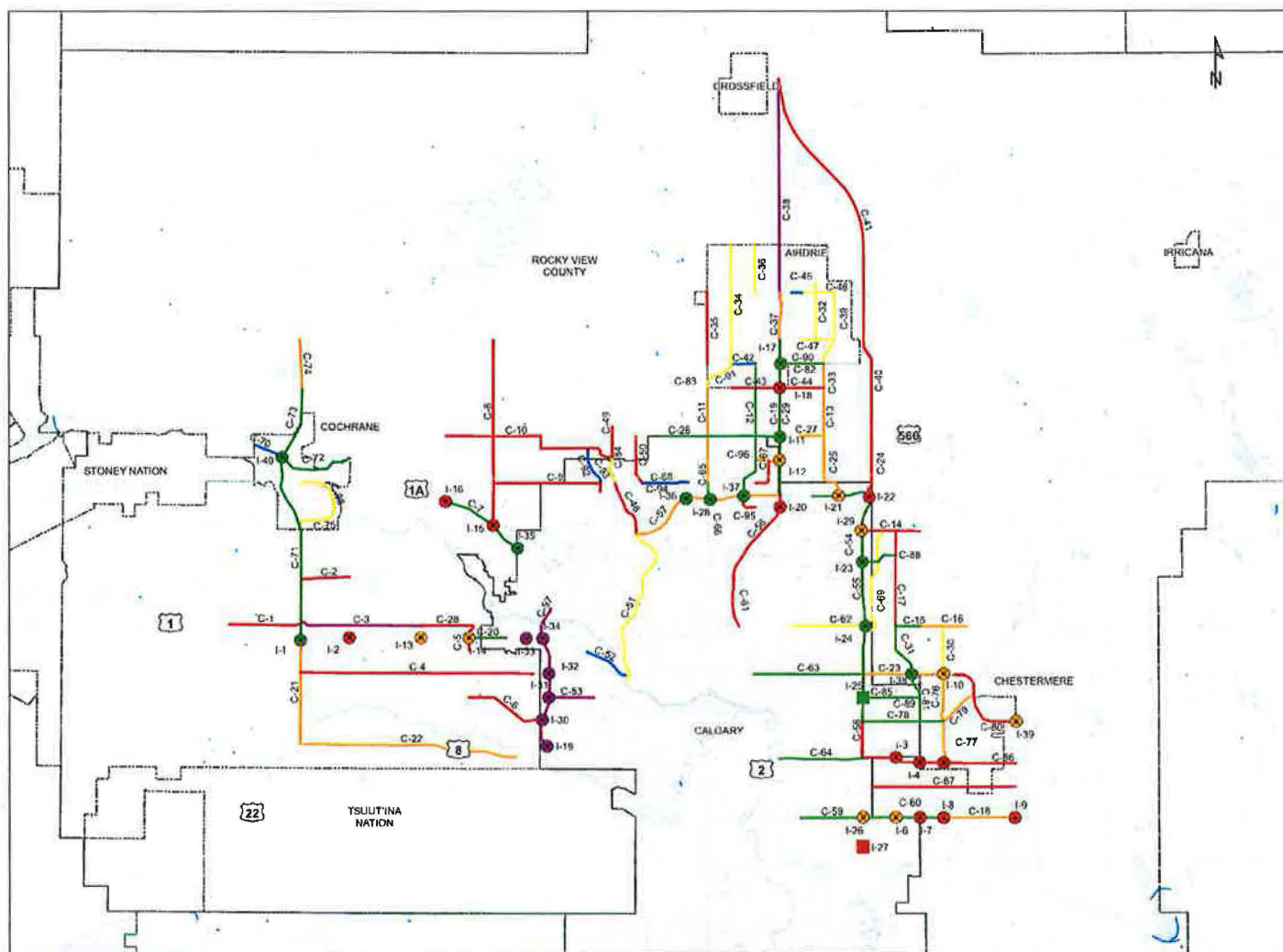

Category

- Beyond 2039
- 2039 Regional
- 2039 Non-Regional
- 2028 Regional
- 2028 Non-Regional
- Underway Now

Transportation Network

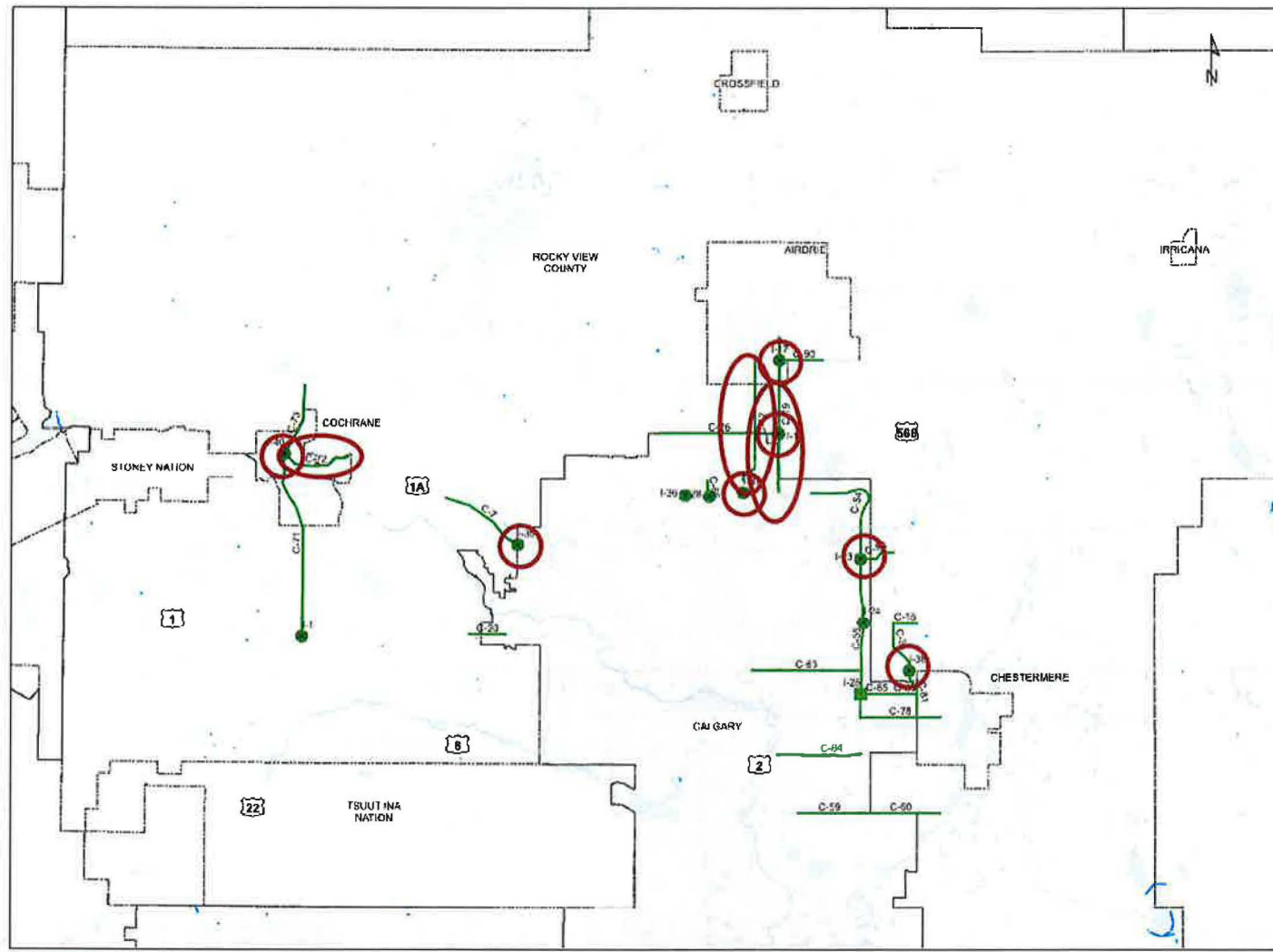

Category

- Beyond 2039
- 2039 Regional
- 2039 Non-Regional
- 2028 Regional
- 2028 Non-Regional
- Underway Now



Transit Network

- I. Primary transit services in the regional context
- II. The City of Calgary's Route Ahead plan
- III. Classification / priorities considered separately from corridor and interchange projects
- IV. Being reviewed and developed further by CMRB and The City of Calgary

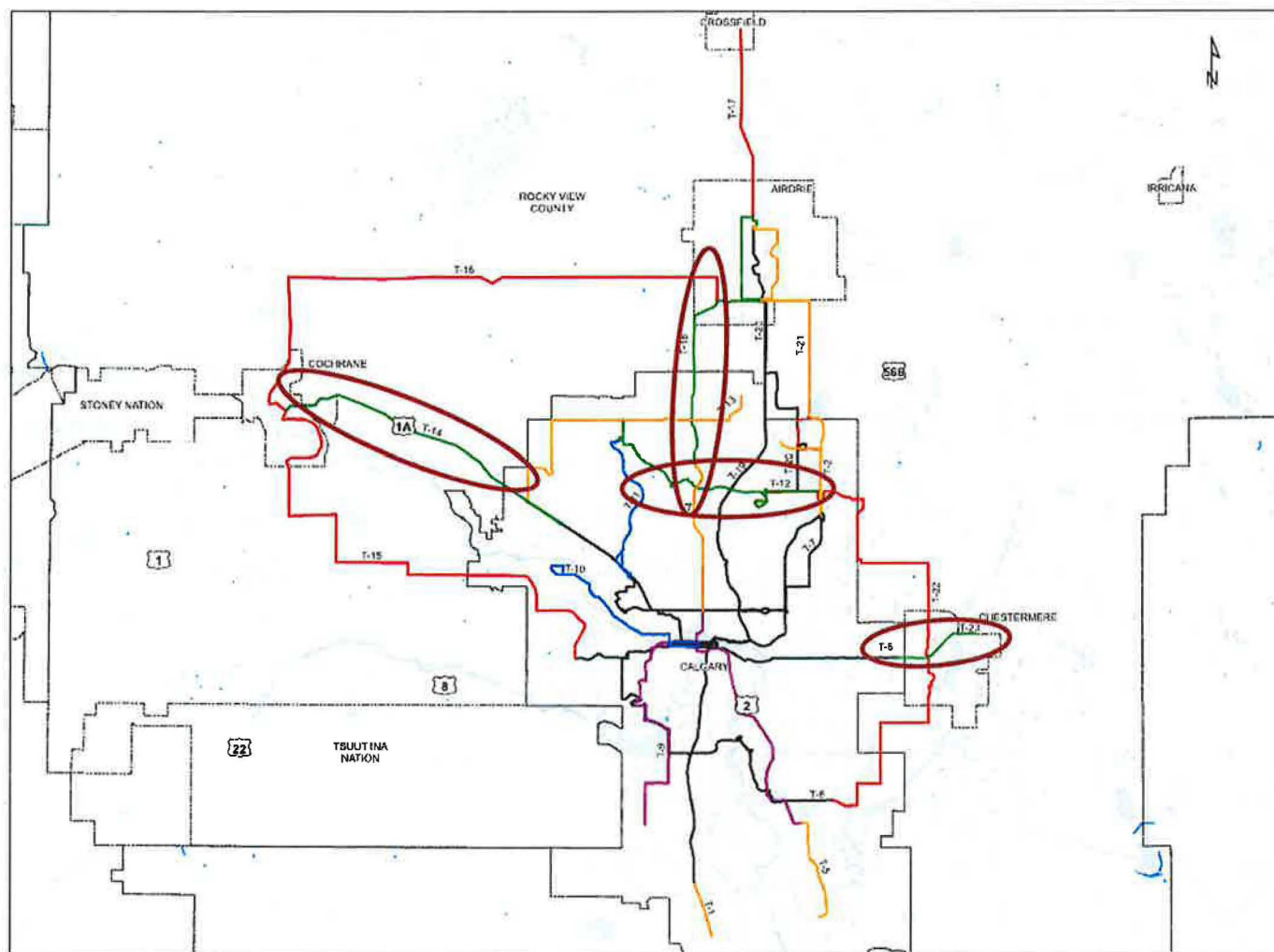

-  Beyond 2039
-  2039 Regional
-  2039 Non-Regional
-  2028 Regional
-  2028 Non-Regional
-  Underway Now



Project Prioritization

- I. Quantitative criteria
- II. Qualitative criteria
- III. 2028 Regional Projects (within 10-year horizon)
- IV. 2039 Regional Projects (20+ years)
- V. Expected that prioritization scoring / ranking could be updated at regular intervals in future



Project Prioritization

Ranking	Project	Location	Score (/100)
1	11 Street / Range Rd 11 / 8 Street (144 Ave NE to 40 Avenue) – 4 lanes	Calgary / Balzac / Airdrie	84.00
2	40 Avenue / QEII Interchange	Airdrie	68.17
3	Highway 1A (Highway 22 to Gleneagles Dr) – 4 lanes	Cochrane	64.49
4	QEII (Stoney Trail to Yankee Valley Blvd) – 8 lanes	Calgary / Balzac / Airdrie	63.33
5	Stoney Trail / 11 Street Interchange	Calgary	61.33
6	Crowchild Trail / 12 Mile Coulee Rd Interchange	Calgary / Bearspaw	60.49
7	Stoney Trail / Airport Trail Interchange	Calgary / RVC	59.83
8	Highway 566 / QEII Interchange	Balzac	59.17
9	Highway 1 / Garden Rd Interchange	Calgary / RVC / Chestermere	59.00
10	Highway 1A / Highway 22 Interchange	Cochrane	57.50

Next Steps

- I. Study completed December 2018 - final reporting April 2019
- II. NCRC members currently sharing with their Councils for information
- III. NCRC to share study results with CMRB
- IV. CMRB has initiated the South & East Calgary Regional Transportation Study (S&ECRTS)
- V. Both studies intended to be integrated and used as a baseline and input into the CMRB Regional Growth Plan



Recommendation

That the Intergovernmental Affairs Committee:

Receive the North Calgary Regional Transportation Study for information

Questions?

