

MetropolitanPlanningCouncil

Stormwater and City Building



Josh Ellis
Vice President

metroplanning.org @metroplanners

Agenda

- Chicago region's stormwater and river system
- A tale of two floods
- Gray and green infrastructure
 - Not gray vs. green infrastructure
- What it all adds up to
 - Great Rivers Chicago

CHICAGO REGION'S STORMWATER AND RIVER SYSTEM

Metropolitan Planning Council

metroplanning.org @metroplanners

Reversal of the Rivers



Combined and Separate Sewers

- Chicago = Mostly combined
- Suburbs = Mostly separated
- Combined
 - Overflows to rivers
 - Backups
 - Deep Tunnel System
- Separated
 - Infiltration and Inflow

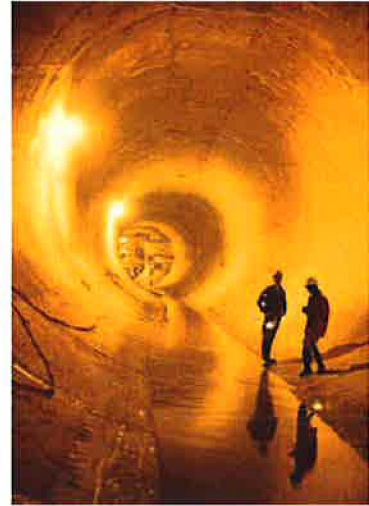

MetropolitanPlanningCouncil

metroplanning.org @metroplanners

A Region of Riverfronts

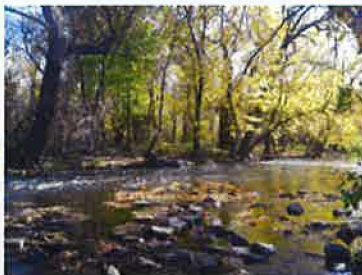

MetropolitanPlanningCouncil

metroplanning.org @metroplanners

A TALE OF TWO FLOODS

Metropolitan Planning Council

metroplanning.org @metroplanners

Riverine Flooding

- Natural = Flat & Clay
- Developed = Flat & Asphalt



Metropolitan Planning Council

metroplanning.org @metroplanners

Riverine Flooding

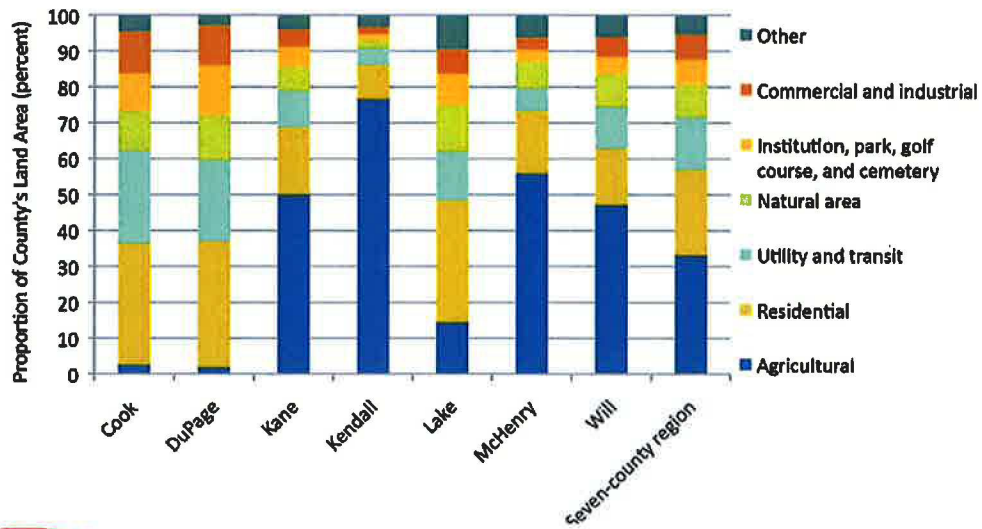

MetropolitanPlanningCouncil

metroplanning.org @metroplanners

“Urban Flooding”



MetropolitanPlanningCouncil

metroplanning.org @metroplanners

“Urban flooding”

- No relationship between flooding and “floodplain”
- Avg. claim of \$4,272
 - But many homes are not insured

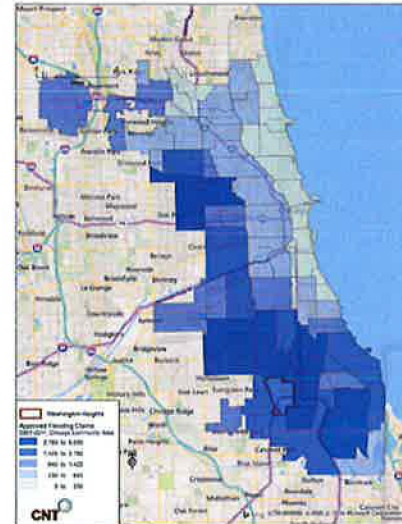

MetropolitanPlanningCouncil

metroplanning.org @metroplanners

GRAY AND GREEN INFRASTRUCTURE

MetropolitanPlanningCouncil

metroplanning.org @metroplanners

Gray and Green in Chicago

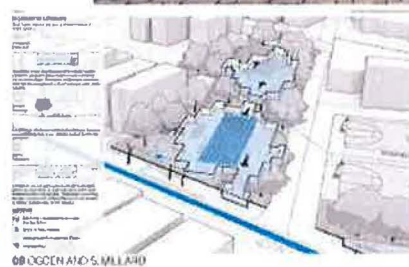

MetropolitanPlanningCouncil

metroplanning.org @metroplanners

Leveraging Private Real Estate Development

- Stormwater ordinances compel green and gray infrastructure



MetropolitanPlanningCouncil

metroplanning.org @metroplanners

The Logic of Trading

- But not all real estate markets at the same
- Neither are sites, sewersheds or watersheds
- Stormwater credit trading can provide:
 - Flexibility
 - Value creation for marginal land

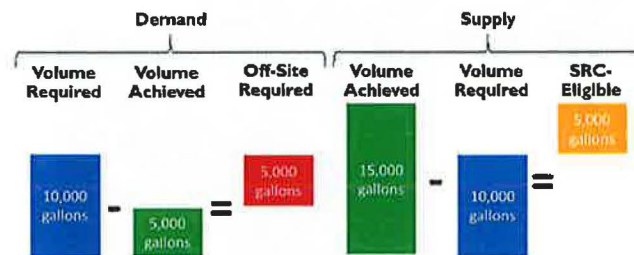

MetropolitanPlanningCouncil

metroplanning.org @metroplanners

Infrastructure is Infrastructure

- Funding long-term maintenance vs. volunteers



MetropolitanPlanningCouncil

metroplanning.org @metroplanners

WHAT IT ALL ADDS UP TO

MetropolitanPlanningCouncil

metroplanning.org @metroplanners

Rethinking Our Rivers

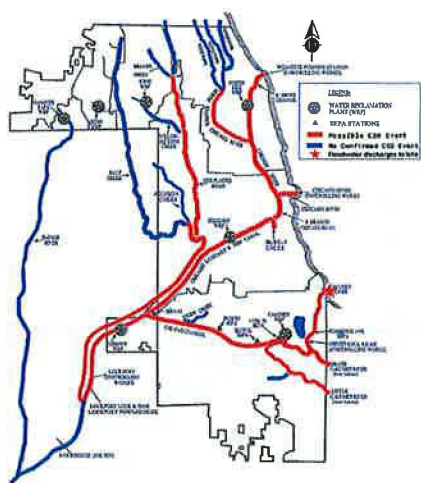

MetropolitanPlanningCouncil

metroplanning.org @metroplanners

Great Rivers Chicago

- A comprehensive vision for Chicago's three rivers
 - Inviting
 - Productive
 - Living



MetropolitanPlanningCouncil

metroplanning.org @metroplanners

Great Rivers Chicago



MetropolitanPlanningCouncil

metroplanning.org @metroplanners

Great Rivers Chicago

- Putting the Our in *Our Great Rivers*



MetropolitanPlanningCouncil



metroplanning.org @metroplanners

MetropolitanPlanningCouncil

THANK YOU

Josh Ellis
Vice President
jellis@metroplanning.org

metroplanning.org @metroplanners