

Community Association Responses

2025 October 1

The storage Facility proposes high lumen lighting, contributing to the light pollution from the Trinity Hills development that is already in existence. Given these properties sit at an elevation much higher than Bowness, a majority of residents who live just below the Trinity Hills area will be subject to this light pollution if the DP do not include the following:

- lower lumen lighting fixtures for facade lighting and mural lighting.
- sign lighting that has a lumen output adjustment based on ambient light combined with lower lumen output selections.
- These are options available on nearly all lighting products via manufacturers at time of purchase.
- All sign lighting should be static. No moving or changing images changing the frequency or intensity of lumen output.
- When images change, colours or pixels change, this automatically changes the intensity of lumen output on the sign light creating a flashing effect.
- options for backlit sign lighting.
- options for backlit awning sign lighting.
- options for lighting placed on arms that cast light back towards the building signage vs those that cast light outwards or upwards towards residential buildings.

We like that the building has murals on it. Much nicer than additional advertising space or just a plain building.

We have attached the West Segment Mobility plan where a pedestrian bridge to Trinity Hills was proposed from Bowness. We see the green spaces on the north and west side of the development as potential tie in locations for a pedestrian bridge or other types of walking infrastructure for Bowness and Trinity Hills.

Calgary **West Segment - Long-Term Concept Option 2** Provides six lanes on 16 Avenue N.W.

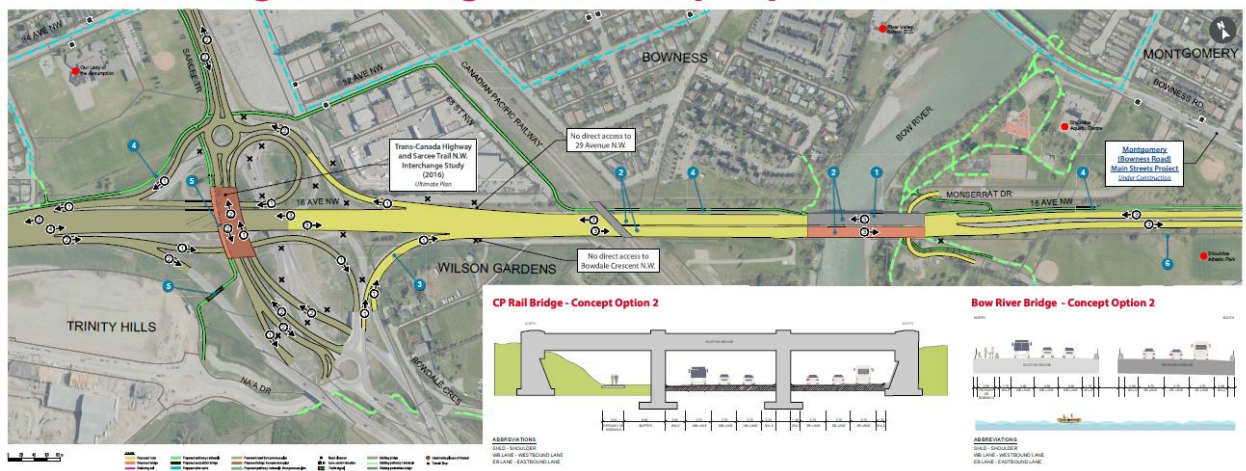

- Location Map**
- Benefits**
- Retains existing CP Rail bridge
 - Retains existing Bow River bridge and pathway connection on north side
 - Constructs new Bow River bridge for eastbound traffic
 - Repurposes existing bridges where possible to avoid cost of widening or replacing those bridges
 - Avoids impacts to critical water and sanitary sewer pipes along 16 Avenue N.W.
- Trade-Offs**
- Potential grading impacts to properties south of 16 Avenue N.W. and west of the CP Rail bridge.
 - Shifts 16 Avenue N.W. slightly to the south
 - Removes some trees to the south of 16 Avenue N.W. near the Bow River bridge
 - Removes direct access to 29 Avenue N.W. and Bowdale Crescent N.W.
- Design Features**
- Social and Healthy Lifestyle**
- 1 Widen existing north pathway over the Bow River bridge
- Mobility and Functionality**
- 2 Provides additional core lane in each direction for six core lanes of travel along 16 Avenue N.W.
 - 3 Makes merge from northbound Sarcee Trail to eastbound 16 Avenue N.W. longer to improve safety
- Character and Identity**
- 4 Connects Shouldice Park, Bowness and Montgomery with continuous pathway north of 16 Avenue N.W.
 - 5 Connects Trinity Hills, Wilson Gardens, and Bowness with continuous pathway over 16 Avenue N.W. at Sarcee Trail
 - 6 Creates a visual transition to Montgomery in the gateway zone with trees, street furniture, banners, displays or other elements

2025 December 3

The linear lights above the bison mural (as shown on drawing A3.5) should be dimmable according to ambient light to reduce light pollution the darker it gets.

Previous comments submitted by our committee seem to have been taken into account given the updated lighting schedule in this DP.