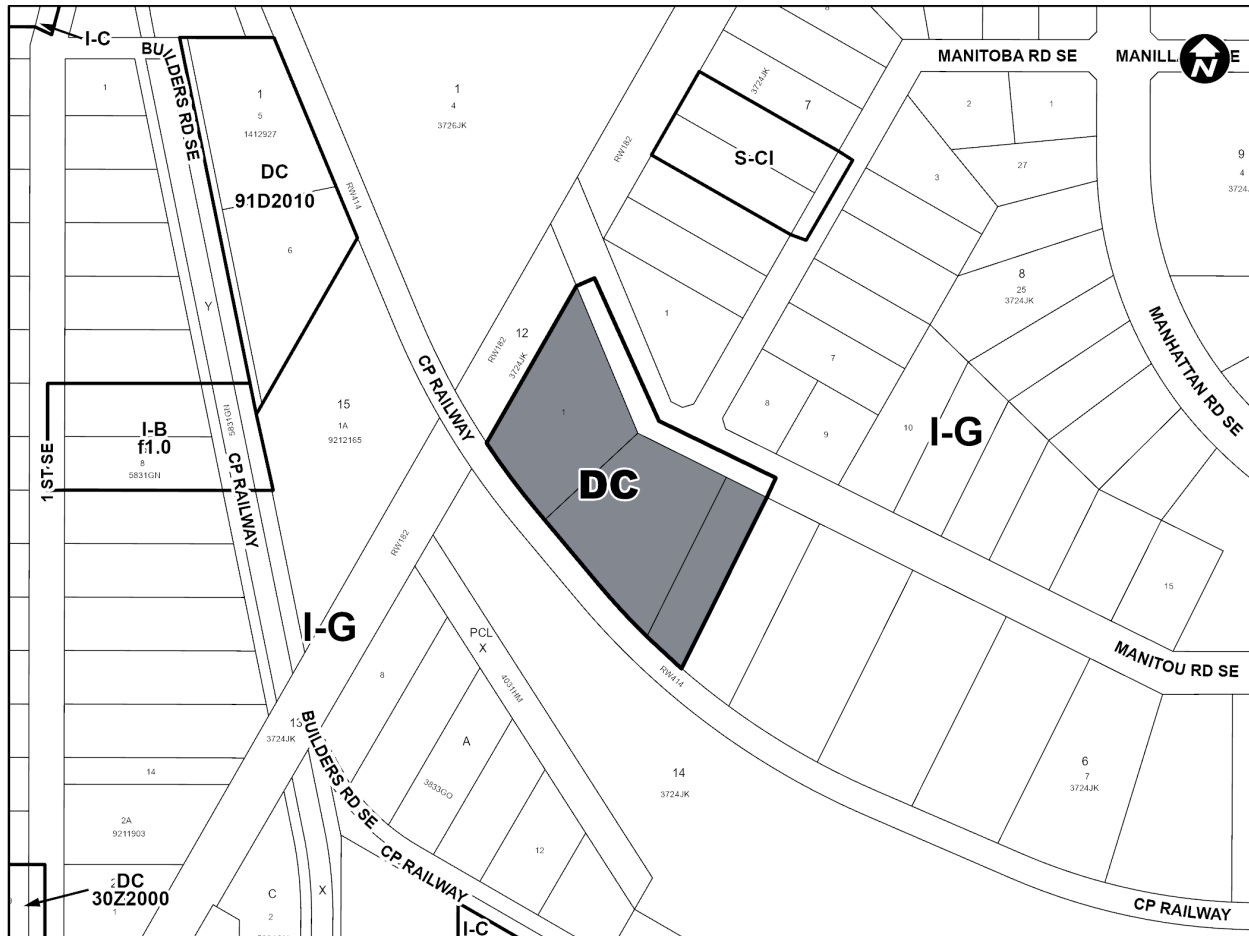

1. The Land Use Bylaw, being Bylaw 1P2007 of the City of Calgary, is hereby amended by deleting that portion of the Land Use District Map shown as shaded on Schedule “A” to this Bylaw and replacing it with that portion of the Land Use District Map shown as shaded on Schedule “B” to this Bylaw, including any land use designation, or specific land uses and development guidelines contained in the said Schedule “B”.

The map displays a residential neighborhood with several streets and railway lines. Key features include:

- Streets:** 1st St SE, Builders Rd SE, CP Railway, Manitoba Rd SE, and Manitou Rd SE.
- Lot Numbers and Identifiers:**
 - DC 91D2010 (Lot 6, 1412927)
 - I-B f1.0 (Lot 8, 5831GH)
 - DC 30Z2000 (Lot 2, 9211903)
 - DC 91D2010 (Lot 15, 9212165)
 - DC 30Z2000 (Lot 1, 3726JK)
 - DC 91D2010 (Lot 12, 3724JK)
 - DC 91D2010 (Lot 14, 3724JK)
 - DC 91D2010 (Lot 15, 3724JK)
 - DC 91D2010 (Lot 16, 3724JK)
 - DC 91D2010 (Lot 17, 3724JK)
 - DC 91D2010 (Lot 18, 3724JK)
 - DC 91D2010 (Lot 19, 3724JK)
 - DC 91D2010 (Lot 20, 3724JK)
 - DC 91D2010 (Lot 21, 3724JK)
 - DC 91D2010 (Lot 22, 3724JK)
 - DC 91D2010 (Lot 23, 3724JK)
 - DC 91D2010 (Lot 24, 3724JK)
 - DC 91D2010 (Lot 25, 3724JK)
 - DC 91D2010 (Lot 26, 3724JK)
 - DC 91D2010 (Lot 27, 3724JK)
 - DC 91D2010 (Lot 28, 3724JK)
 - DC 91D2010 (Lot 29, 3724JK)
 - DC 91D2010 (Lot 30, 3724JK)
 - DC 91D2010 (Lot 31, 3724JK)
 - DC 91D2010 (Lot 32, 3724JK)
 - DC 91D2010 (Lot 33, 3724JK)
 - DC 91D2010 (Lot 34, 3724JK)
 - DC 91D2010 (Lot 35, 3724JK)
 - DC 91D2010 (Lot 36, 3724JK)
 - DC 91D2010 (Lot 37, 3724JK)
 - DC 91D2010 (Lot 38, 3724JK)
 - DC 91D2010 (Lot 39, 3724JK)
 - DC 91D2010 (Lot 40, 3724JK)
 - DC 91D2010 (Lot 41, 3724JK)
 - DC 91D2010 (Lot 42, 3724JK)
 - DC 91D2010 (Lot 43, 3724JK)
 - DC 91D2010 (Lot 44, 3724JK)
 - DC 91D2010 (Lot 45, 3724JK)
 - DC 91D2010 (Lot 46, 3724JK)
 - DC 91D2010 (Lot 47, 3724JK)
 - DC 91D2010 (Lot 48, 3724JK)
 - DC 91D2010 (Lot 49, 3724JK)
 - DC 91D2010 (Lot 50, 3724JK)
- Other Labels:** I-C, I-B, I-G, S-CI, PCL X, 383300, 400160, 400164, 400168, 400172, 400176, 400180, 400184, 400188, 400192, 400196, 400200, 400204, 400208, 400212, 400216, 400220, 400224, 400228, 400232, 400236, 400240, 400244, 400248, 400252, 400256, 400260, 400264, 400268, 400272, 400276, 400280, 400284, 400288, 400292, 400296, 400300, 400304, 400308, 400312, 400316, 400320, 400324, 400328, 400332, 400336, 400340, 400344, 400348, 400352, 400356, 400360, 400364, 400368, 400372, 400376, 400380, 400384, 400388, 400392, 400396, 400400, 400404, 400408, 400412, 400416, 400420, 400424, 400428, 400432, 400436, 400440, 400444, 400448, 400452, 400456, 400460, 400464, 400468, 400472, 400476, 400480, 400484, 400488, 400492, 400496, 400500, 400504, 400508, 400512, 400516, 400520, 400524, 400528, 400532, 400536, 400540, 400544, 400548, 400552, 400556, 400560, 400564, 400568, 400572, 400576, 400580, 400584, 400588, 400592, 400596, 400600, 400604, 400608, 400612, 400616, 400620, 400624, 400628, 400632, 400636, 400640, 400644, 400648, 400652, 400656, 400660, 400664, 400668, 400672, 400676, 400680, 400684, 400688, 400692, 400696, 400700, 400704, 400708, 400712, 400716, 400720, 400724, 400728, 400732, 400736, 400740, 400744, 400748, 400752, 400756, 400760, 400764, 400768, 400772, 400776, 400780, 400784, 400788, 400792, 400796, 400800, 400804, 400808, 400812, 400816, 400820, 400824, 400828, 400832, 400836, 400840, 400844, 400848, 400852, 400856, 400860, 400864, 400868, 400872, 400876, 400880, 400884, 400888, 400892, 400896, 400900, 400904, 400908, 400912, 400916, 400920, 400924, 400928, 400932, 400936, 400940, 400944, 400948, 400952, 400956, 400960, 400964, 400968, 400972, 400976, 400980, 400984, 400988, 400992, 400996, 401000.

SCHEDULE B**DIRECT CONTROL DISTRICT****Purpose**

- 1 This Direct Control District Bylaw is intended to allow for the additional use of indoor recreation facility.

Compliance with Bylaw 1P2007

- 2 Unless otherwise specified, the rules and provisions of Parts 1, 2, 3 and 4 of Bylaw 1P2007 apply to this Direct Control District Bylaw.

Reference to Bylaw 1P2007

- 3 Within this Direct Control District Bylaw, a reference to a section of Bylaw 1P2007 is deemed to be a reference to the section as amended from time to time.

Permitted Uses

- 4 The ***permitted uses*** of the Industrial – General (I-G) District of Bylaw 1P2007 are the ***permitted uses*** in this Direct Control District.

Discretionary Uses

- 5** The ***discretionary uses*** of the Industrial – General (I-G) District of Bylaw 1P2007 are the ***discretionary uses*** in this Direct Control District with the addition of the following ***uses*** when they are located in a ***building*** existing at the time of approval of this Direct Control District Bylaw or additions to that ***building***:

(a) **Indoor Recreation Facility.**

Bylaw 1P2007 District Rules

- 6** Unless otherwise specified, the rules of the Industrial – General (I-G) District of Bylaw 1P2007 apply in this Direct Control District.

Relaxations

- 7** The ***Development Authority*** may relax the rules contained in Section 6 of this Direct Control District Bylaw in accordance with Sections 31 and 36 of Bylaw 1P2007.