

# Approved Outline Plan

Calgary Planning Commission is the Approving Authority for the Outline Plan. Attachment for Council's reference only.

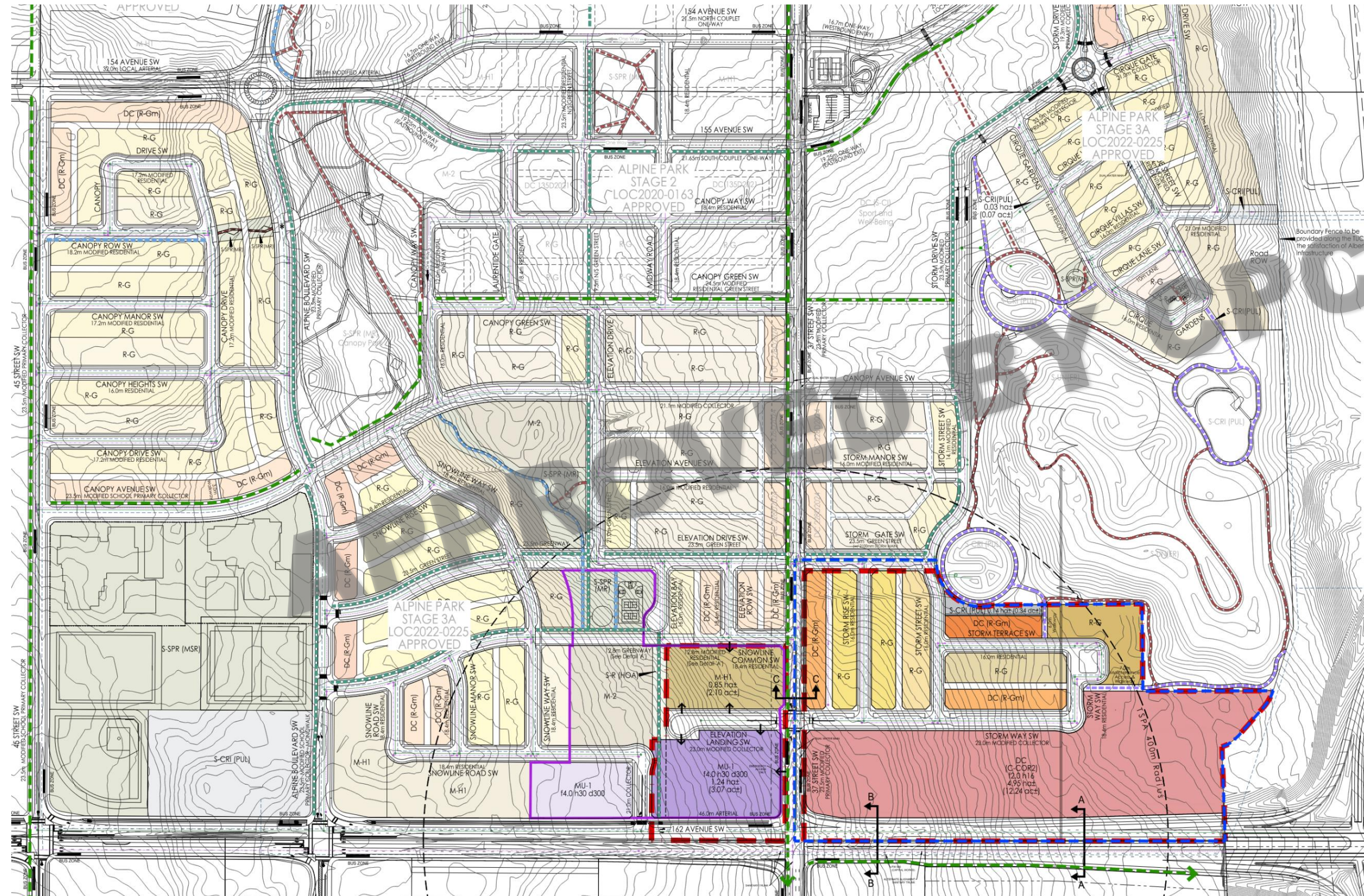

OUTLINE PLAN STATISTICS			
CROSS DEVELOPABLE AREA (CDA)	14.21 ha	35.11 ac	100.0%
<b>RESIDENTIAL</b>	<b>3.86 ha</b>	<b>9.56 ac</b>	<b>27.2%</b>
Low Density	3.01 ha	7.46 ac	21.2%
R-G - 25m Village Wide Loned	0.77 ha	1.90 ac	49 units
R-G - 20m Loned	0.43 ha	1.06 ac	148m
R-G - 20m Loned	0.42 ha	1.03 ac	130m
R-G - 20m Loned	0.56 ha	1.39 ac	123m
DC (R-Gm) - 21.5m	0.89 ha	1.47 ac	276m
DC (R-Gm) - 24.0m	0.25 ha	0.61 ac	103m
<b>MULTI-RESIDENTIAL</b>	<b>0.85 ha</b>	<b>2.10 ac</b>	<b>4.0%</b>
M-H1	0.85 ha	2.10 ac	178 units
<b>MIXED-USE</b>	<b>1.24 ha</b>	<b>3.07 ac</b>	<b>8.7%</b>
MU-1 14.0 h30 d300	1.24 ha	3.07 ac	280 units
<b>TOTAL UNITS</b>			<b>Anticipated: 579 units</b>
<b>DENSITY</b>			<b>Anticipated: 40.8 upha</b>
<b>COMMERCIAL</b>	<b>4.95 ha</b>	<b>12.24 ac</b>	<b>34.9%</b>
DC (C-COR2) 12.0 h14	4.95 ha	12.24 ac	192 units
<b>PUBLIC DEDICATION</b>	<b>4.14 ha</b>	<b>10.24 ac</b>	<b>29.2%</b>
S-CRI	0.14 ha	0.34 ac	58 units
Roads and lanes	4.01 ha	9.90 ac	28.2%

LAND USE STATISTICS	
S-FUD to R-G	3.42 ha 8.46 ac
S-FUD to DC (R-Gm)	1.53 ha 3.79 ac
S-FUD to DC (C-COR2)	4.79 ha 11.85 ac
S-FUD to S-CRI	0.19 ha 0.46 ac
<b>Total Redevelopment</b>	<b>11.93 ha 29.56 ac</b>

TSPA INTENSITY			
Land Use	Units	People	Jobs
R-G (3.3 ppu)	53	174	
DC (R-Gm) (23.9 ppu)	46	156	
M-H1 (1.7 ppu)	178	302	
MU-1 14.0 h30 d300	280	476	209
Commercial (1.47 ppu/ha)	280	476	209
Residential (1.7 ppu)	280	476	209
DC (C-COR2) (2.0 h14) (58 jobs/ha)			221
<b>Anticipated Intensity (12.55 upha)</b>	<b>122 ppi</b>	<b>410 jobs/ha</b>	

CAC INTENSITY			
Land Use	Units	People	Jobs
M-H1 (1.7 ppu)	178	302	
MU-1 14.0 h30 d300	280	476	209
Commercial (1.47 ppu/ha)	280	476	209
Residential (1.7 ppu)	280	476	209
<b>Anticipated Intensity (2.41 upha)</b>	<b>410 ppi</b>	<b>410 jobs/ha</b>	

**Legend**

- Outline Plan Boundary
- Land Use Redesignation Boundary
- CAC Boundary
- TSPA 400m Radius
- 3.0m Regional Pathway
- 3.0m Multi-Use Pathway
- 2.5m Local Pathway
- Local Pathway
- Maintenance Pathway
- Potential Access Locations
- Proposed Mid-Block Crossing
- Proposed Sanitary Sewer/Manhole
- Proposed Storm Sewer/Manhole
- Proposed Water Main
- Existing Sanitary Sewer/Manhole
- Existing Storm Sewer/Manhole
- Existing Water Main

- Notes**
- All walkways are intended to be 3.0m in width. Where these are required for underground utilities or overhead drainage, the appropriate clearances will be provided.
  - All lanes are 7m unless otherwise noted.
  - All lane curbs are to be 3m x3m.
  - All road curbs are to be 4.5m x4.5m.

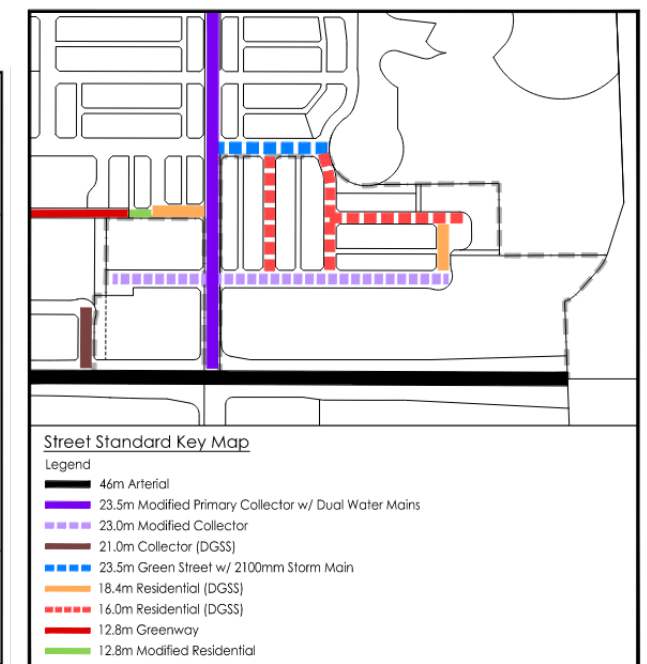
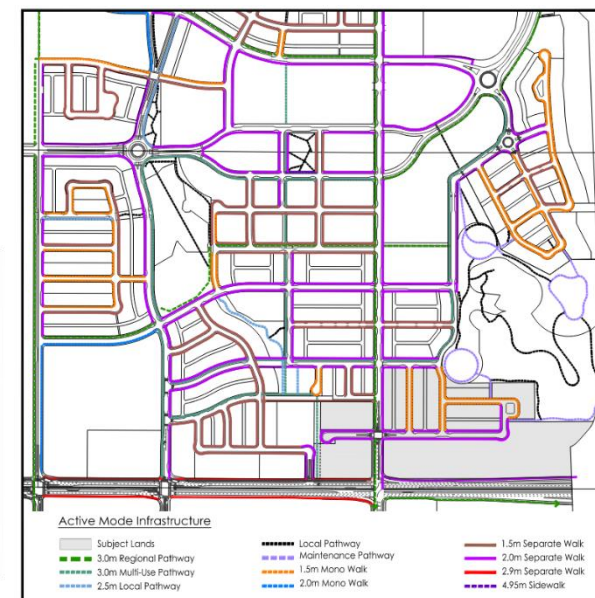
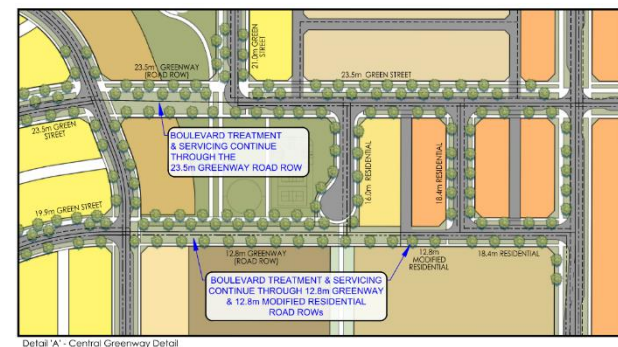
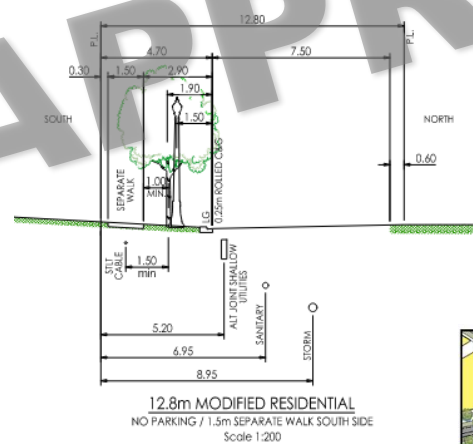
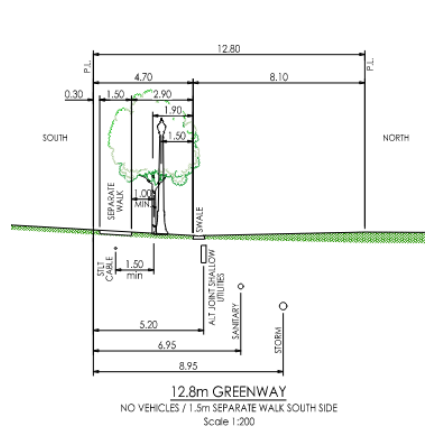
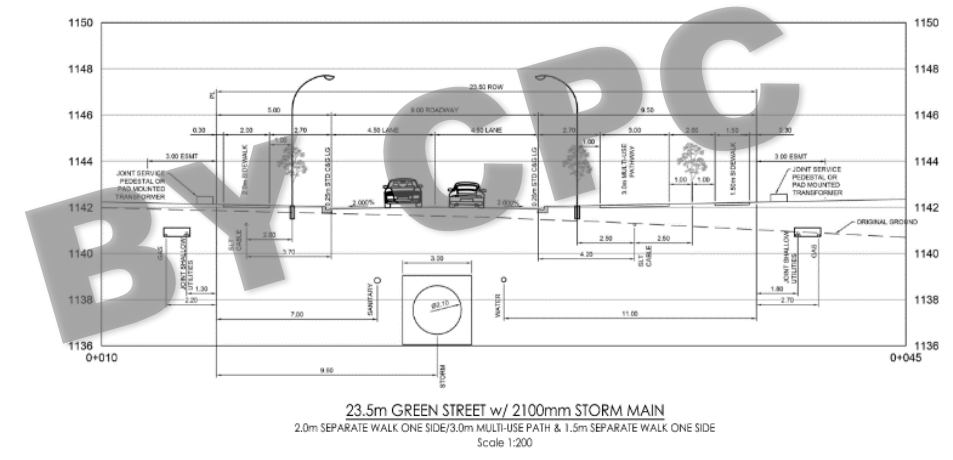
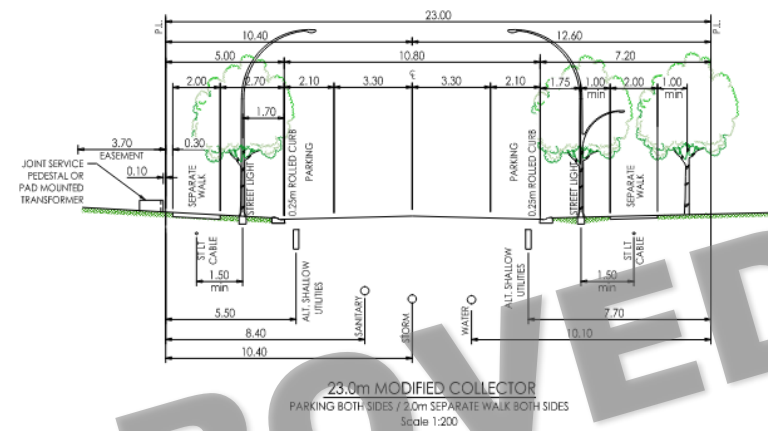
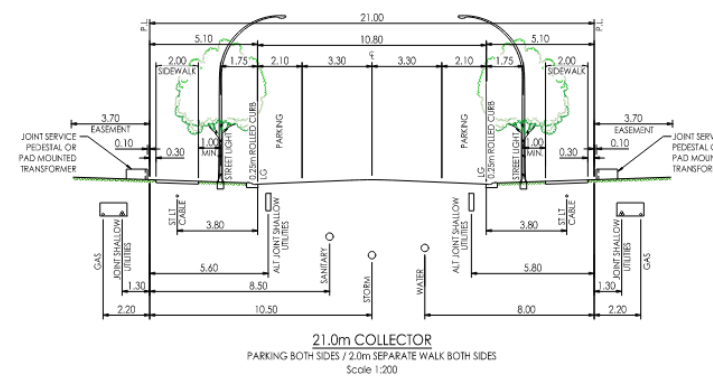
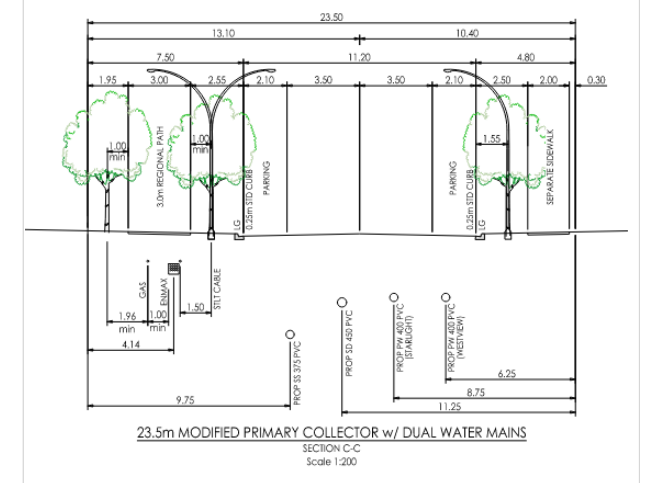
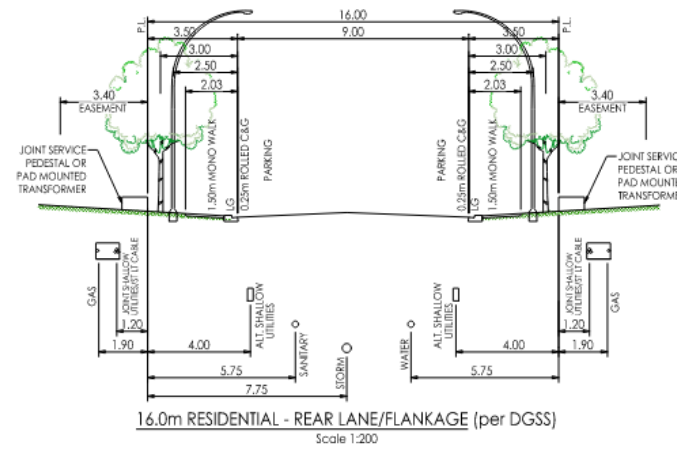
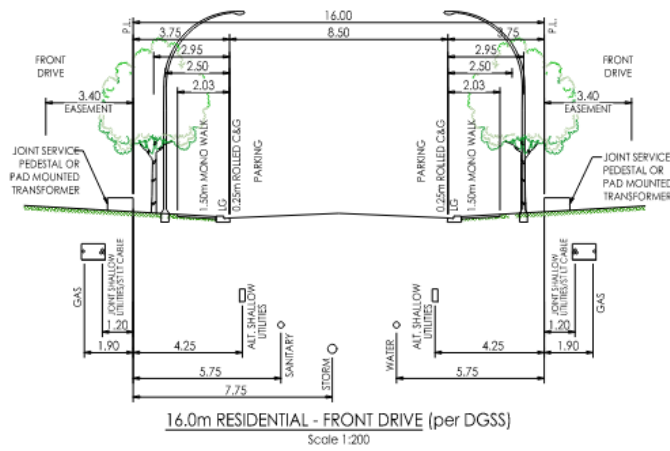
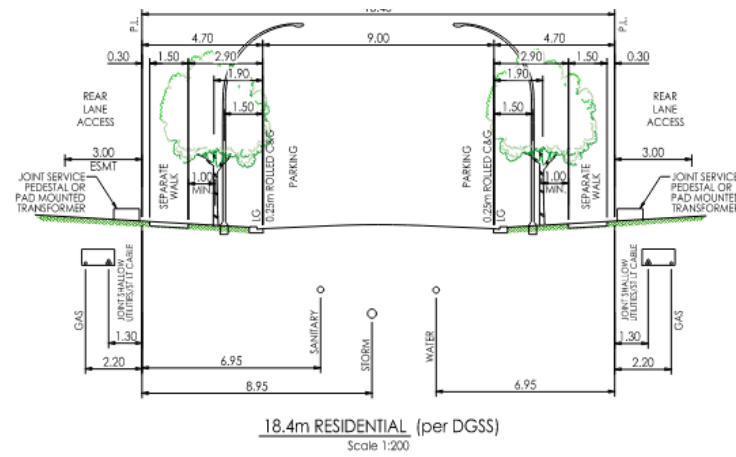

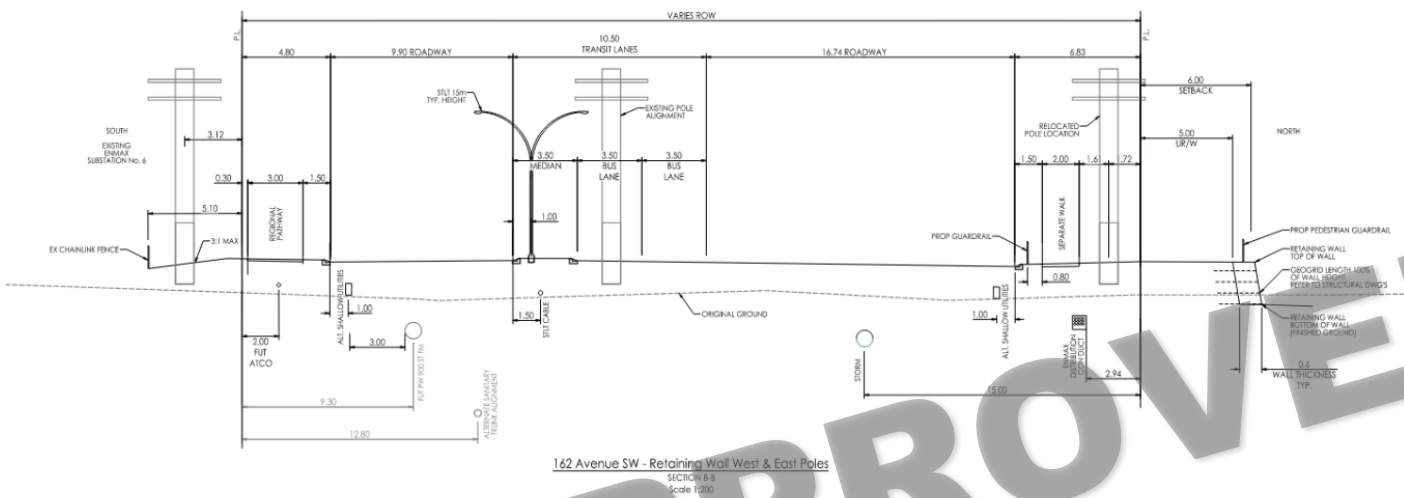
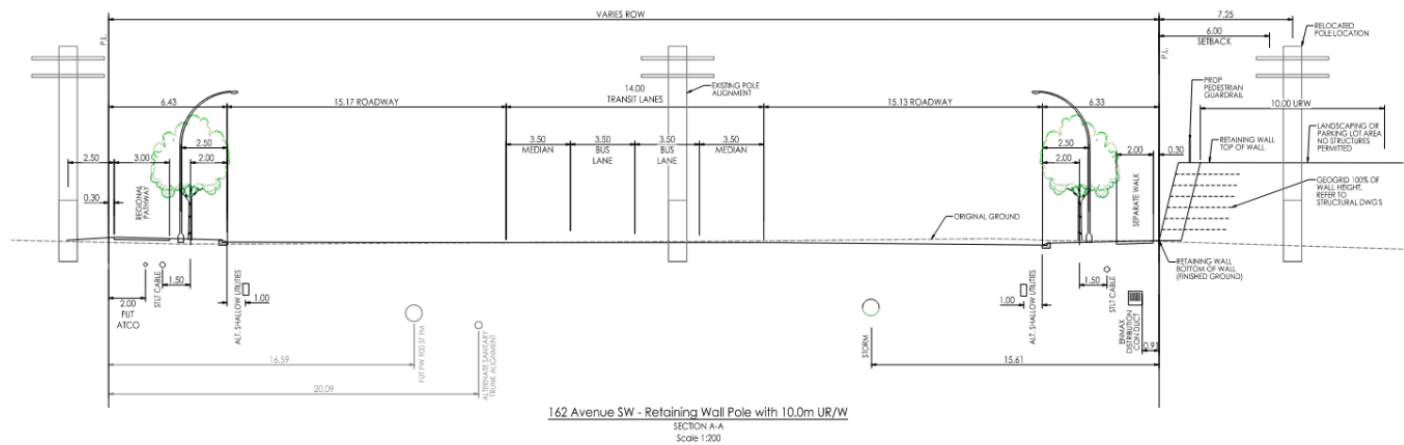

APPROVED BY CPC

