

Approved Outline Plan

Calgary Planning Commission is the Approving Authority for the Outline Plan. Attachment for Council's reference only.

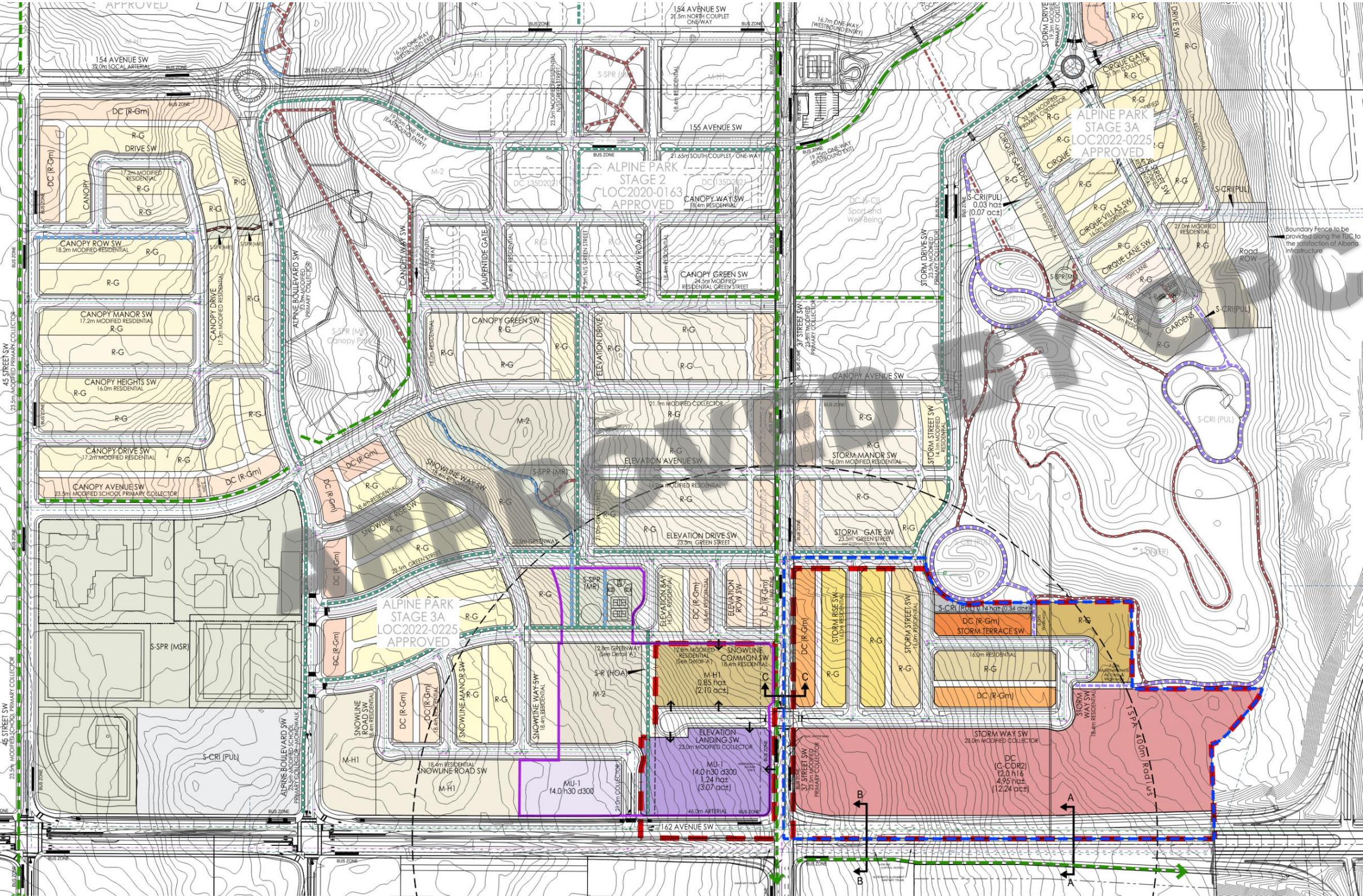

OUTLINE PLAN STATISTICS				
GROSS DEVELOPABLE AREA (GDA)	14.21 ha	35.11 ac	100.0%	
RESIDENTIAL	3.86 ha	9.56 ac	27.2%	
Low Density	3.01 ha	7.44 ac	21.2%	
R-G - 24m Vintage Wide Loned	0.77 ha	1.90 ac	297m	18 units
R-G - 30m Loned	0.43 ha	1.06 ac	148m	9 units
R-G - 32m Loned	0.42 ha	1.03 ac	130m	14 units
R-G - 32m Loned	0.56 ha	1.39 ac	123m	10 units
DC (R-Gm) - 21.5m	0.89 ha	1.47 ac	278m	50 units
DC (R-Gm) - 24.6m	0.25 ha	0.61 ac	163m	18 units
Total	1.07m			20 units
Multi-Residential	0.85 ha	2.10 ac		4.0%
M-H1	0.85 ha	2.10 ac	178 units	340 units
MIXED-USE	1.24 ha	3.07 ac		8.7%
MU-1 14.0 h30 d300	1.24 ha	3.07 ac	280 units	373 units
TOTAL UNITS			Anticipated	579 units
DENSITY	Anticipated:	579 units	Maximum:	952 units
	14.21 ha (35.11 ac)	+ 40.8 upha	14.21 ha (35.11 ac)	+ 43.5 upha
		+ 14.5 upha		+ 25.7 upha
COMMERCIAL	4.95 ha	12.24 ac		34.9%
DC (C-COR2) 12.0 h16	4.95 ha	12.24 ac		
PUBLIC DEDICATION	4.14 ha	10.24 ac		29.2%
S-CRI	0.14 ha	0.34 ac		
Roads and Lanes	4.01 ha	9.90 ac		28.2%

LAND USE STATISTICS		
S-FUD to R-G	3.42 ha	8.46 ac
S-FUD to DC (R-Gm)	1.53 ha	3.79 ac
S-FUD to DC (C-COR2)	4.70 ha	11.65 ac
S-FUD to S-CRI	0.19 ha	0.46 ac
Total Redevelopment	11.84 ha	29.26 ac

TSPA INTENSITY			
Land Use	Units	People	Jobs
R-G (3.3 ppu)	53	174	
DC (R-Gm) (2.3 ppu)	46	156	
M-H1 (11.7 ppu)	178	302	
MU-1 14.0 h30 d300			209
Commercial (1.4 p jobs/ha)	280	476	
Residential (1.7 ppu)			221
DC (C-COR2) 12.0 h16 (58 jobs/ha)			
Anticipated Intensity (12.5 ppu)	122 ppi	jobs/ha	

CAC INTENSITY			
Land Use	Units	People	Jobs
M-H1 (11.7 ppu)	178	302	
MU-1 14.0 h30 d300			209
Commercial (1.4 p jobs/ha)	280	476	
Residential (1.7 ppu)			221
Anticipated Intensity (2.41 ppu)	410 ppi	jobs/ha	

- Legend
- Outline Plan Boundary
 - Land Use Redesignation Boundary
 - CAC Boundary
 - TSPA 400m Radius
 - 3.0m Regional Pathway
 - 3.0m Multi-Use Pathway
 - 2.5m Local Pathway
 - Local Pathway
 - Maintenance Pathway
 - Potential Access Locations
 - Proposed Mid-Block Crossing
 - Proposed Sanitary Sewer/Manhole
 - Proposed Storm Sewer/Manhole
 - Proposed Water Main
 - Existing Sanitary Sewer/Manhole
 - Existing Storm Sewer/Manhole
 - Existing Water Main

- Notes
- All walkways are intended to be 3.0m in width. Where these are required for underground utilities or overland drainage, the appropriate easements will be provided.
 - All lanes are 7m unless otherwise noted.
 - All lane comercurts are to be 3m x3m.
 - All road comercurts are to be 4.5m x4.5m.

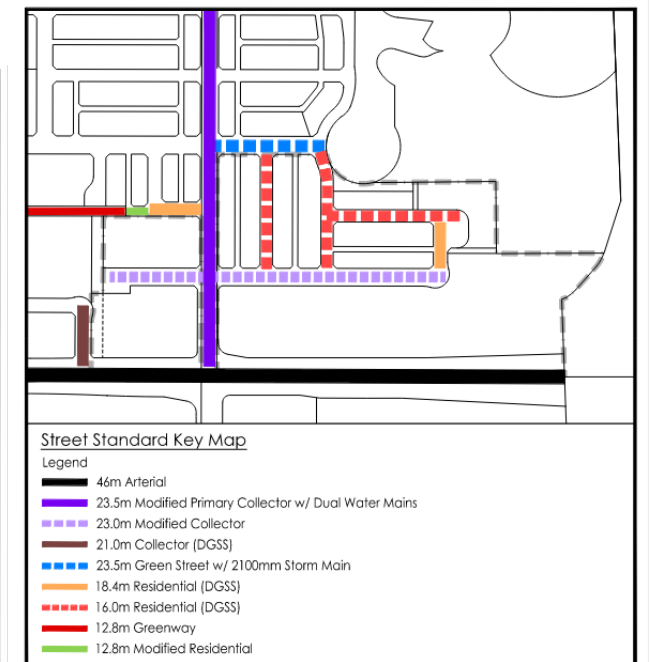
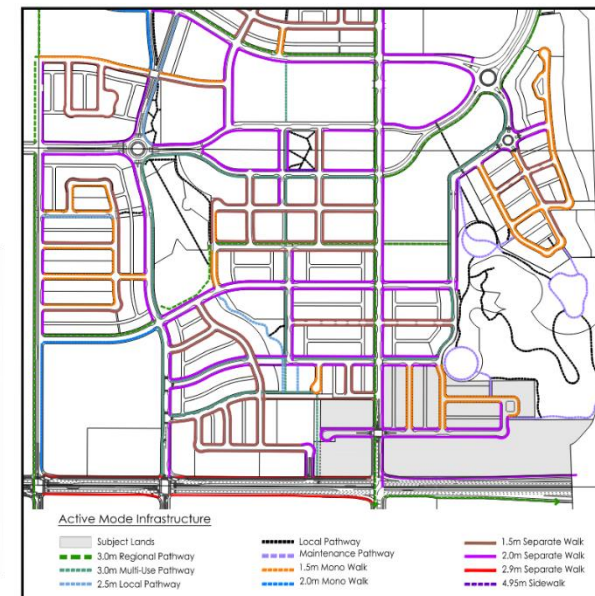
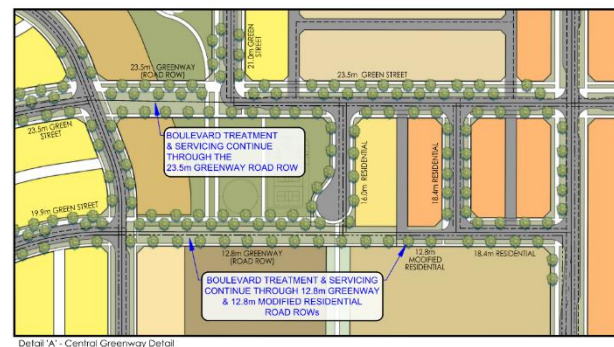
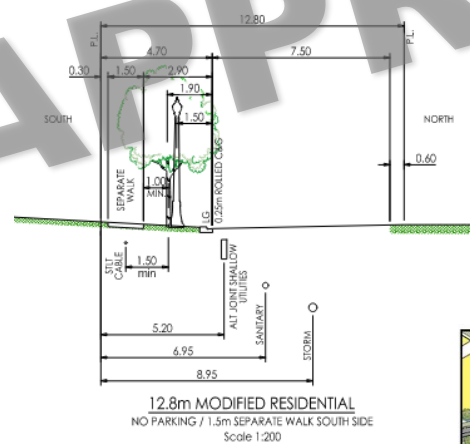
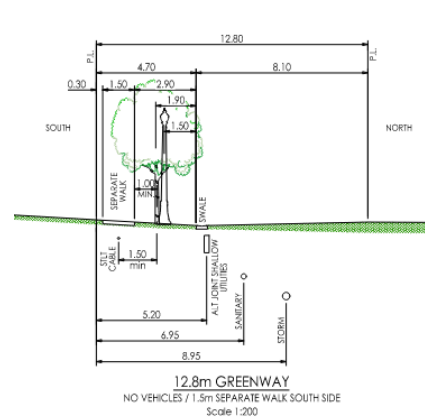
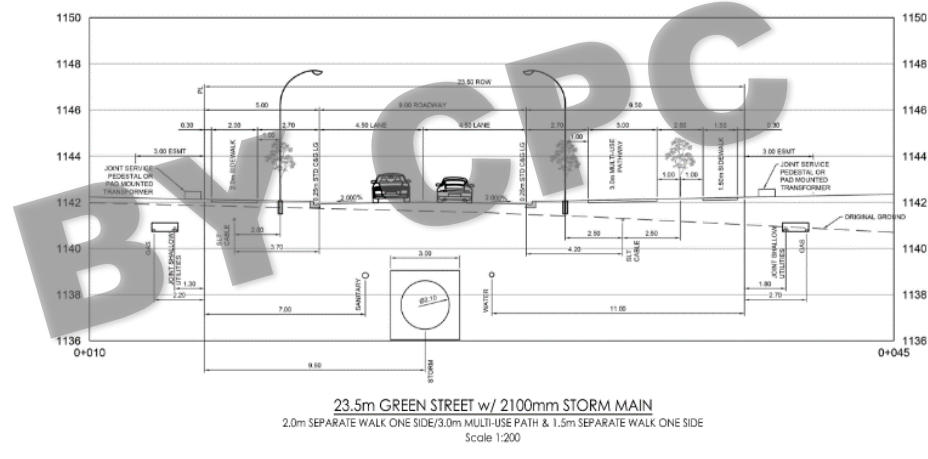
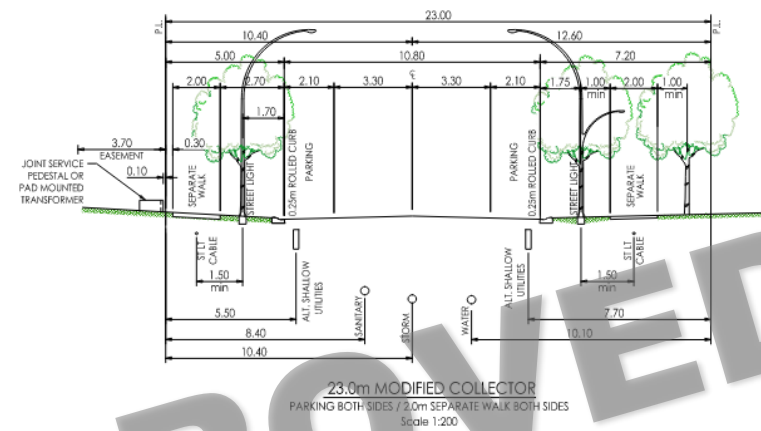
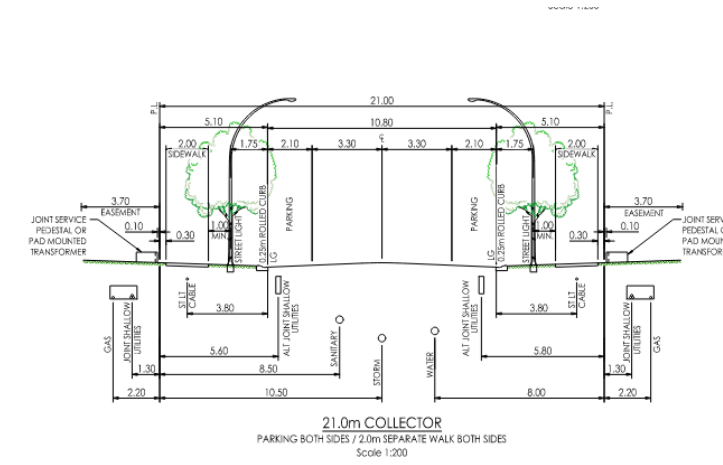
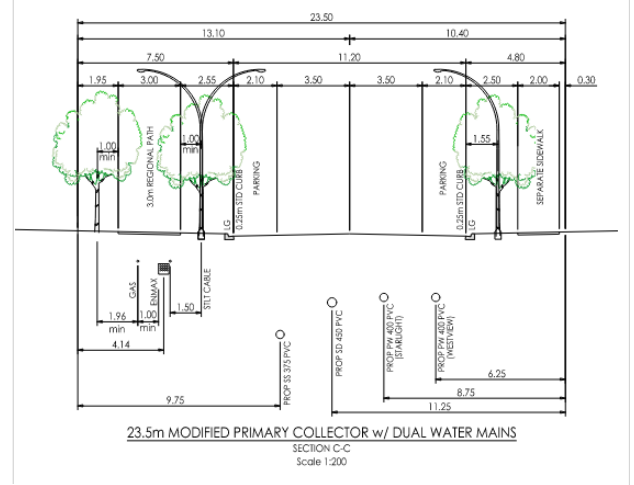
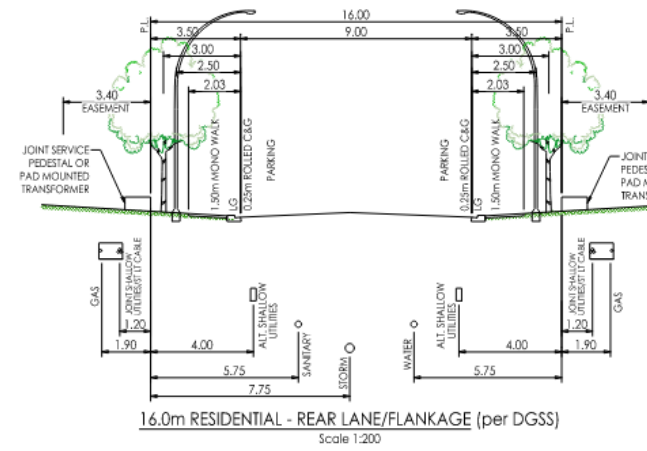
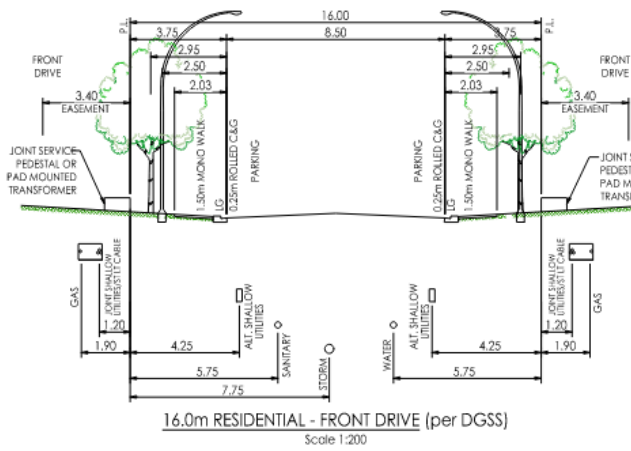
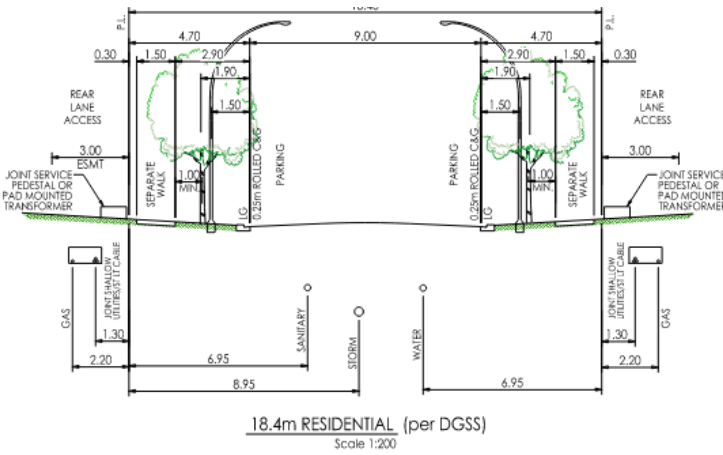

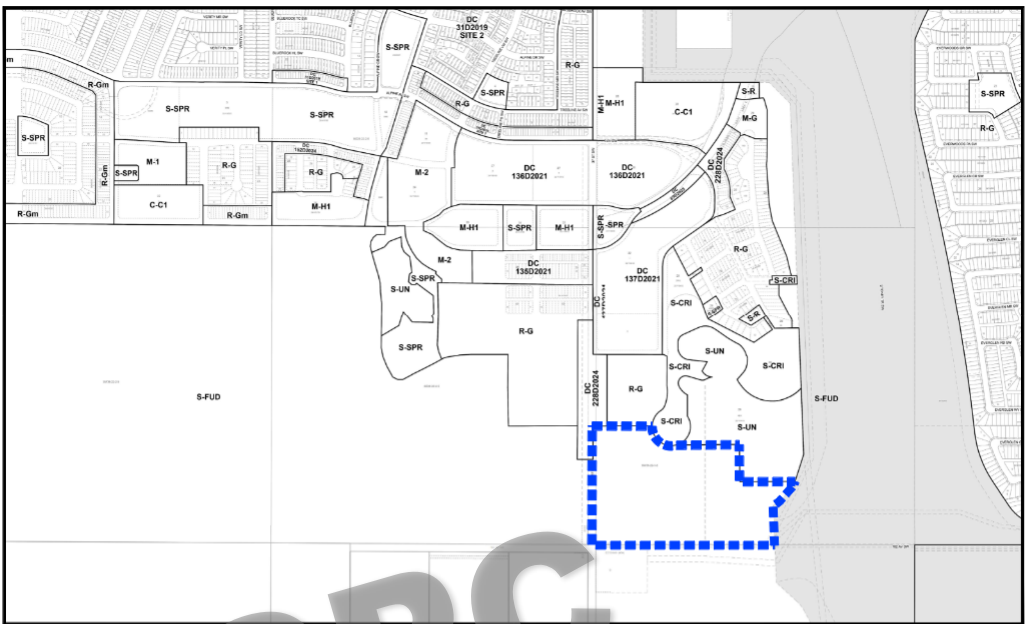
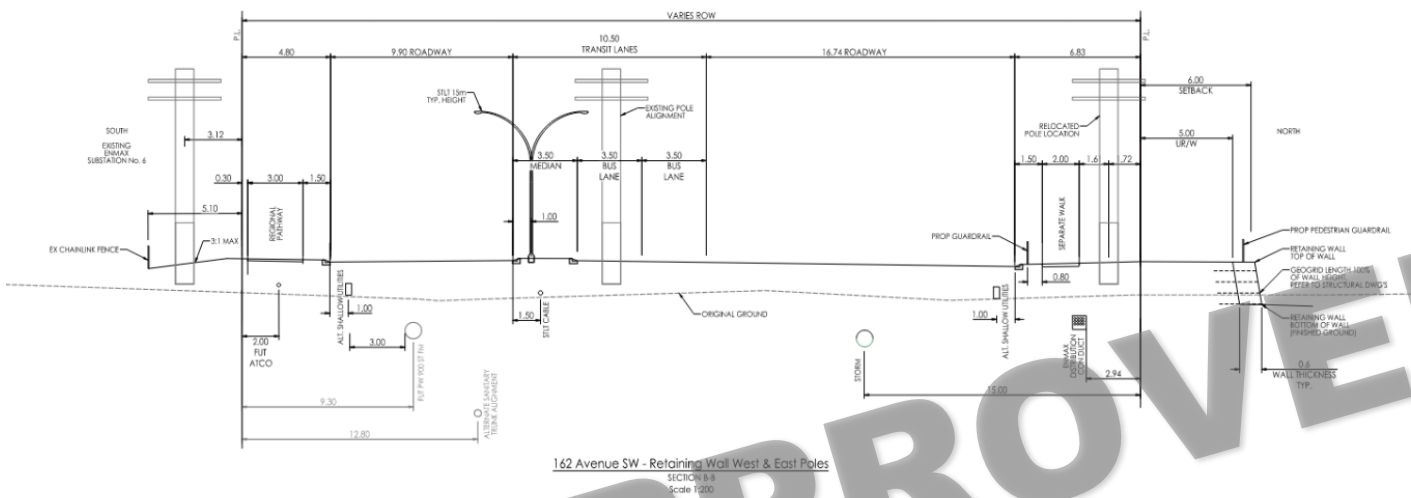
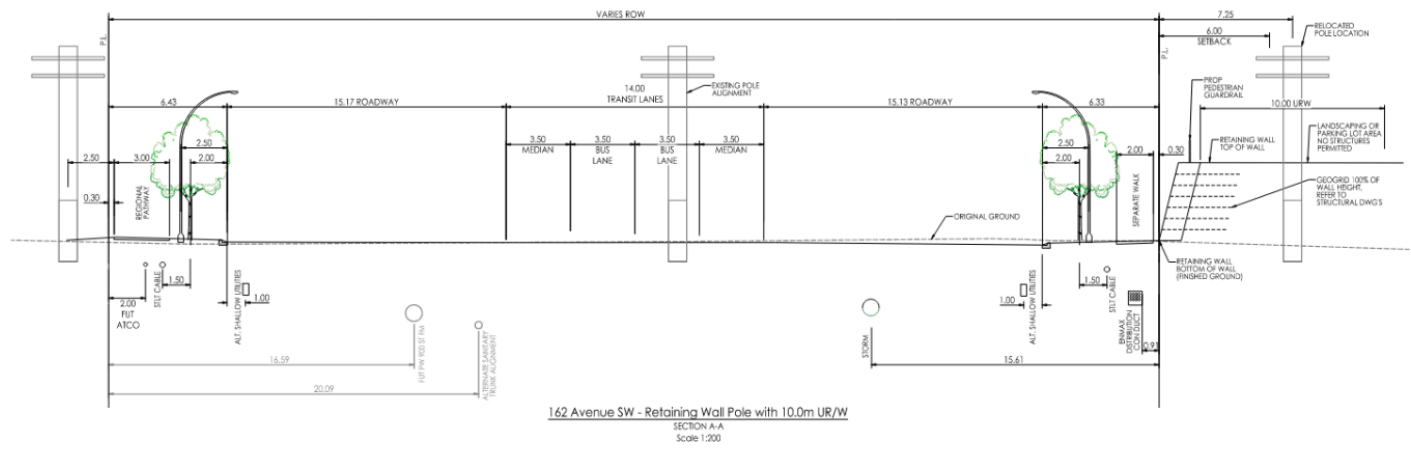

Existing Land Use Redesignation

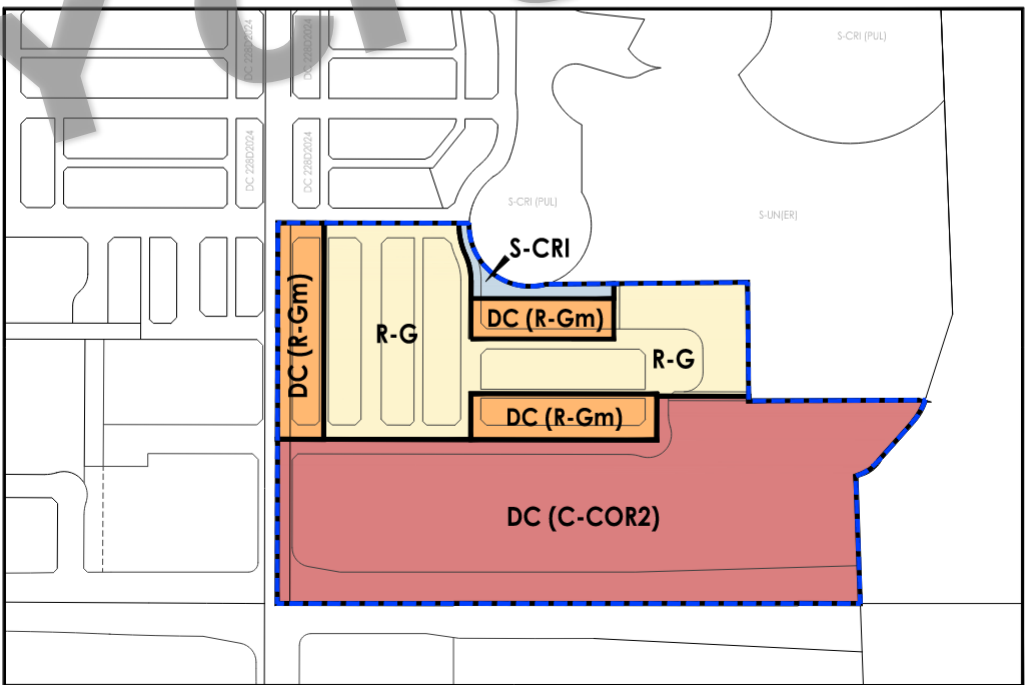

Proposed Land Use Redesignation