

Proposed Direct Control District

1. The Land Use Bylaw, being Bylaw 1P2007 of the City of Calgary, is hereby amended by deleting that portion of the Land Use District Map shown as shaded on Schedule "A" to this Bylaw and replacing it with that portion of the Land Use District Map shown as shaded on Schedule "B" to this Bylaw, including any land use designation, or specific land uses and development guidelines contained in the said Schedule "B".

SCHEDULE A

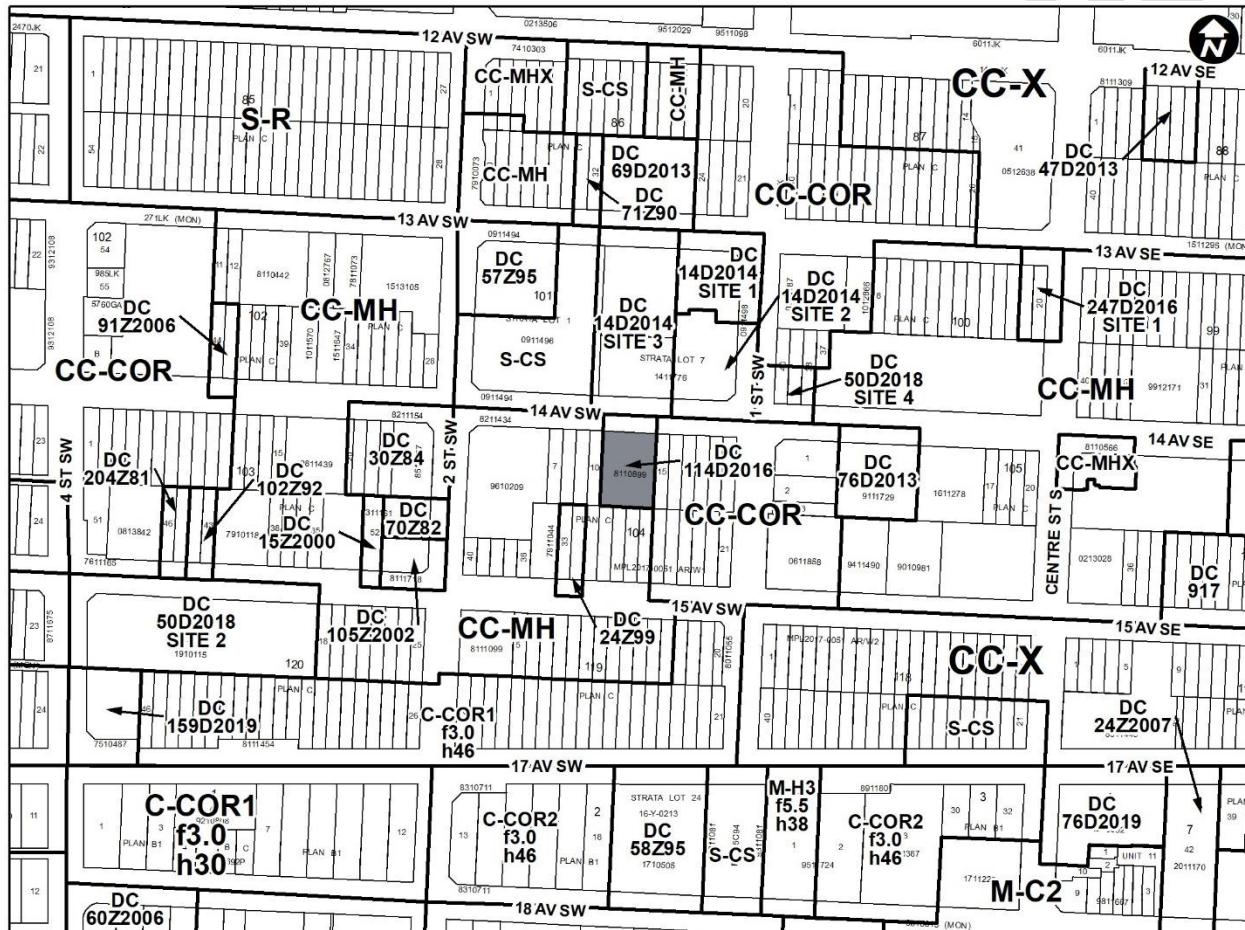
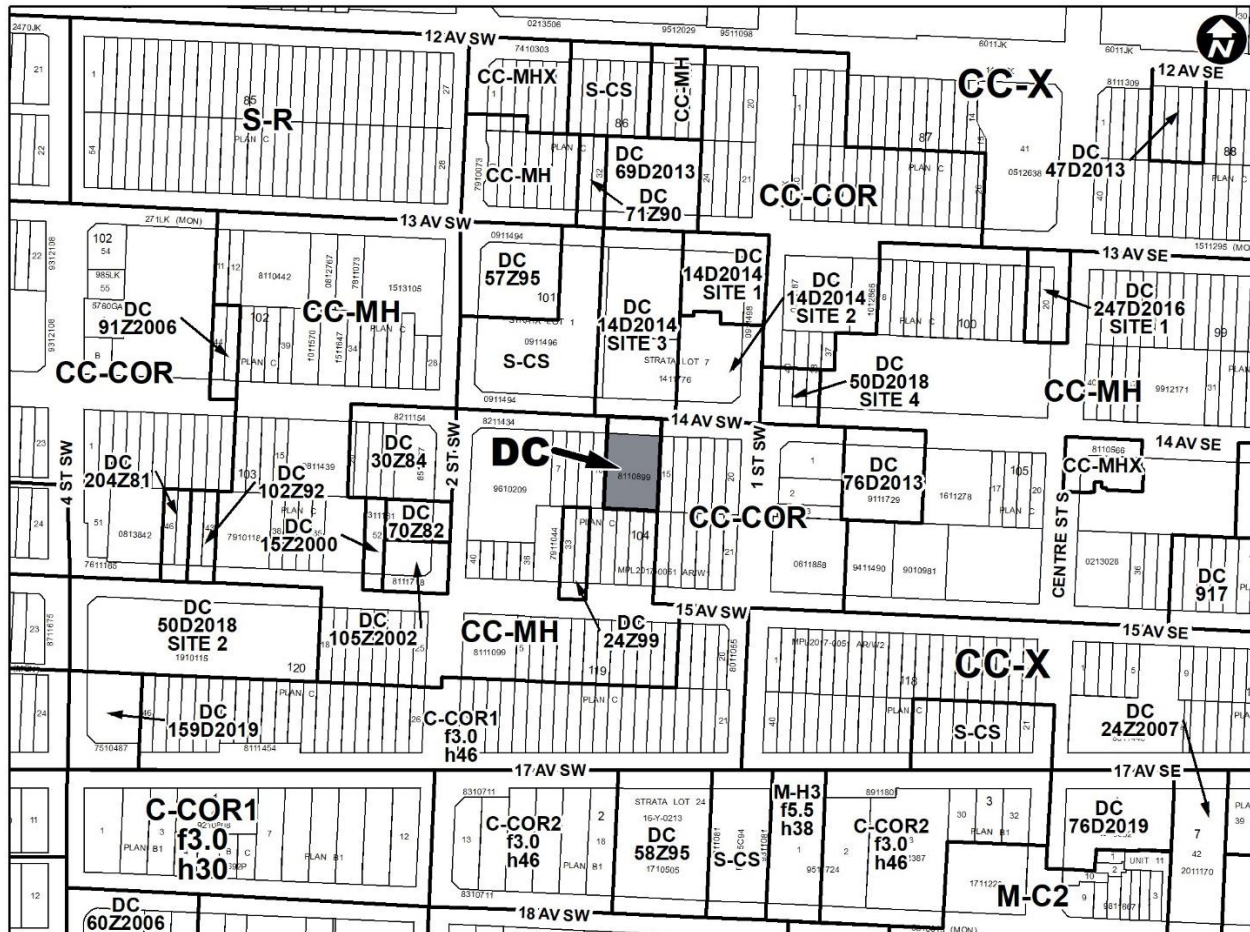

SCHEDULE B**DIRECT CONTROL DISTRICT****Purpose**

- 1 This Direct Control District Bylaw is intended to:
- (a) allow for the additional uses of office, food kiosk and outdoor café; and
 - (b) allow for the additional use of performing arts centre in an existing approved building.

Compliance with Bylaw 1P2007

- 2 Unless otherwise specified, the rules and provisions of Parts 1, 2, 3 and 4 of Bylaw 1P2007 apply to this Direct Control District Bylaw.

Reference to Bylaw 1P2007

- 3 Within this Direct Control District Bylaw, a reference to a section of Bylaw 1P2007 is deemed to be a reference to the section as amended from time to time.

Permitted Uses

- 4 The **permitted uses** of the Centre City Multi-Residential High Rise District (CC-MH) of Bylaw 1P2007 are the **permitted uses** in this Direct Control District.

Discretionary Uses

- 5 (1) The **discretionary uses** of the Centre City Multi-Residential High Rise District (CC-MH) of Bylaw 1P2007 are the **discretionary uses** in this Direct Control District with the addition of the following uses:
- (a) **Food Kiosk;**
 - (b) **Office;** and
 - (c) **Outdoor Café.**
- (2) The following **uses** are additional **discretionary uses** in this Direct Control District if they are located within a **building** existing on the date of passage of this Direct Control District Bylaw:
- (a) **Performing Arts Centre.**

Bylaw 1P2007 District Rules

- 6 Unless otherwise specified, the rules of the Centre City Multi-Residential High Rise District (CC-MH) of Bylaw 1P2007 apply in this Direct Control District

Location of Uses Within Buildings

- 7 A **Performing Arts Centre** must be located at or below **grade**.

Use Area

- 8 (1) The maximum **use area** of an **Office** is 213.80 square metres.
- (2) The maximum **use area** of a **Food Kiosk** is 20.0 square metres.
- (3) The maximum **use area** for the **Performing Arts Centre** is 300.0 square metres.

Relaxations

- 9 The **Development Authority** may relax the rules contained in Section 6 of this Direct Control District Bylaw in accordance with Sections 31 and 36 of Bylaw 1P2007.