

# Proposed Amendments to the Millican-Ogden Area Redevelopment Plan

1. The Millican-Ogden Area Redevelopment Plan attached to and forming part of Bylaw 8P99, as amended, is hereby further amended as follows:
  - (a) Delete the existing Map 5 entitled 'Proposed Land Use Policies' and replace with the revised Map 5 entitled 'Proposed Land Use Policies' attached as Schedule 'A'.
  - (b) In Section 3.4.3 Residential Land Use, subsection 3.4.3.3 Policies, after policy 4 insert the following and renumber the subsequent Policies:
    - "5. Support a comprehensive redevelopment of the Riverbend Transit Station Planning Area, with a mix of uses and building forms including grade-oriented dwelling units, medium density apartments and mixed-use development as well as public open spaces."
  - (c) In Section 3.4.3 5.2 Policies, delete policy 1 and replace with the following:
    - "1. In the area known as Riverbend Transit Station Planning Area on Map 7, the lands should have a mix of uses and building forms including grade-oriented dwelling units, medium density apartments and mixed-use development as well as and public open spaces."
  - (d) Delete the existing Map 7 entitled 'South Hill PROPOSED LAND USE POLICIES' and replace with the revised Map 7 entitled 'South Hill PROPOSED LAND USE POLICIES' attached as Schedule 'B'.
  - (e) In Section 3.4.3.5.3 Implementation, delete bullet 1 in its entirety and replace it with the following:
    - "1. Owner-initiated redesignations (Note: This Plan supports the following owner-initiated redesignations)

| Site | Location                         | Existing Designation | Proposed Redesignation |
|------|----------------------------------|----------------------|------------------------|
| 18   | 8720 - 26 Street SE              | UR                   | DC (RM-H)              |
| 19   | 2729, 2739 & 2749 - 86 Avenue SE | UR                   | RM-H                   |

- (f) Delete the existing Map 8 entitled 'South Hill SITES TO BE REDESIGNATED' and replace with the revised map 8 entitled 'South Hill SITES TO BE REDESIGNATED' attached as Schedule 'C'.

**SCHEDULE 'A'**

**Millican-Ogden**

Map 5  
Proposed  
Land Use Policies

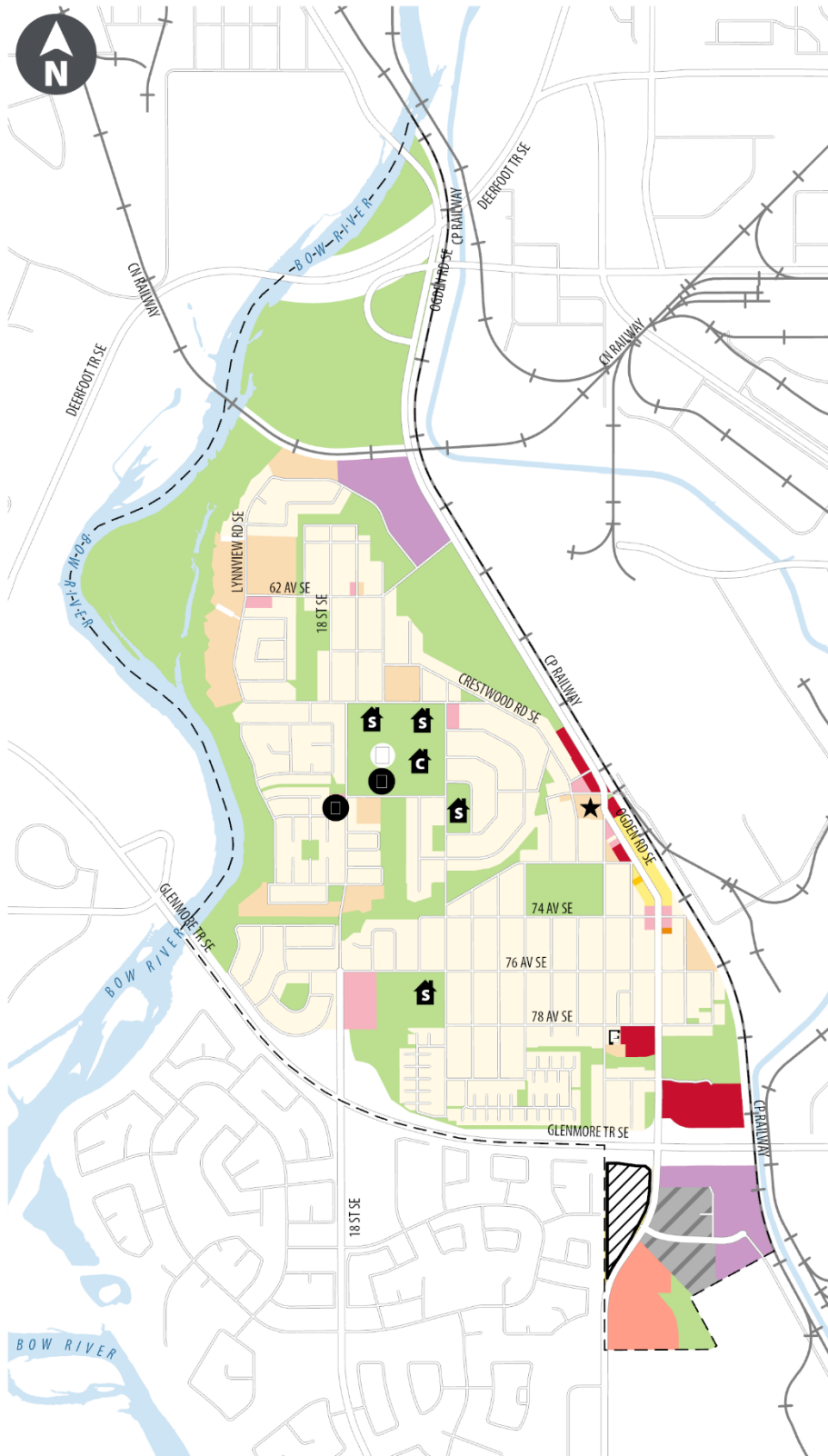

**Legend**

- Plan Area Boundary
- Low Density Conservation
- Low or Medium Density Multi-Dwelling Residential
- Low Density Residential or Live and Work
- Low or Medium Density Multi-Dwelling Residential or Live and Work
- Low Density Residential or Local Commercial
- Local Commercial
- General Commercial
- Light Industrial
- Park and Community Facilities
- Mobile Home Park
- Policy Review
- Arena
- Community Centre
- Library
- Outdoor Pool
- School
- Fire Station
- Limited Commercial
- Riverbend Transit Station Planning Area

**SCHEDULE 'B'**

**Millican-Ogden**

Map 7  
South Hill  
Proposed  
Land Use Policies

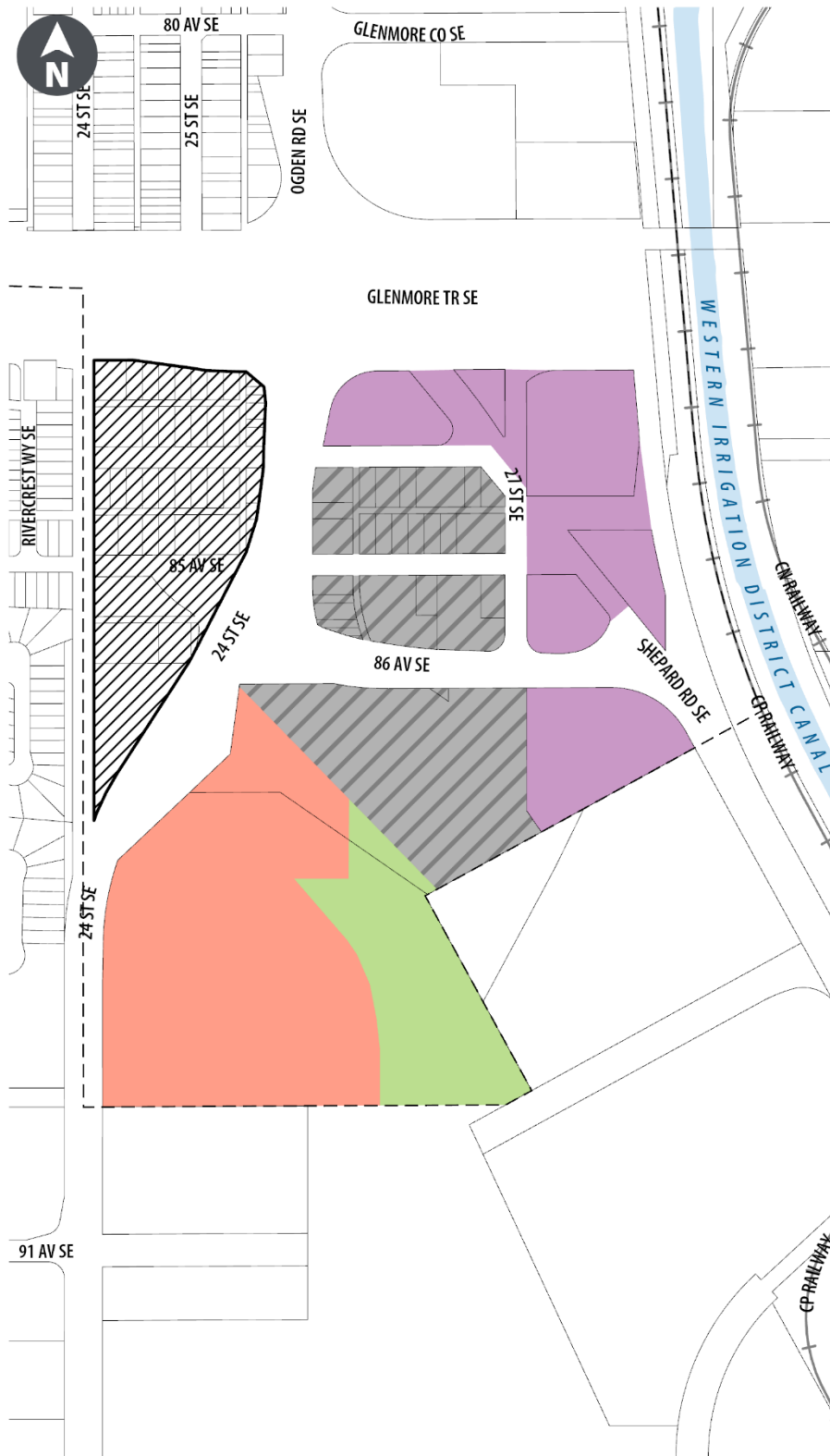

**Legend**

- - - Plan Area Boundary
- Industrial Area
- Mobile Home Park
- Park
- Policy Review
- Riverbend Transit Station Planning Area

**SCHEDULE 'C'**

**Millican-Ogden**

Map 8  
South Hill  
Sites to Be  
Redesignated

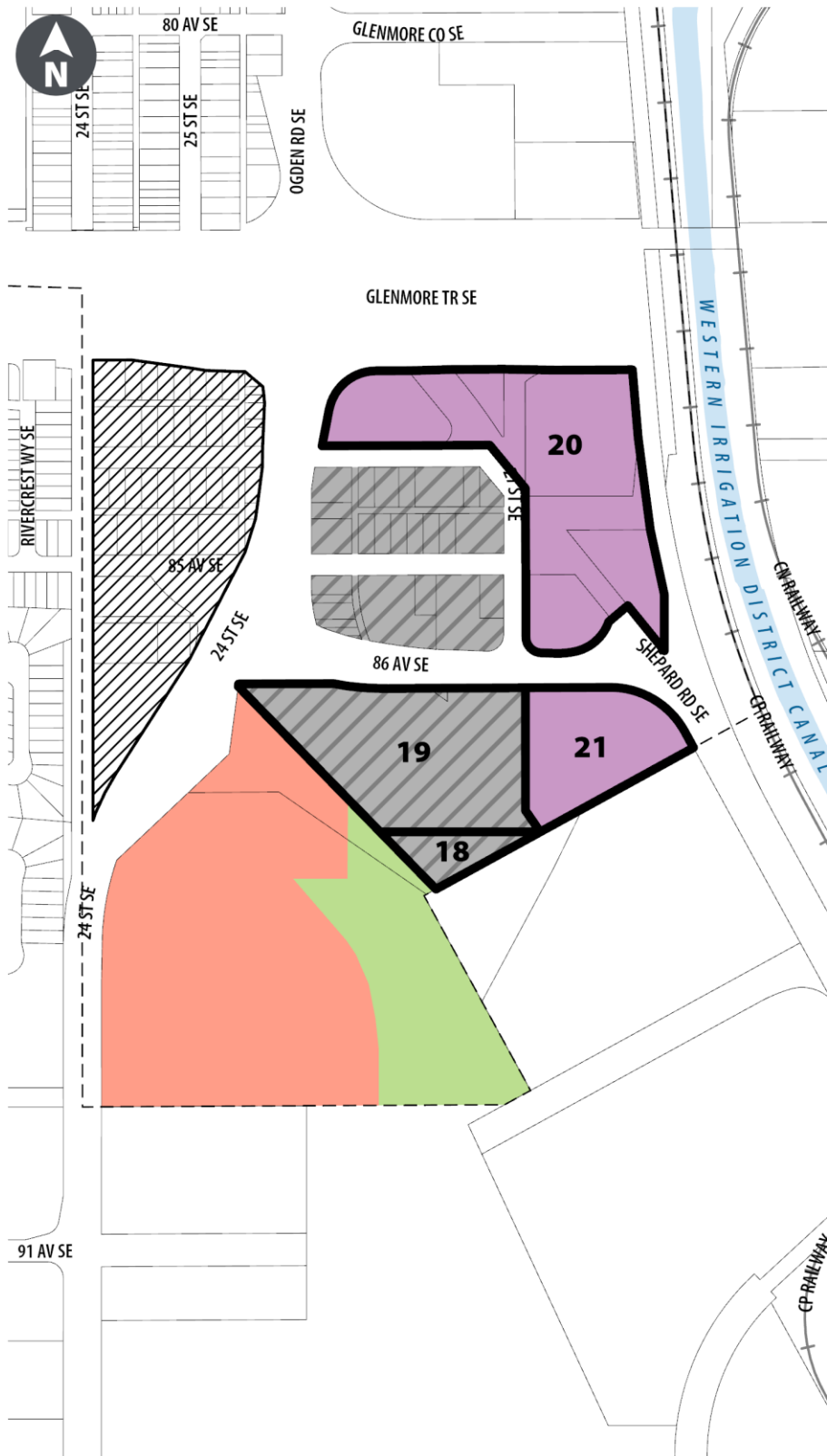

**Legend**

- - - Plan Area Boundary
- Industrial Area
- Mobile Home Park
- Park
- Policy Review
- Numbered Sites
- Riverbend Transit Station Planning Area