

Glacier Ridge Area Structure Plan

Map 4: Communities and Neighborhoods

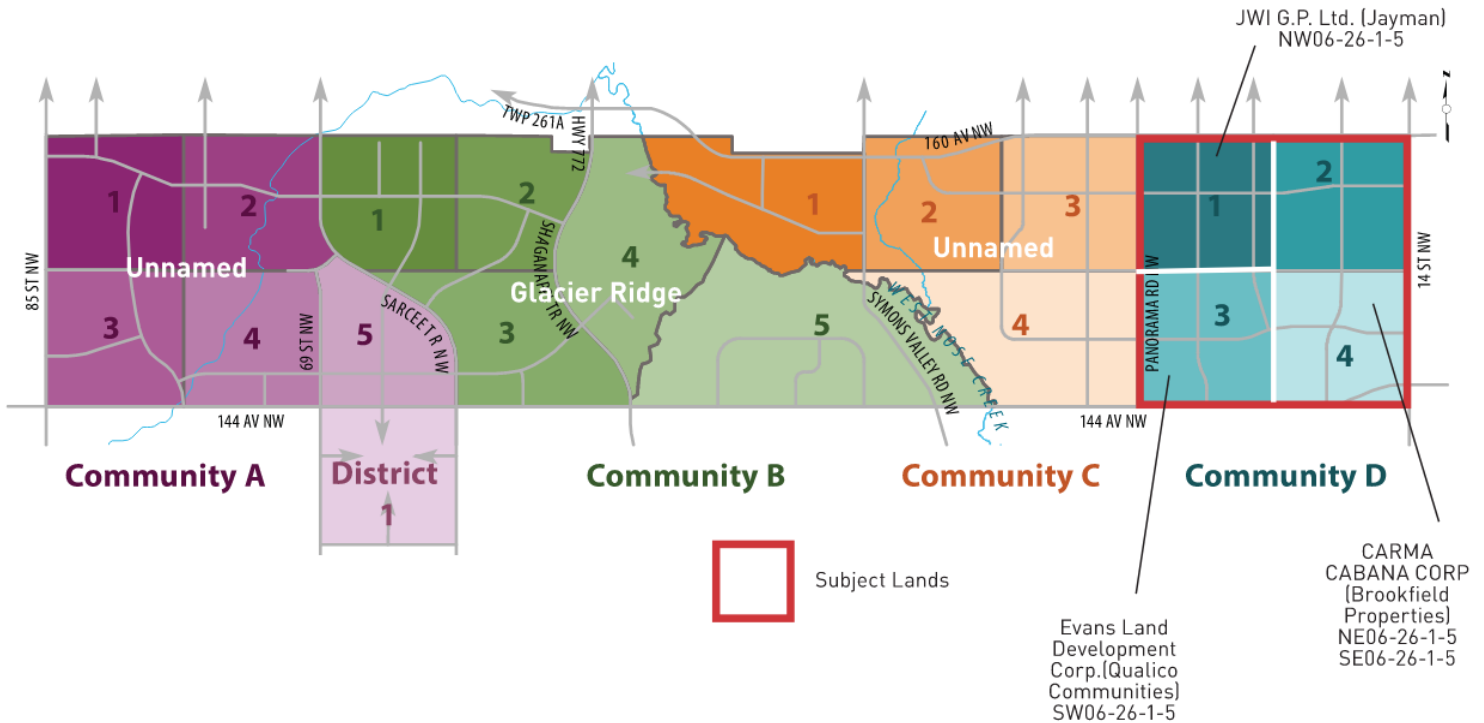

APPROVED GLACIER RIDGE ASP - Communities and Neighbourhoods
FIGURE: OWNERSHIP

3.1 COMMUNITIES AND NEIGHBOURHOODS

INTENT

Provide the framework for the development of complete and distinct communities and neighbourhoods.

POLICIES

1. The Plan Area should create four Communities and 18 Neighbourhoods and one District as shown on **Map 4: Communities and Neighbourhoods**.

Bylaw 37P2016