

Proposed Direct Control District

1. The Land Use Bylaw, being Bylaw 1P2007 of the City of Calgary, is hereby amended by deleting that portion of the Land Use District Map shown as shaded on Schedule "A" to this Bylaw and replacing it with that portion of the Land Use District Map shown as shaded on Schedule "B" to this Bylaw, including any land use designation, or specific land uses and development guidelines contained in the said Schedule "B".

SCHEDULE A

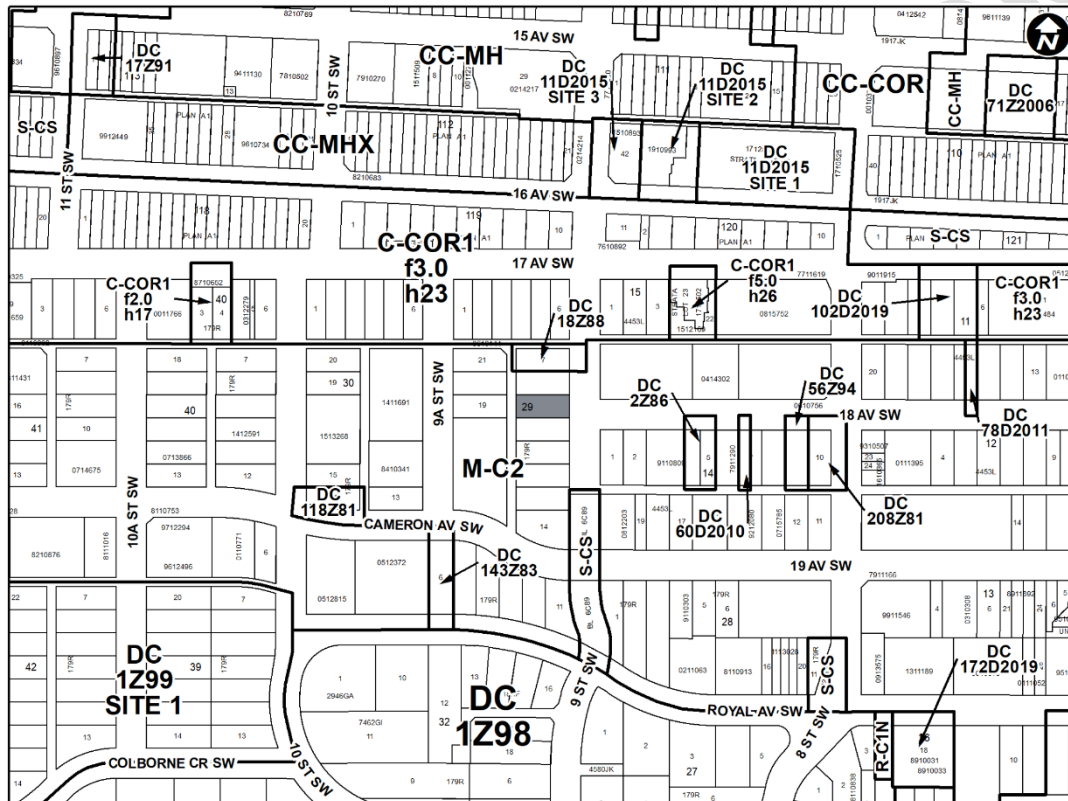

SCHEDULE B

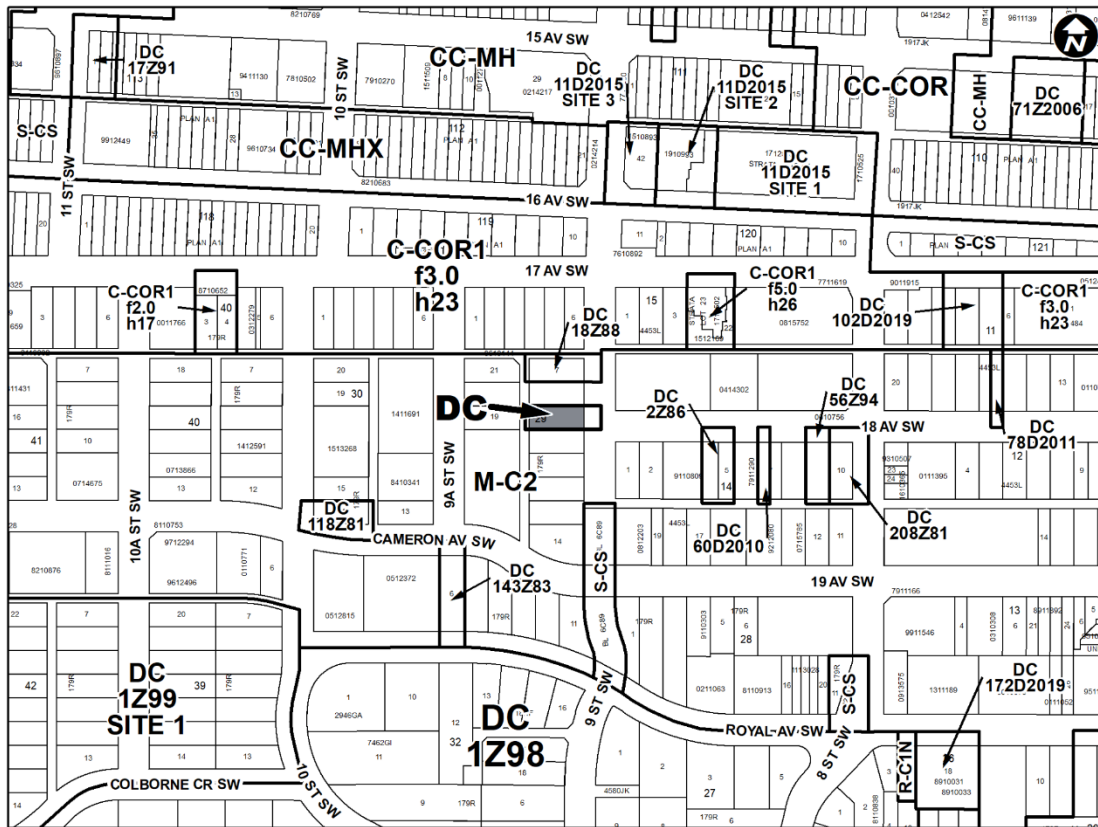

DIRECT CONTROL DISTRICT

Purpose

1 This Direct Control District Bylaw is intended to:

- (a) allow for the additional use of a wellness and arts centre; and
- (b) allow for the adaptive reuse of a building that has been designated as a municipal historic resource.

Compliance with Bylaw 1P2007

2 Unless otherwise specified, the rules and provisions of Parts 1, 2, 3 and 4 of Bylaw 1P2007 apply to this Direct Control District Bylaw.

Reference to Bylaw 1P2007

3 Within this Direct Control District Bylaw, a reference to a section of Bylaw 1P2007 is deemed to be a reference to the section as amended from time to time.

Defined Uses

4 In this Direct Control District:

- (a) **“Wellness and Arts Centre”** means a *use*:

- (i) where art is produced by individuals;
- (ii) where art may be stored, maintained and displayed for the purposes of public viewing;
- (iii) that may include the instruction of art to individuals;
- (iv) that includes the general sale of products related to this **use**;
- (v) where space, equipment or instruction is provided for people to pursue a broad range of artistic, therapeutic, counselling or other wellness-related activities;
- (vi) that may include a reception area and rooms for administrative functions of the principal **use**;
- (vii) that may operate in conjunction with another approved **use**; and
- (viii) does not require **motor vehicle parking stalls**.

Permitted Uses

5 The **permitted uses** of the Multi-Residential – Contextual Medium Profile (M-C2) District of Bylaw 1P2007 are the **permitted uses** in this Direct Control District.

Discretionary Uses

- 6** (1) The **discretionary uses** of the Multi-Residential – Contextual Medium Profile (M-C2) District of Bylaw 1P2007 are the **discretionary uses** in this Direct Control District.
- (2) The following **use** is an additional **discretionary use** when the **use** is located within a **building** that exists on the date of passage of this Direct Control District Bylaw:
- (a) **Wellness and Arts Centre.**

Bylaw 1P2007 District Rules

7 Unless otherwise specified, the rules of the Multi-Residential – Contextual Medium Profile (M-C2) District of Bylaw 1P2007 apply in this Direct Control District.

Required Bicycle Parking Stalls for Wellness and Arts Centre

8 A **Wellness and Arts Centre** does not require **bicycle parking stalls – class 1** and requires a minimum of 4.0 **bicycle parking stalls – class 2** per 115.0 square metres of **gross usable floor area**.

Relaxations

9 The **Development Authority** may relax the rules contained in Sections 7 and 8 of this Direct Control District Bylaw in accordance with Sections 31 and 36 of Bylaw 1P2007.