

Connectivity Supplementary Project Information

Area Connectivity

The pedestrian overpass provides an important link as there are limited north south crossings along 16 Avenue NW. The ramp alignment was designed considering desired routes for travel, the network of regional pathways, locations of the Bus Rapid Transit (BRT) stations, and integration with the north and south developments.

The existing regional pathways extends to the west on the south side of 16 Avenue and to the east on the north side. On street bikeways along Uxbridge Drive and 29 Street NW extends to the north and to the south (see Attachment 2, Figure 1).

Figure 1: Overview Map of Regional Pathways, Bikeways and BRT

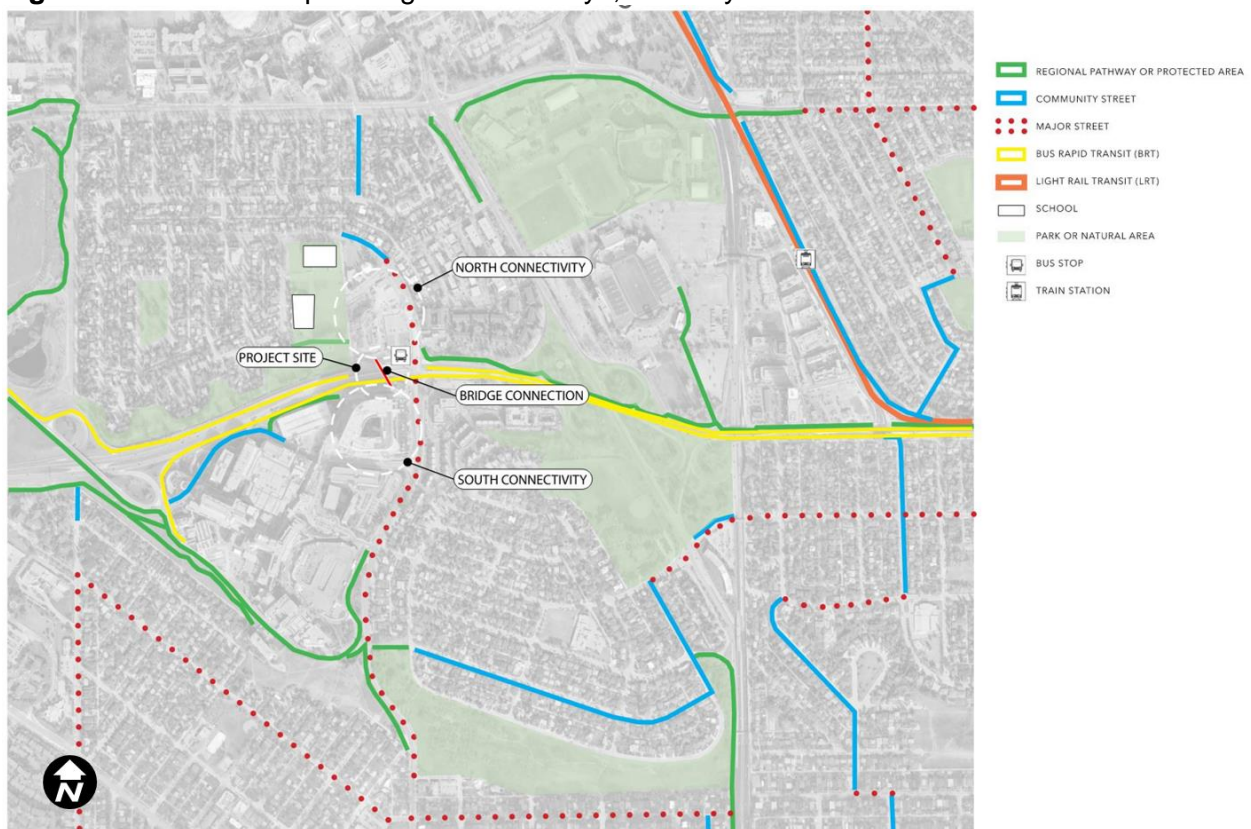

Pedestrian Overpass Connectivity

On the north side of 16 Avenue NW, the pedestrian overpass users will have access through a bridge level entrance of the medical office building to elevator and stairs. The elevator and stairs will be accessible 24 hours a day, 7 days a week. If required security and emergency access to additional elevators in the building will be available. An exterior stair will provide an alternate access from the bridge for a direct connection to the regional pathway system and the Bus Rapid Transit (BRT) platform (see Attachment 2, Figure 2).

On the south side of 16 Avenue NW, the pedestrian overpass users will have access to the bridge by a ramp structure alignment that runs towards the west, integrating with the Foothills Medical Centre and Calgary Cancer Centre pathway system. An additional stair access will provide an alternate route to the regional pathway system and the BRT platform.

Figure 2: Plan View – Pedestrian Overpass Connectivity

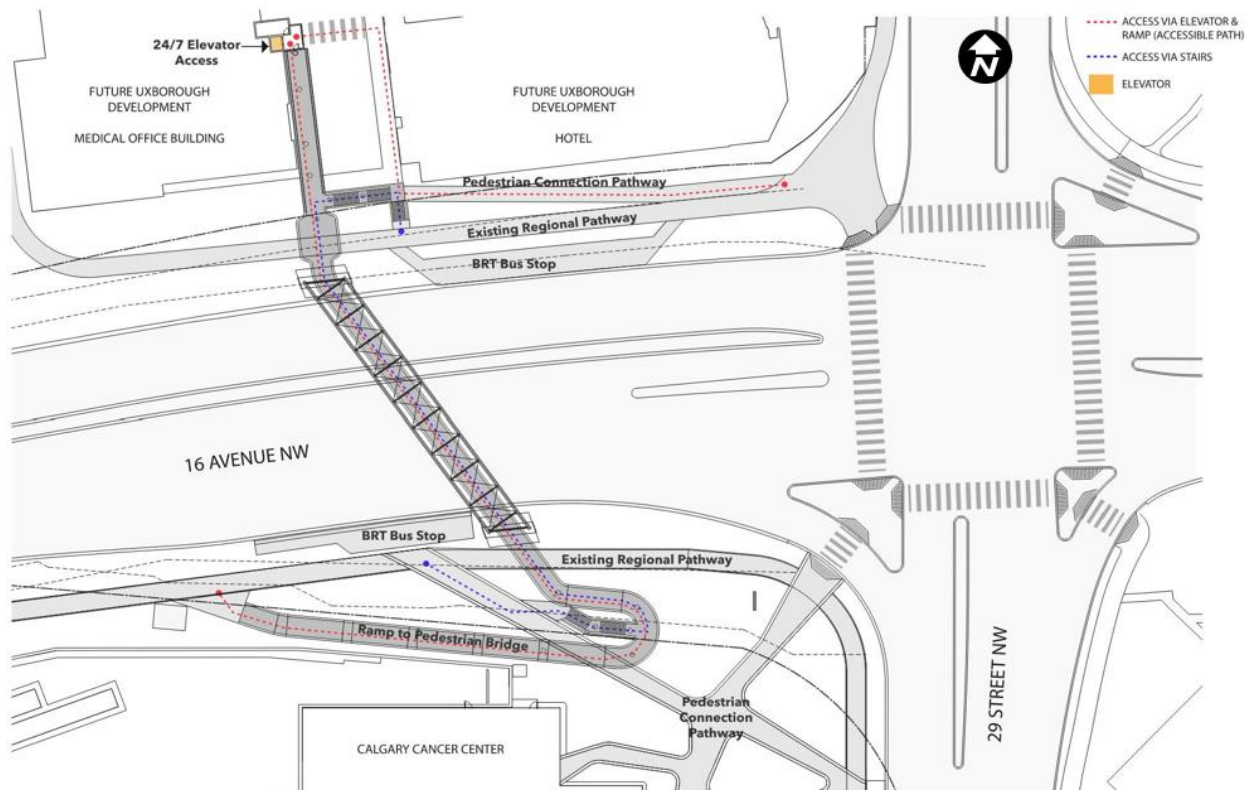

UXBorough Connectivity

The UXBorough development includes an urban environment which consists of pathways, landscaping, planters, places to gather and places to rest. The main plaza area is located in the heart of the development with pedestrian routes running through and around the development with access points leading into the community and further to the University of Calgary Campus, Alberta Children's Hospital and Foothills Athletic Park. The pedestrian overpass will link to the south end of the development's network (see Attachment 2, Figure 3).

Figure 3: Plan View - UXBorough Connectivity

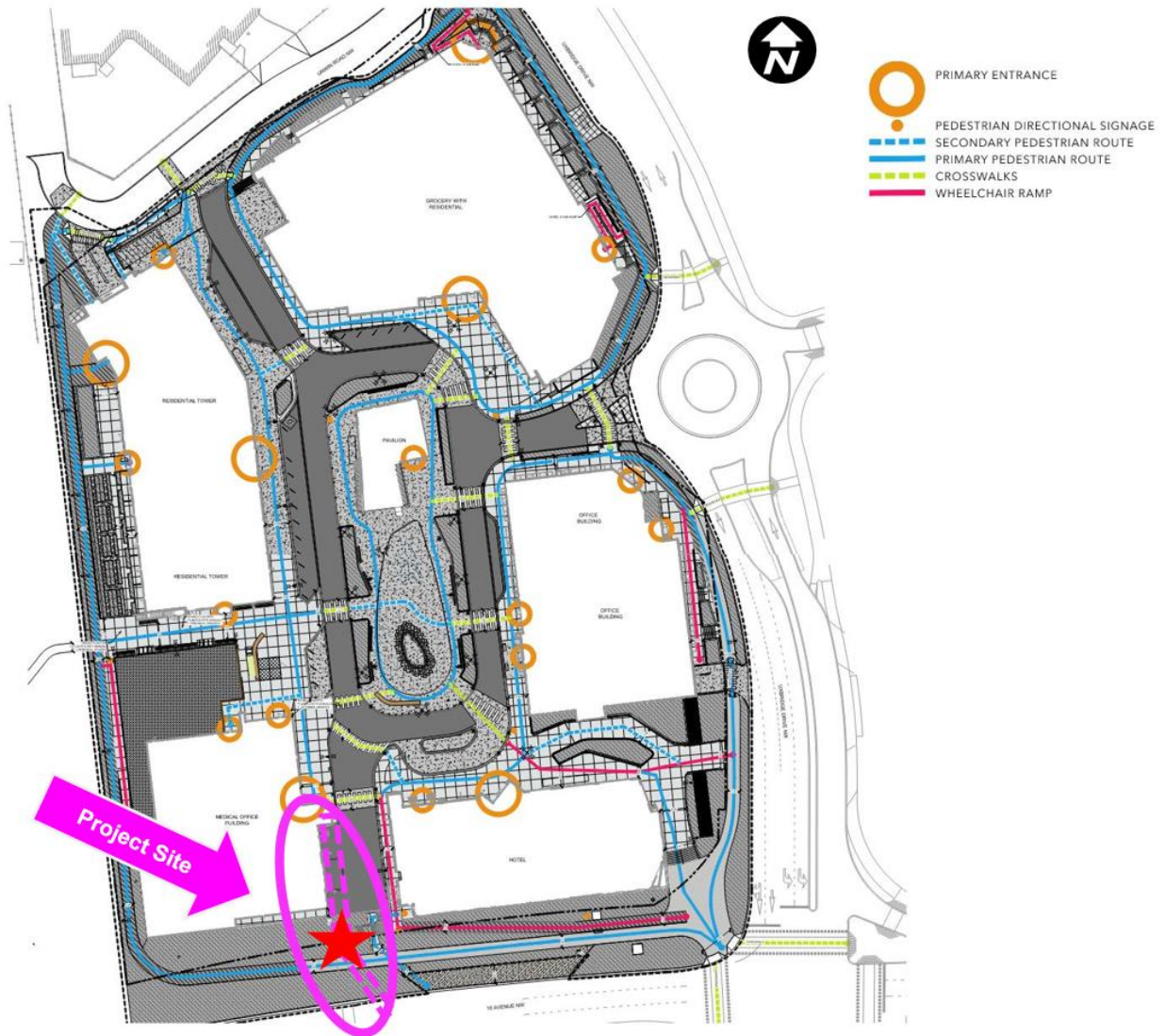

Calgary Cancer Centre Connectivity

The Calgary Cancer Centre urban environments consists of pathways, landscaping, planters, places to gather and places to rest and is located along the east and south sides. The pedestrian routes run through the urban landscaped areas and around the Cancer Centre building connecting to the pedestrian network throughout the Foothills Medical Centre and further to the communities and towards the Bow River. On the west side of the Calgary Cancer Centre, an extended corridor allows for pedestrian traffic to connect from the Calgary Cancer Centre to the Foothills Medical Centre. The pedestrian overpass will link to the north end of the urban landscaped area of the Calgary Cancer (see Attachment 2, Figure 4).

Figure 4: Plan View – Calgary Cancer Centre Connectivity

