

BYLAW NUMBER 126D2014

**BEING A BYLAW OF THE CITY OF CALGARY
TO AMEND THE LAND USE BYLAW 1P2007
(LAND USE AMENDMENT LOC2014-0057)**

WHEREAS it is desirable to amend the Land Use Bylaw Number 1P2007 to change the land use designation of certain lands within the City of Calgary;

AND WHEREAS Council has held a public hearing as required by Section 692 of the Municipal Government Act, R.S.A. 2000, c.M-26 as amended;

NOW, THEREFORE, THE COUNCIL OF THE CITY OF CALGARY ENACTS AS FOLLOWS:

1. The Land Use Bylaw, being Bylaw 1P2007 of the City of Calgary, is hereby amended by deleting that portion of the Land Use District Map shown as shaded on Schedule "A" to this Bylaw and substituting therefor that portion of the Land Use District Map shown as shaded on Schedule "B" to this Bylaw, including any land use designation, or specific land uses and development guidelines contained in the said Schedule "B".
2. This Bylaw comes into force on the date it is passed.

READ A FIRST TIME THIS ____ DAY OF _____, 2014.

READ A SECOND TIME THIS ____ DAY OF _____, 2014.

READ A THIRD TIME THIS ____ DAY OF _____, 2014.

MAYOR
SIGNED THIS ____ DAY OF _____, 2014.

CITY CLERK
SIGNED THIS ____ DAY OF _____, 2014.

SCHEDULE A

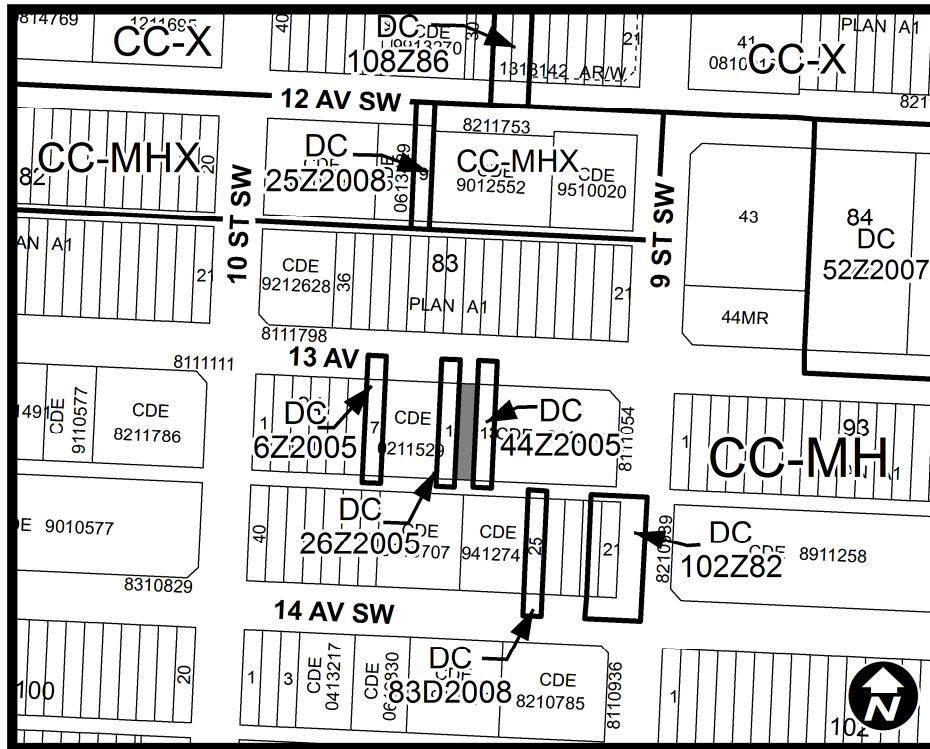

PROPOSED

SCHEDULE B

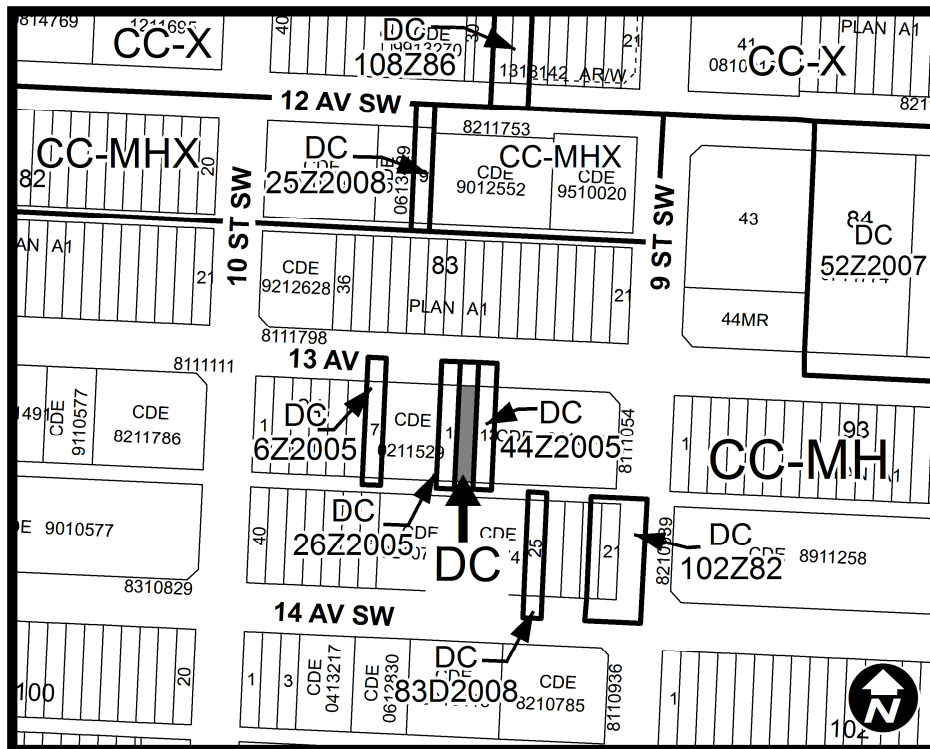

DC DIRECT CONTROL DISTRICT

Purpose

- 1 This Direct Control District is intended to:
 - (a) provide for **Office uses** as a **discretionary use** within the existing **building**.

Compliance with Bylaw 1P2007

- 2 Unless otherwise specified, the rules and provisions of Parts 1, 2, 3 and 4 of Bylaw 1P2007 apply to this Direct Control District.

Reference to Bylaw 1P2007

- 3 Within this Direct Control District, a reference to a section of Bylaw 1P2007 is deemed to be a reference to the section as amended from time to time.

PROPOSED

Permitted Uses

- 4 The **permitted uses** of the Centre City Multi-Residential High Rise District (CC-MH) are the **permitted uses** in this Direct Control District.

Discretionary Uses

- 5 (1) The **discretionary uses** of the Centre City Multi-Residential High Rise District (CC-MH) of Bylaw 1P2007 are the **discretionary uses** in this Direct Control District.
- (2) The following **uses** are additional **discretionary uses** in this Direct Control District if they are located within the existing **building**:
- (a) **Office.**

Bylaw 1P2007 District Rules

- 6 Unless otherwise specified, the rules of the Centre City Multi Residential High Rise District (CC-MH) of Bylaw 1P2007 apply in this Direct Control District.

Signage

- 7 A maximum of one **Sign - Class A** per **building**, with a maximum **sign area** of 1 square metre is allowed.