

Approved Outline Plan

Calgary Planning Commission is the Approving Authority for the Outline Plan. Attachment for Council's reference only.

LEGEND

- Outline Plan Boundary
- Contours (0.5m Interval)
- Existing Vegetation
- Proposed Sanitary Line
- Proposed Water Line
- Proposed Storm Line
- Proposed Overland Drainage R/W
- Proposed Utility R/W
- Proposed Fencing along Elveden Drive
- Existing Sanitary Line
- Existing Water Line
- Existing Storm Line
- Existing Chain Link Fence
- Existing Trees to be retained, trees on the remainder of site will be preserved to the extent possible.

Outline Plan Statistics	±Acres	±Hectares	%
Total Site Area	1.95	0.791	
Residential (R-1)	1.64	0.663	84.10
Residential One Dwelling District			
Roads	0.31	0.128	18.90

Landuse Statistics	±Acres	±Hectares
DC 12Z96 to R-1	1.95	0.791

Anticipated Density	Residential (R-1)
	4.1 upa 10.1 uph 8 Lots

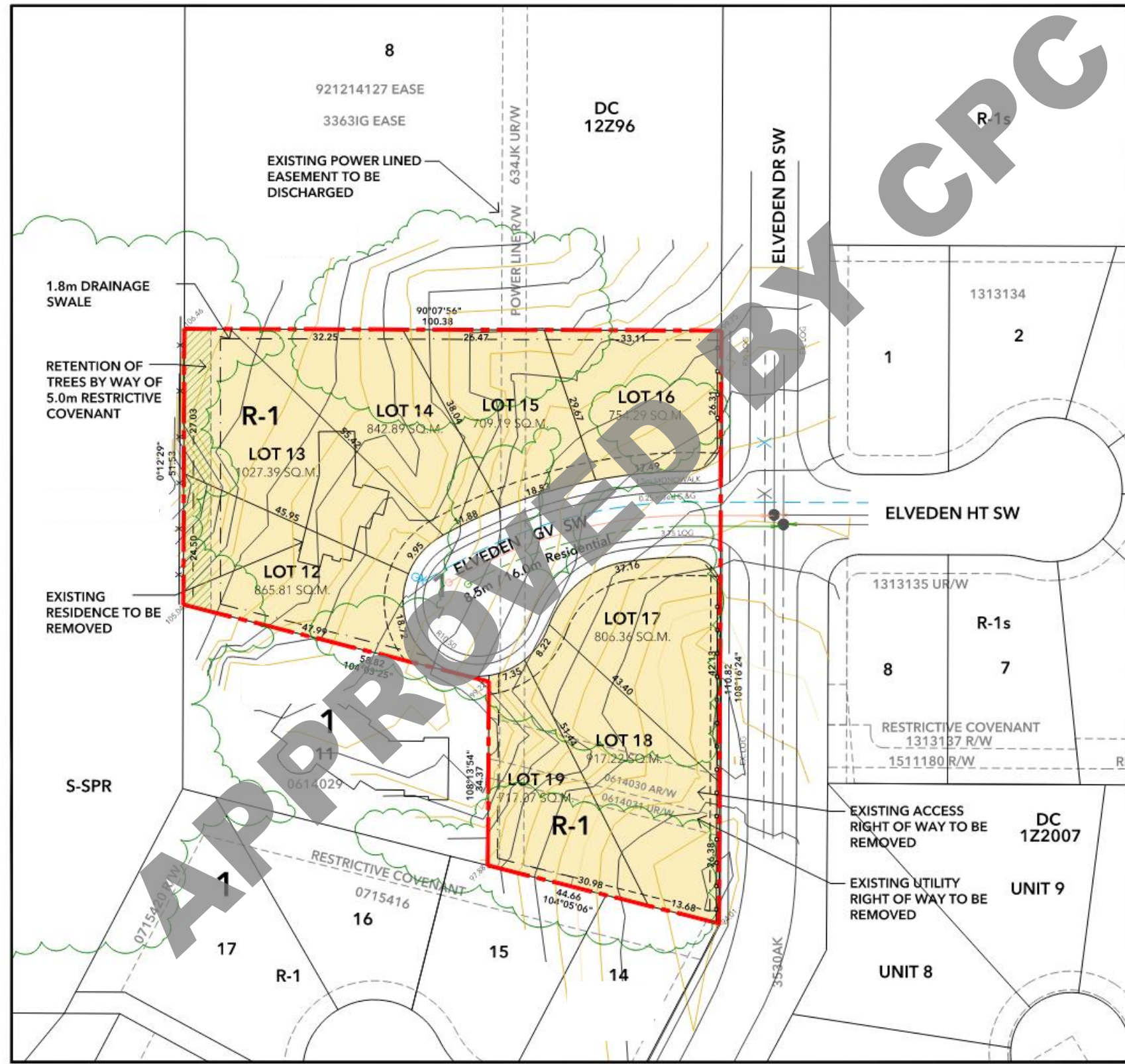
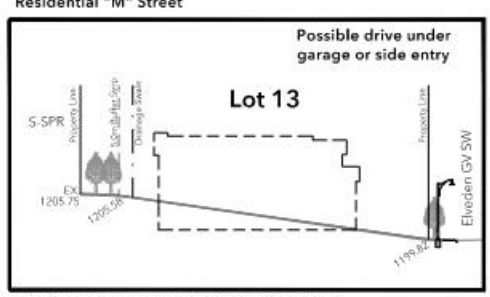
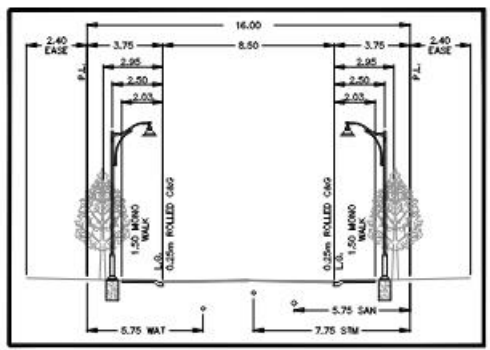

CLIENT
GREEN CEDAR HOMES

PROJECT NUMBER
21-030

LEGAL ADDRESS
LOT 7, BLOCK 1 PLAN 2370 1B
SE ¼ SEC 10-24-2 W5M

MUNICIPAL ADDRESS
17 ELVEDEN DRIVE SW

DATE
May 2, 2022



General Note
All roof drainage will be directed to the front yard/street
Grades along western property line are to be matched to MR

Outline Plan & Land Use Application

SCALE
1:750

SHEET
S1
OUTLINE PLAN



CLIENT
GREEN CEDAR HOMES

PROJECT NUMBER
21-030

LEGAL ADDRESS
LOT 7, BLOCK 1 PLAN 2370 IB
SE 1/4 SEC 10-24-2 W5M

MUNICIPAL ADDRESS
17 ELVEDEN DRIVE SW

DATE
May 2, 2022



General Note
All roof drainage will be directed to the front yard/street
Grades along western property line are to be matched to MR

Outline Plan & Land Use Application

SCALE
1:750

SHEET
S2
OUTLINE PLAN

LEGEND

- Outline Plan Boundary
- Contours (0.5m Interval)
- Existing Vegetation
- Proposed Sanitary Line
- Proposed Water Line
- Proposed Storm Line
- Proposed Overland Drainage R/W
- Proposed Utility R/W
- Proposed Fencing along Elveden Drive
- Existing Sanitary Line
- Existing Water Line
- Existing Storm Line
- Existing Chain Link Fence
- Existing Trees to be retained, trees on the remainder of site will be preserved to the extent possible.

Outline Plan Statistics

	±Acres	±Hectares	%
Total Site Area	1.95	0.791	
Residential (R-1)	1.64	0.663	84.10
Residential One Dwelling District			
Roads	0.31	0.126	18.90

Landuse Statistics

	±Acres	±Hectares
DC 12Z96 to R-1	1.95	0.791

Anticipated Density

	±Acres	±Hectares	
Residential (R-1)	4.1 upa	10.1 uph	8 Lots

