



prime consultant:
B&A Planning Group
600, 215 - 9th Ave SW
Calgary, Alberta | T2P 1K3 | bagp.ca
t: 403 269 4733 f: 403 262 4480

copyright:
Any reproduction or distribution for any purpose other than authorized by B&A Planning Group is forbidden. Written dimensions shall have precedence over scaled dimensions. Contractors shall verify and be responsible for all dimensions and conditions shown on the drawing.
client:



revisions:

no:	date:	description:
1	13-AUG-2021	OP Setup
2		
3		
4		
5		
6		
7		
8		
9		

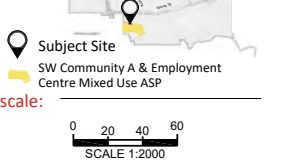
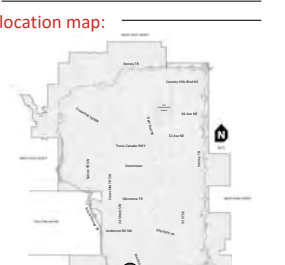

municipal address:
1811 Sheriff King Street SW & 1203 Spruce Meadows Trail SW

legal description:
Plan 821 1167 & Plan 851 0369

file description:
pre-app:
LOC: **LOC2021-0152**

file info:
project no.: **2002-08**
drawn by: **ES/BD**
start date: **2021AUG13**
current date: **May 18, 2022**

project:
North Silverado

sheet title:
Outline Plan & Land Use Redesignation

exhibit no.:
1.0

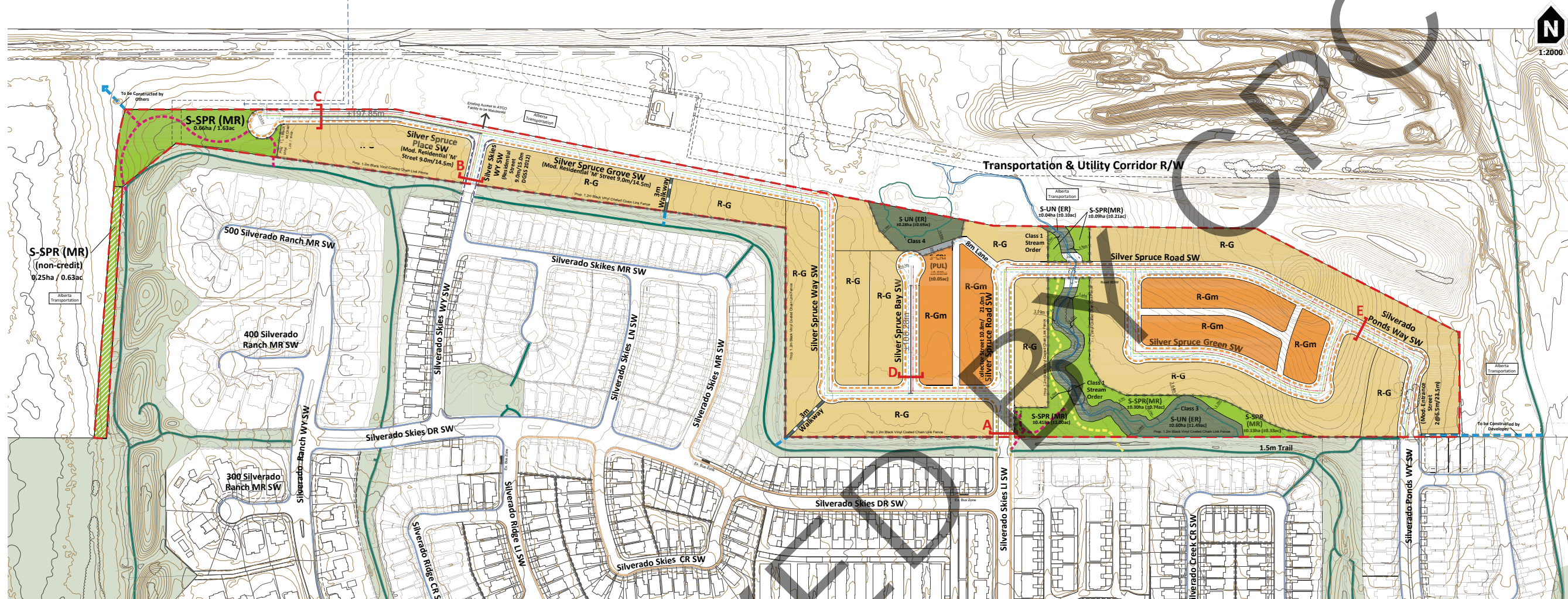

OUTLINE PLAN STATISTICS						
	Lot Width/ widths per acre	Frontage	Hectares	Acres	Number of Lots/Units	% of ODA
Total Area			16.78	41.46		
Less Environmental Reserve			0.82	2.28		
Gross Developable Area			15.96	39.18		100.0%
Residential - Single Family			10.35	25.09		64.4%
Residential - Low Density Mixed Housing District (R-G)			8.20	20.27		
Anticipated number of lots/units based on 9.0m lot width	6.94	2,272.53	8.20	20.27	257	
Maximum number of lots based on 6.0m lot width	6.08	2,272.53			379	
Residential - Low Density Mixed Housing District (R-Gm)			5.00	12.30		30.8%
Anticipated number of lots/units based on 6.0m lot width	8.00	400.70	5.00	12.30	102	
Maximum number of lots/units based on 6.0m lot width	8.00	400.70			122	
Total Frontage		2,962.23				
Total Number of Units					359	
Anticipated					359	
Maximum					607	
Density						
Anticipated	22.8 upts/acre			8.2 upts/acre		
Minimum	7.0 upts/acre			12.8 upts/acre		
Open Space			1.84	4.54		11.8%
Special Purpose - School, Park and Community (S-SPR (MR)) - Child			1.80	4.41		10.8%
Special Purpose - School, Park and Community (S-SPR (MR)) - Non-Child			0.25	0.63		1.6%
Public Utility Lots			0.02	0.05		0.1%
Roadways and Lanes			3.84	9.50		24.2%
Collector Street (10.0m/21.0m)			0.37	0.91		
Residential Street (9.0m/15.0m DGSS 2012)			0.07	0.17		
Modified Residential 'M' Street (9.0m/16.0m)			1.20	3.17		
Modified Residential 'M-L' Street (9.0m/14.5m)			0.94	2.32		
Modified Residential 'M' Street (9.0m/14.5m)			0.88	2.19		
Lane (7.0m)			0.25	0.63		
Walkway			0.04	0.11		

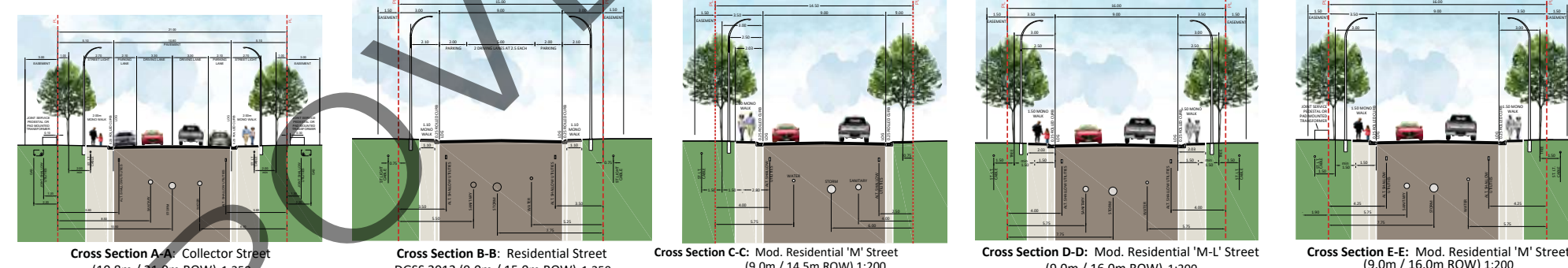

LAND USE REDESIGNATION STATISTICS					
Land Use	to	Land Use	hectares	acres	
R-G	to	R-Gm	0.72	1.78	
M-G	to	R-G	3.40	8.41	
M-G	to	R-Gm	1.04	2.58	
M-G	to	S-CRI(PUL)	0.03	0.07	
M-G	to	S-SPR(MR)	0.06	0.15	
M-2	to	R-G	1.87	4.62	
M-2	to	R-Gm	1.20	2.96	
M-2	to	S-SPR(MR)	0.02	0.04	
R-1a	to	R-G	3.18	7.86	
R-1a	to	S-SPR(MR)	0.13	0.31	
S-SPR	to	R-G	1.68	4.14	
Total			13.33	32.93	

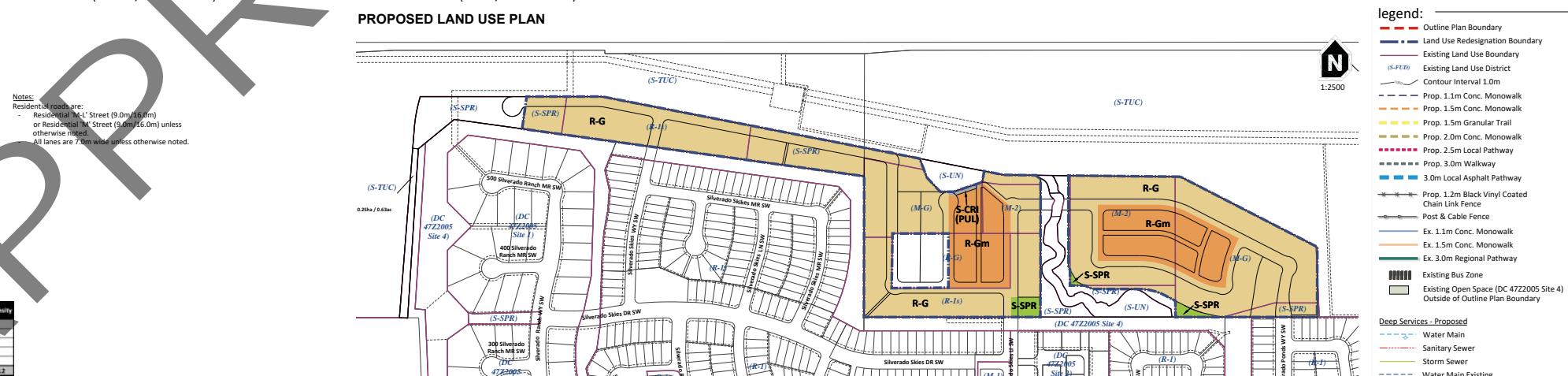

Notes:
Residential 'M' Streets are:
Residential 'M-L' Street (9.0m/14.5m)
or Residential 'M' Street (9.0m/16.0m) unless
otherwise noted.
All lanes are 7.0m wide unless otherwise noted.