

Approved Outline Plan – LOC2017-0111

ROAD CROSS SECTIONS

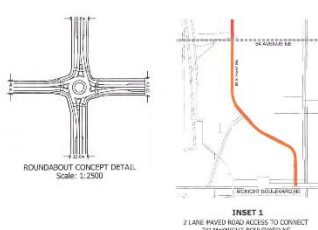
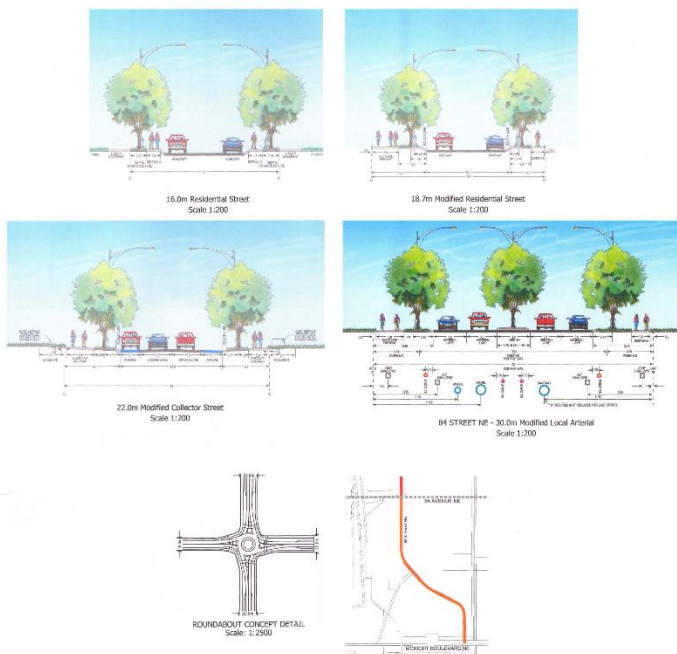

LAND USE PLAN

	Hectares	Acres	%
Gross Area	96.15	237.59	
S-FUD to R-G (Residential - Low Density Mixed Housing District)	49.94	123.40	53
S-FUD to R-Gm (Residential - Low Density Mixed Housing District)	7.95	19.64	8
S-FUD to R-MH (Residential - Medium Density Mixed Housing District)	10.46	25.85	11
S-FUD to M-G (Multi-Residential - All Grade Housing District)	6.86	16.95	7
S-FUD to C-1 (Commercial - Community 1 District)	1.97	4.87	2
S-FUD to I-G (Industrial - General District)	9.93	24.53	11
S-FUD to S-CU (Special Purpose - Community Service District)	3.57	8.82	4
S-FUD to S-OU (Special Purpose - School, Park and Community Reserve District)	1.82	4.50	2
S-FUD to S-SPR (Special Purpose - School, Park and Community Reserve District)	10.93	27.01	11
S-FUD to S-FUD (Urban Nature District)	0.63	1.56	1
S-FUD to S-FUD (Urban Nature District)	1.94	4.79	5

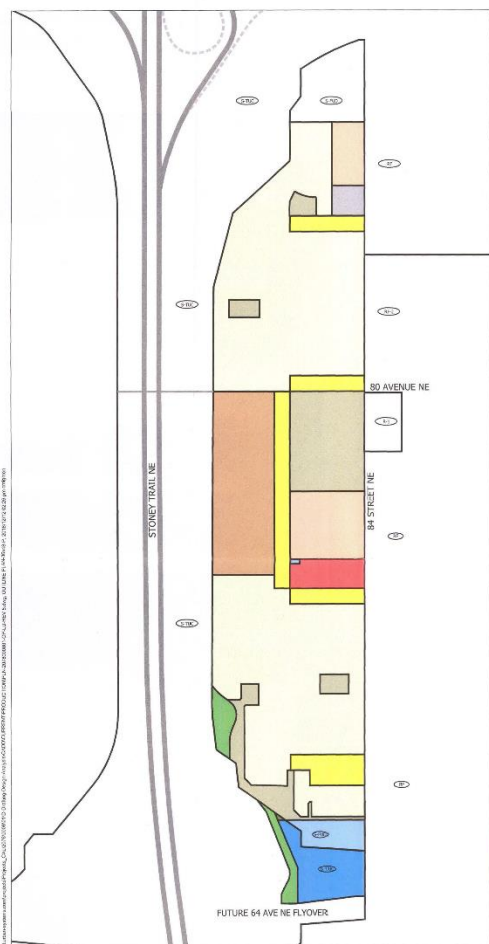

OUTLINE PLAN

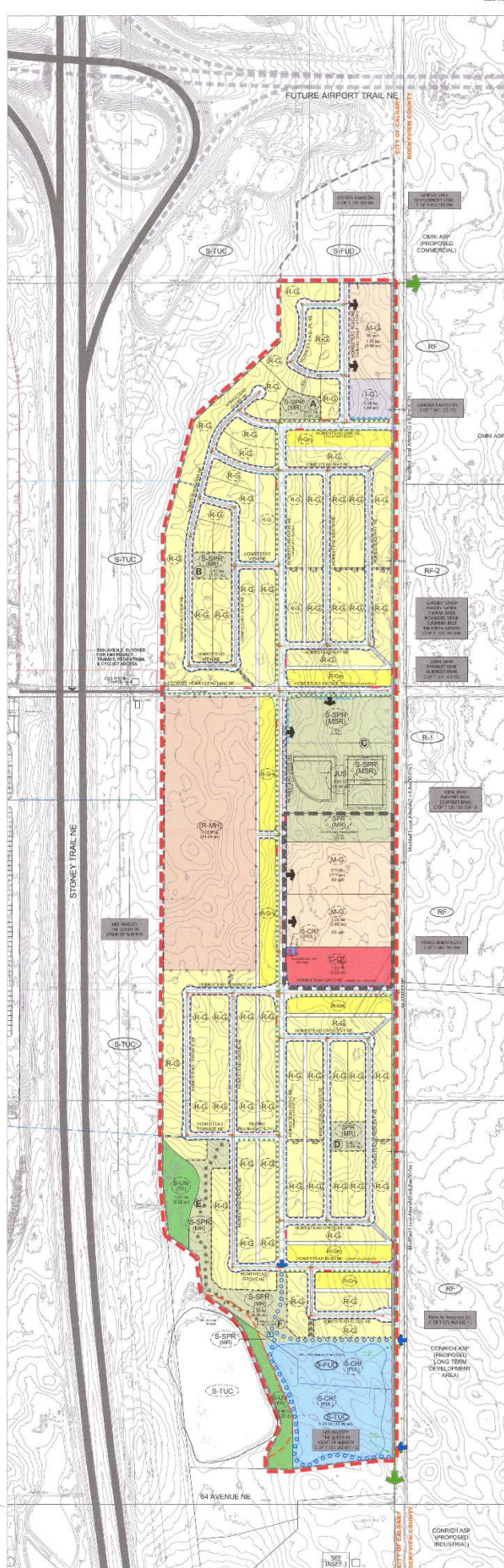

CONTEXT PLAN



OUTLINE PLAN LEGEND

- EAST STONEY AREA STRUCTURE PLAN BOUNDARY
- OUTLINE PLAN BOUNDARY
- NAC BOUNDARY
- EXISTING LAND USE
- PROPOSED LAND USE
- ENVIRONMENTAL RESERVE
- MUNICIPAL RESERVE
- MUNICIPAL SCHOOL RESERVE
- PUBLIC UTILITY LOT
- LAND OWNER
- 84 STREET ROAD WIDENING (5.0m)
- SEPARATE SIDEWALKS
- REGIONAL PATHWAY (3.0m)
- GREEN CONDUIT (3.0m)
- PATHWAY/MAINTENANCE ACCESS (3.5m)
- EXISTING CONTOUR
- ROAD DESIGNATION
- STORM SEWER LINE
- SANITARY SEWER LINE
- WATER LINE
- CHAIN LINK FENCE
- WOOD FENCE
- BUS PAD LOCATION
- RIGHT TURN-IN AND RIGHT TURN-OUT ONLY
- ACCESS (ACCESS TO SITES)
- POND MAINTENANCE ACCESS

OUTLINE PLAN STATISTICS

	No.	Acres	%
Gross Developable Area	96.15	237.59	
Loss	1.91	4.72	
Net Developable Area	94.24	232.87	100
R-G (Residential - Low Density Mixed Housing District)	36.52	90.24	39
R-Gm (Residential - Low Density Mixed Housing District)	5.11	12.63	5
R-MH (Residential - Medium Density Mixed Housing District)	10.69	26.53	11
M-G (Multi-Residential - All Grade Housing District)	6.86	16.95	8
I-G (Industrial - General District)	0.68	1.68	1
C-1 (Commercial - Community 1 District)	1.59	3.93	2
S-SPR (Special Purpose - School, Park and Community Reserve District)	9.84	24.31	10
S-CU (Special Purpose - Community Service District)	3.27	8.12	4
S-OU (Special Purpose - School, Park and Community Reserve District)	1.82	4.50	2
S-FUD (Urban Nature District)	1.94	4.79	5

	DENSITY ANALYSIS	
Density Calculations		
R-G - Single Family	1000/1.0	1000
R-Gm - Single Family	1000/1.0	1000
R-MH - Residential Medium Density	1000/1.0	1000
M-G - Multi-Residential	1000/1.0	1000
I-G - Industrial	1000/1.0	1000
C-1 - Commercial	1000/1.0	1000
S-SPR - Special Purpose	1000/1.0	1000
S-CU - Special Purpose	1000/1.0	1000
S-OU - Special Purpose	1000/1.0	1000
S-FUD - Urban Nature	1000/1.0	1000

- NOTES
- Information outside of the Outline Plan boundary is provided for information purposes only.
 - Colour Shading = 0.5 meters.
 - All dimensions shown in meters.
 - That subject to change without notice.
 - All lanes are 7.5m wide.
 - Lanes are enclosed within the Road Street ASP.
 - High Water Level (HWL) of pond is conceptual only and will be confirmed at final design.

APPROVED BY CPC, October 18, 2018
(LOC-2017-0111)

	DATE	DESCRIPTION
1	10/18/18	APPROVED BY CPC
2	10/18/18	APPROVED BY CPC
3	10/18/18	APPROVED BY CPC
4	10/18/18	APPROVED BY CPC
5	10/18/18	APPROVED BY CPC
6	10/18/18	APPROVED BY CPC
7	10/18/18	APPROVED BY CPC

URBAN systems
Suite 101, 1716 Sunridge Way NE | Calgary, Alberta | T2Y 3S6
T: 403.291.1119 | F: 403.291.1174
urban@urbansystems.ca



CITY OF CALGARY

HOMESTEAD OUTLINE PLAN

Portions of NE, SE 12-25-29-4 and Portions NE, SE 13-25-29-4

Scale: 1:3000
2078.0008.01
Date: 2018.08.13
OUTLINE PLAN
PLN-OP/LU-5