

Approved Outline Plan

Calgary Planning Commission is the Approving Authority for the Outline Plan. Attachment for Council's reference only.

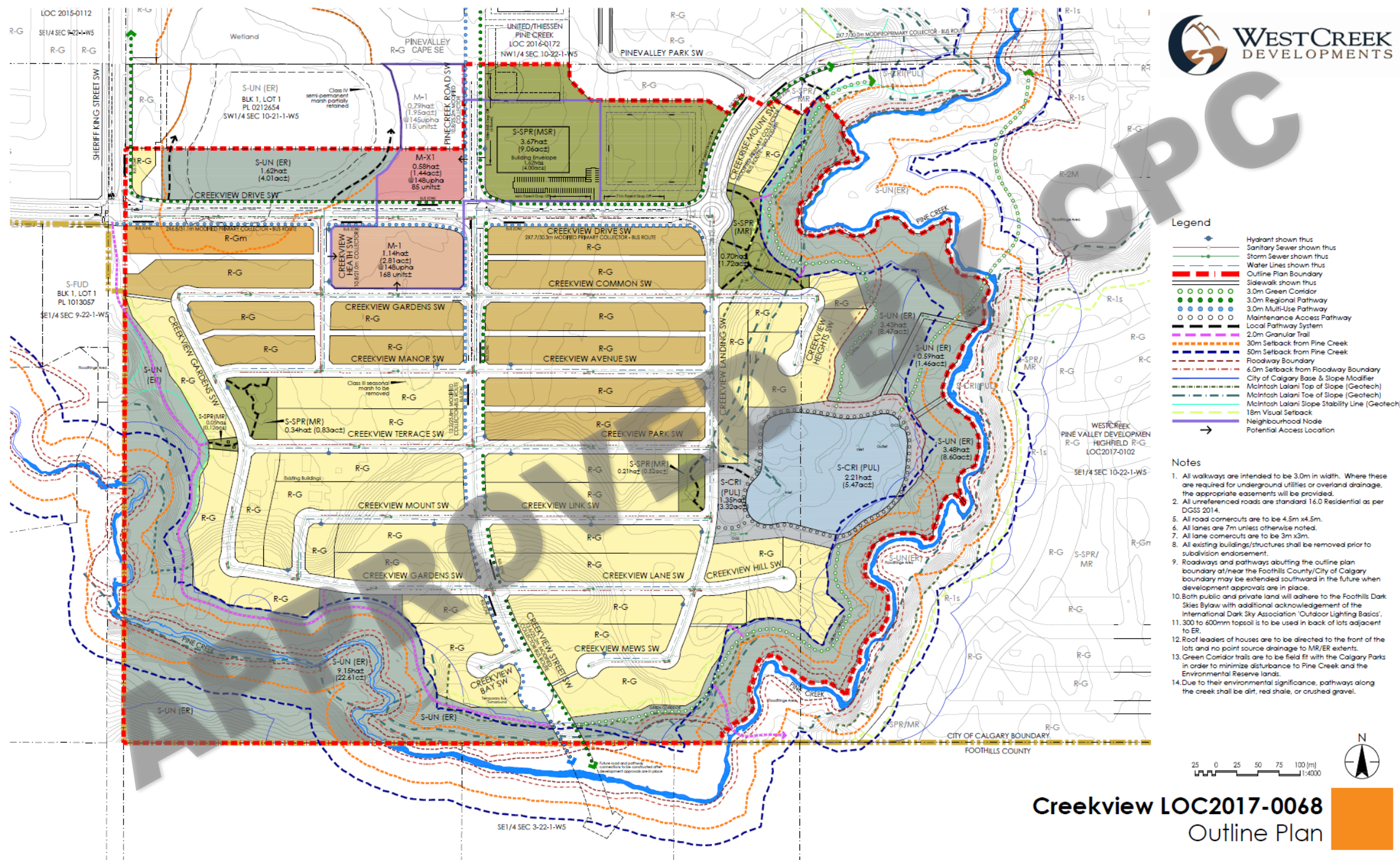



Outline Plan Statistics

Total Area Outlined 67.85 ha± (167.67 ac±)
 Environmental Reserve (S-UN) 18.27 ha± (45.15 ac±)
 Gross Developable Area 49.58 ha± (122.52 ac±)

R-G (Laneless) 17.72 ha± (43.78 ac±)
 Approximate Frontage 4,562 m± (14,967 ft±)
 Anticipated No. of Lots 438 lots±
 Maximum No. of Lots 456 lots±

R-G (Laned) 7.94 ha± (19.63 ac±)
 Approximate Frontage 2,326 m± (7,631 ft±)
 Anticipated No. of Lots 258 lots±
 Maximum No. of Lots 310 lots±

R-Gm 0.74 ha± (1.82 ac±)
 Approximate Frontage 223 m± (731 ft±)
 Anticipated No. of Lots 34 lots±
 Maximum No. of Lots 37 lots±

M-1 1.14 ha± (2.81 ac±)
 Ant. No. of Units (148 upha) 168 units±
 Max. No. of Units (148 upha) 168 units±

M-X1 0.58 ha± (1.44 ac±)
 Ant. No. of units (148 upha) 85 units±
 Max. No. of units (148 upha) 85 units±

Anticipated Density $\frac{983}{49.58 \text{ ha} \pm (122.52 \text{ ac} \pm)}$
 =19.82 upha± (8.0 upac±)

Maximum Density $\frac{1056}{49.58 \text{ ha} \pm (122.52 \text{ ac} \pm)}$
 =21.30 upha± (8.6 upac±)

Areas of Public Dedication

Roads

Total Roads 12.94 ha± (32.00 ac±) (26.1%)
 S-CRI (Pond) 3.56 ha± (8.79 ac±) (7.2%)
 Total Public Dedication 16.50 ha± (40.79 ac±) (33.3%)

Open Space Areas

S-SPR (Joint JUS) 3.67 ha± (9.06 ac±)
 S-SPR (Parks) 1.29 ha± (3.19 ac±)
 Total 4.96 ha± (12.25 ac±) (10.0%)

Intensity Statistics

Anticipated Population	Anticipated Jobs	Anticipated Density UPH	People & Jobs per GDHA
2780	39	19.8	56.85

Creekview LOC2017-0068
Outline Plan - Statistics



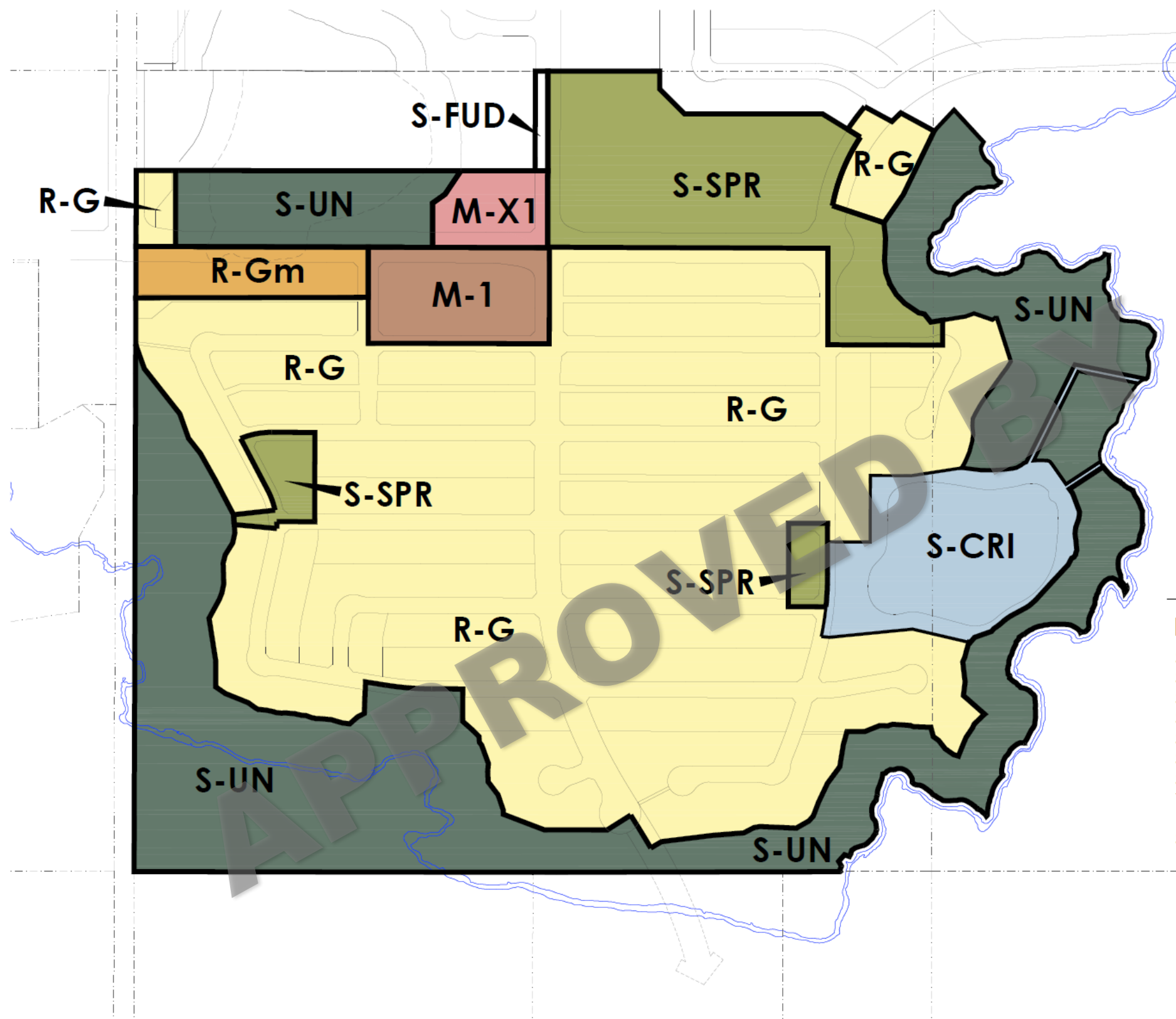

CPC

Land Use Statistics

S-FUD to R-G	35.01 ha±	(86.52 ac±)
S-FUD to R-Gm	1.20 ha±	(2.97 ac±)
S-FUD to M-1	1.77 ha±	(4.37 ac±)
S-FUD to M-X1	0.84 ha±	(2.08 ac±)
S-FUD to S-CRI	3.64 ha±	(8.99 ac±)
S-FUD to S-SPR	6.35 ha±	(15.69 ac±)
S-FUD to S-UN	18.91 ha±	(46.74 ac±)
Total Redesignation	67.72 ha±	(167.36 ac±)
S-FUD (not to be redesignated)	0.13 ha±	(0.31 ac±)



Creekview LOC2017-0068
Proposed Land Use



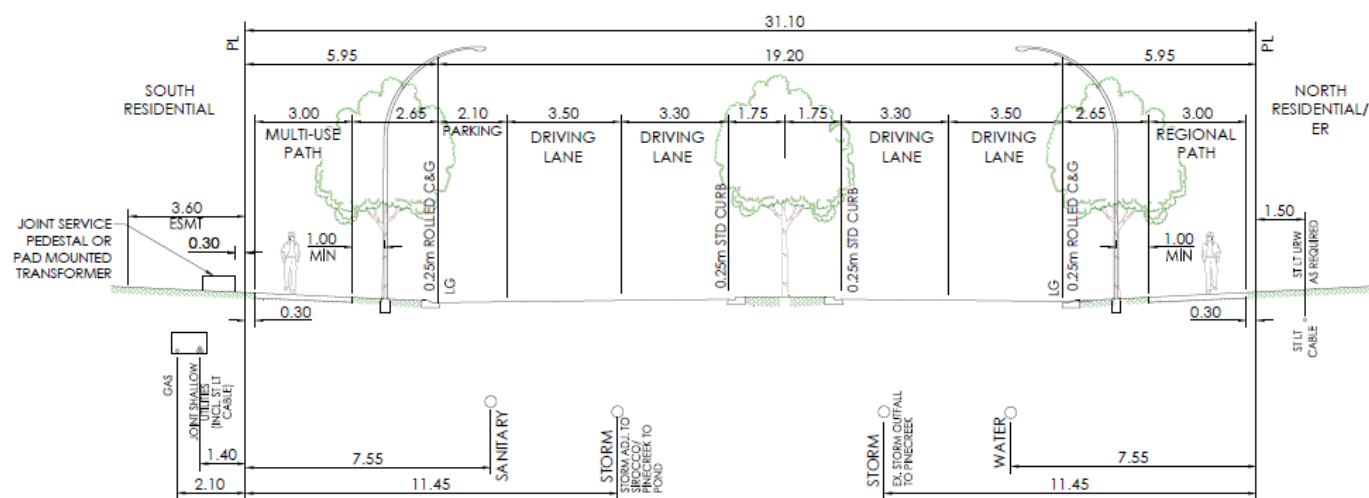

31.1m MODIFIED PRIMARY COLLECTOR
PARKING ON THE SOUTH - 3.0m MULTI-USE PATH ONE SIDE / 3.0m REGIONAL PATH ONE SIDE - BUS ROUTE
1:200

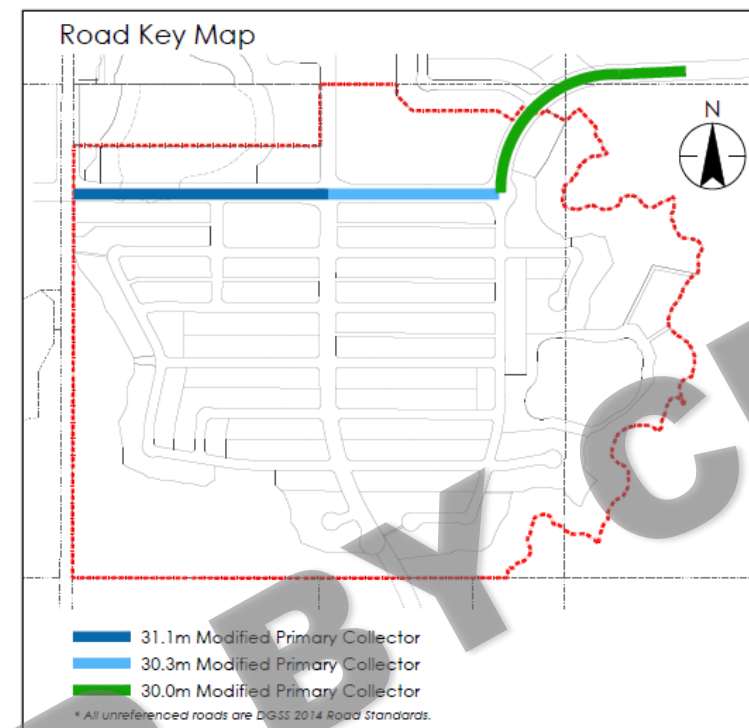

31.1m Modified Primary Collector
30.3m Modified Primary Collector
30.0m Modified Primary Collector
* All unreferenced roads are DGS 2014 Road Standards.

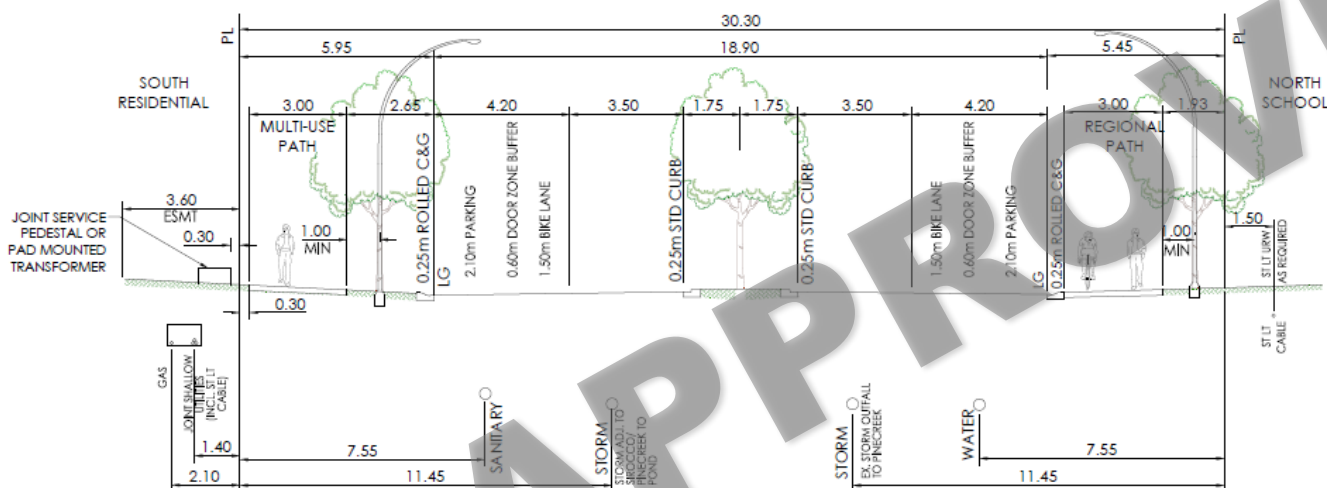

30.3m MODIFIED PRIMARY COLLECTOR
PARKING BOTH SIDES - 3.0m MULTI-USE PATH ONE SIDE / 3.0m MONO REGIONAL PATH ONE SIDE - BUS ROUTE - WITH BIKE LANES
1:200

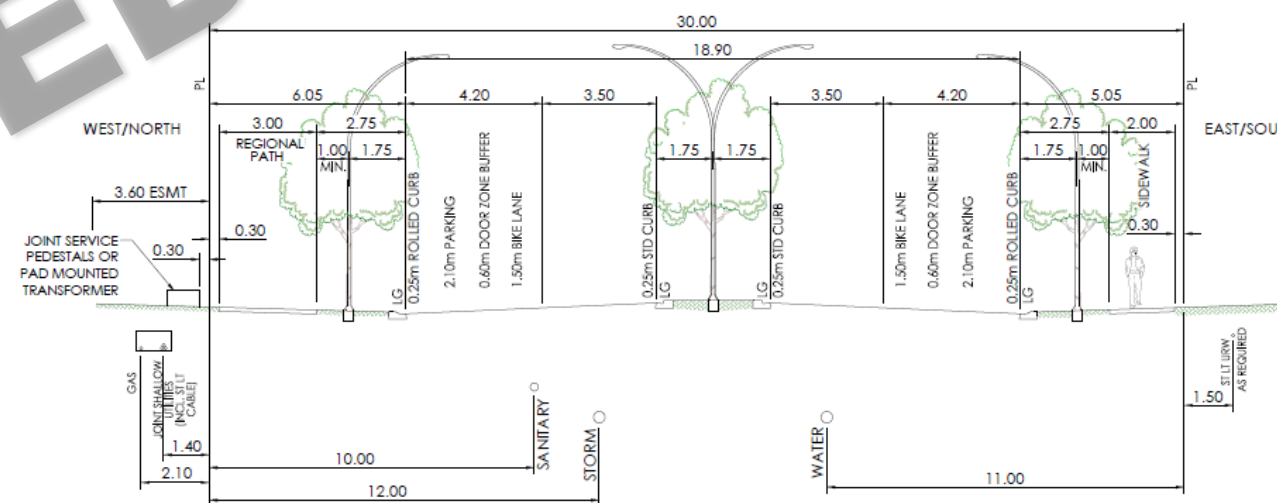

30.0m MODIFIED PRIMARY COLLECTOR
2.0m SEPARATE WALK ONE SIDE / 3.0m MULTI-USE PATH ONE SIDE - BUS ROUTE
1:200

Creekview LOC2017-0068
Road Sections - Modified Primary Collector

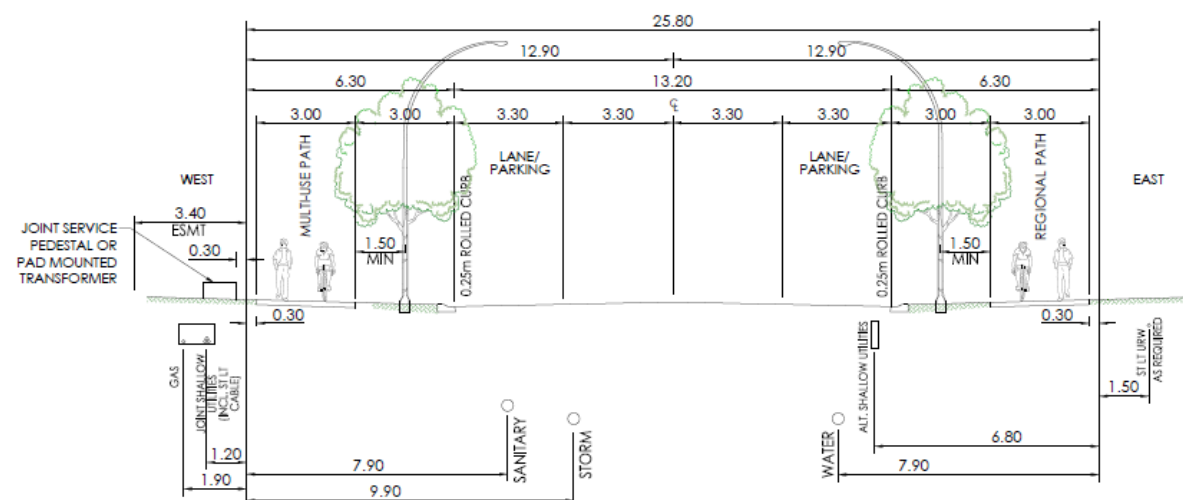

25.8m MODIFIED COLLECTOR
3.0m MULTI-USE PATH ONE SIDE / 3.0m REGIONAL PATH ONE SIDE - BUS ROUTE
1:200

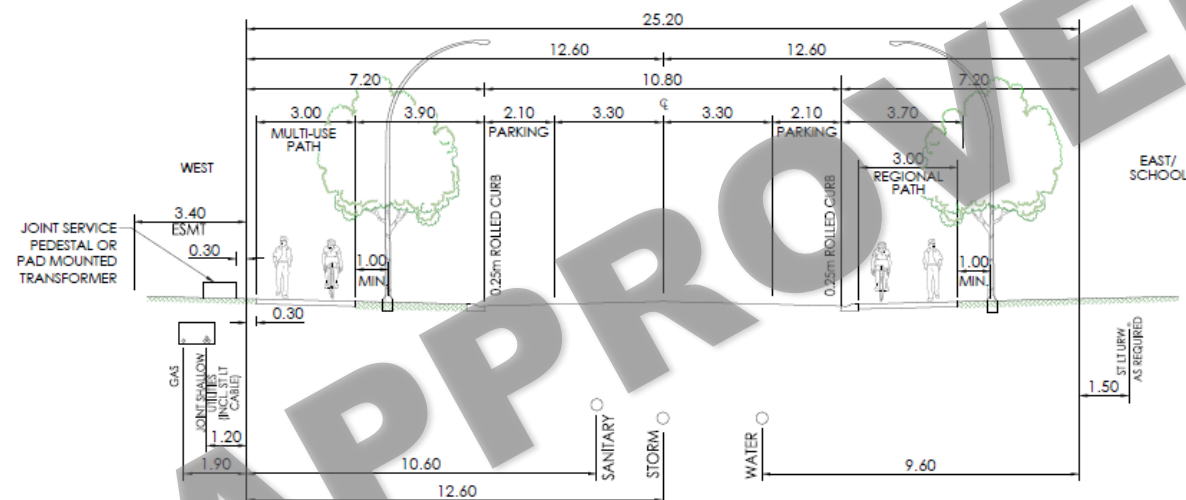

25.2m MODIFIED COLLECTOR
3.0m MULTI-USE PATH ONE SIDE / 3.0m MONO REGIONAL PATH ONE SIDE
1:200

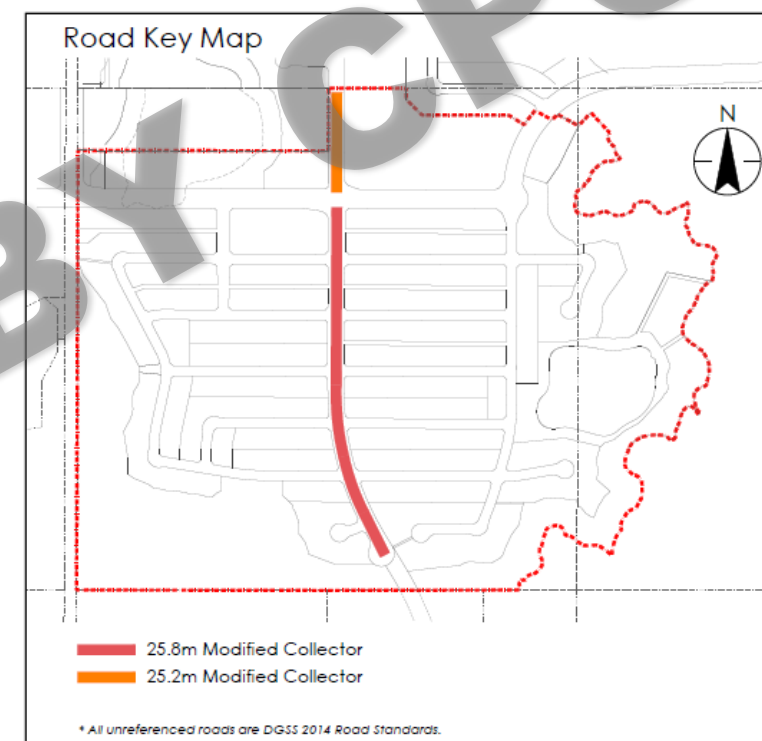

Creekview LOC2017-0068
Road Sections - Modified Collector

