

# Proposed Direct Control District

1. The Land Use Bylaw, being Bylaw 1P2007 of the City of Calgary, is hereby amended by deleting that portion of the Land Use District Map shown as shaded on Schedule "A" to this Bylaw and substituting therefor that portion of the Land Use District Map shown as shaded on Schedule "B" to this Bylaw, including any land use designation, or specific land uses and development guidelines contained in the said Schedule "B".

## SCHEDULE A

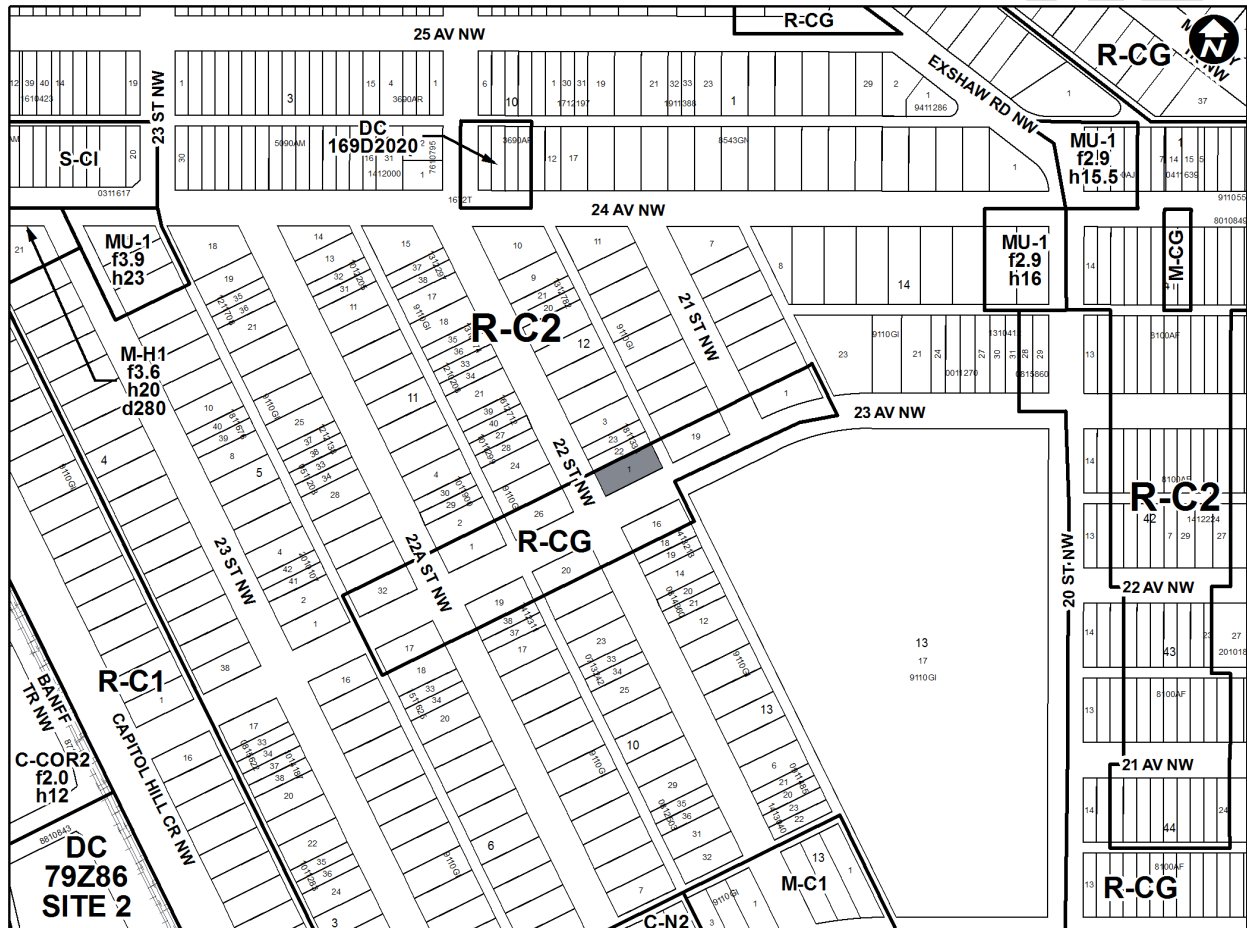
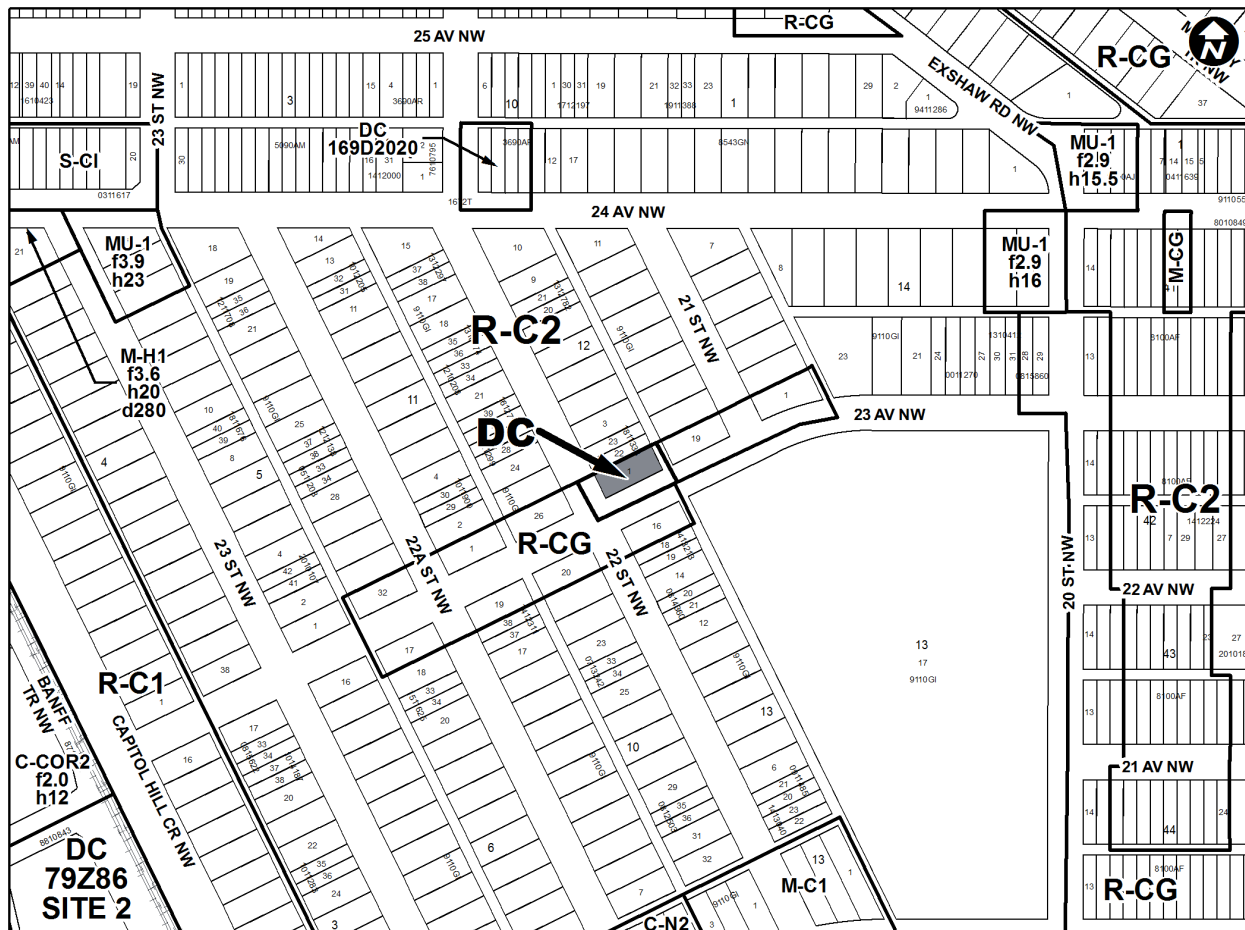

**SCHEDULE B****DIRECT CONTROL DISTRICT****Purpose**

- 1 This Direct Control District Bylaw implements the transit oriented development vision for this area by accommodating rowhouse development and establishing minimum density requirements.

**Compliance with Bylaw 1P2007**

- 2 Unless otherwise specified, the rules and provisions of Parts 1, 2, 3 and 4 of Bylaw 1P2007 apply to this Direct Control District Bylaw.

**Reference to Bylaw 1P2007**

- 3 Within this Direct Control District Bylaw, a reference to a section of Bylaw 1P2007 is deemed to be a reference to the section as amended from time to time.

**Permitted Uses**

- 4 The **permitted uses** of the Residential – Grade-Oriented Infill (R-CG) District of Bylaw 1P2007 are the **permitted uses** in this Direct Control District with the exclusion of:
  - (a) **Contextual Semi-detached Dwelling.**

**Discretionary Uses**

**5** The ***discretionary uses*** of the Residential – Grade-Oriented Infill (R-CG) District of Bylaw 1P2007 are the ***discretionary uses*** in this Direct Control District with the exclusion of:

- (a) **Cottage Housing Cluster;**
- (b) **Duplex Dwelling;**
- (c) **Semi-detached Dwelling;** and
- (d) **Single Detached Dwelling.**

**Bylaw 1P2007 District Rules**

**6** Unless otherwise specified, the rules of the Residential – Grade-Oriented Infill (R-CG) District of Bylaw 1P2007 apply in this Direct Control District.

**Density**

- 7**
- (1)** The minimum ***density*** is 55 ***units*** per hectare.
  - (2)** The maximum ***density*** is 75 ***units*** per hectare.

**Relaxations**

**8** The ***Development Authority*** may relax the rules contained in Section 6 of this Direct Control District Bylaw in accordance with Sections 31 and 36 of Bylaw 1P2007.