

Calgary



Calgary Planning Commission Agenda Item: 7.2.4



LOC2020-0023 Policy & Land Use Amendment

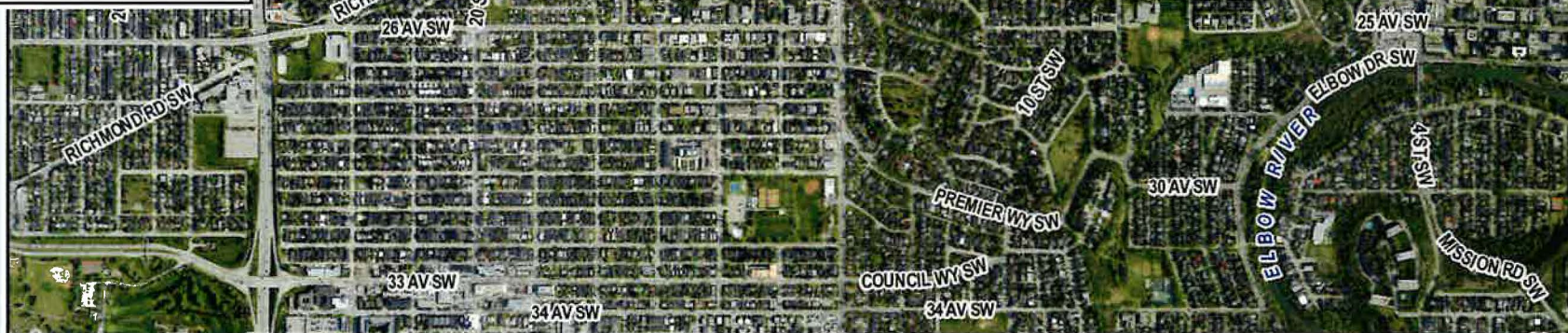





Bankview Area Redevelopment Plan

Fig. 2

Land Use Policy

Legend

- Study Area Boundary
- Conservation
- Conservation and Infill
- Medium Low Density
- Medium Density
- Neighbourhood - Mid-Rise
- Nimmons Residence Site
- Medium Density Residential With Office Use
- Local Commercial
- General Commercial
- Institutional
- Park School and Recreation

0 50
Metres

This map is conceptual only. No measurements of distances or areas should be taken from the map.

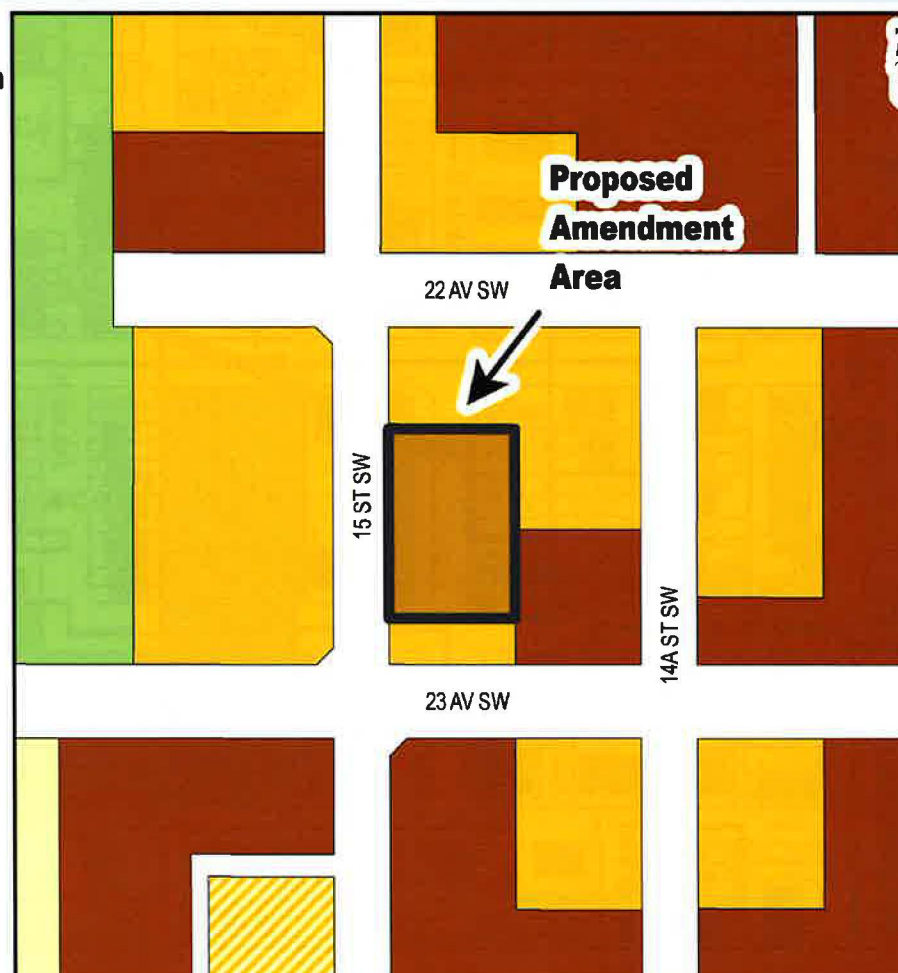

LEGEND

- Residential Low Density
- Residential Medium Density
- Residential High Density
- Commercial
- Heavy Industrial
- Light Industrial
- Parks and Openspace
- Public Service
- Service Station
- Vacant
- Transportation, Communication, and Utility
- Rivers, Lakes
- Land Use Site Boundary

From:
M-CGd111

To:
M-C2

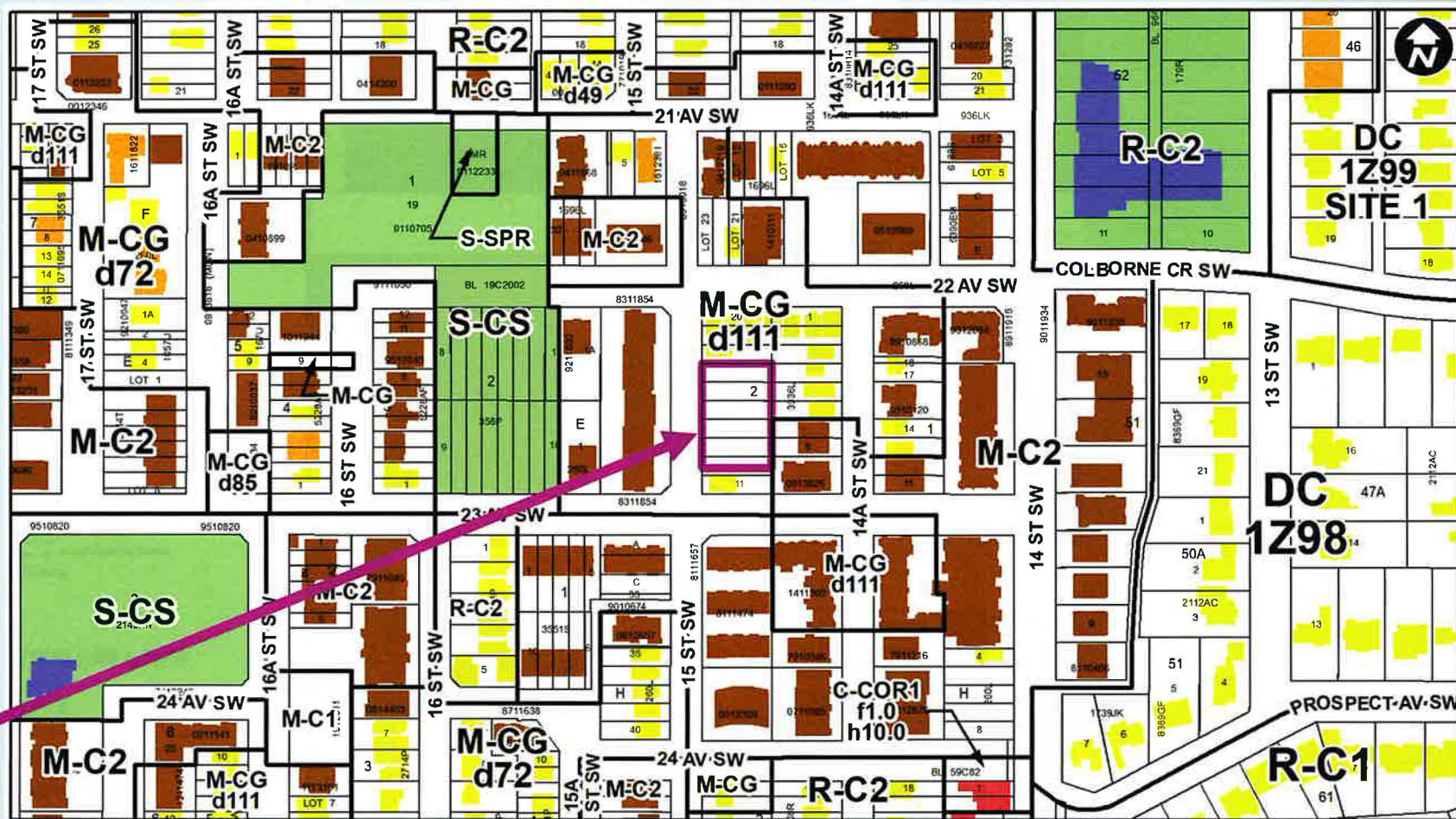

DP2019-1504

One Building, 66 units under review



Administration Recommendation

- Corporate Planning Applications Group recommends approval of:
 - An amendment to the Bankview Area Redevelopment Plan; and
 - A Land Use Amendment from M-CGd111 to M-C2.