

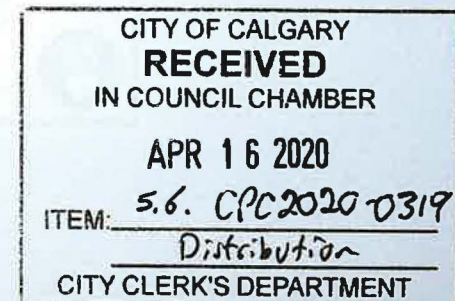

# SN2020-0002 Community Name & Street Names



# Calgary Planning Commission

## Agenda Item: 5.6

2

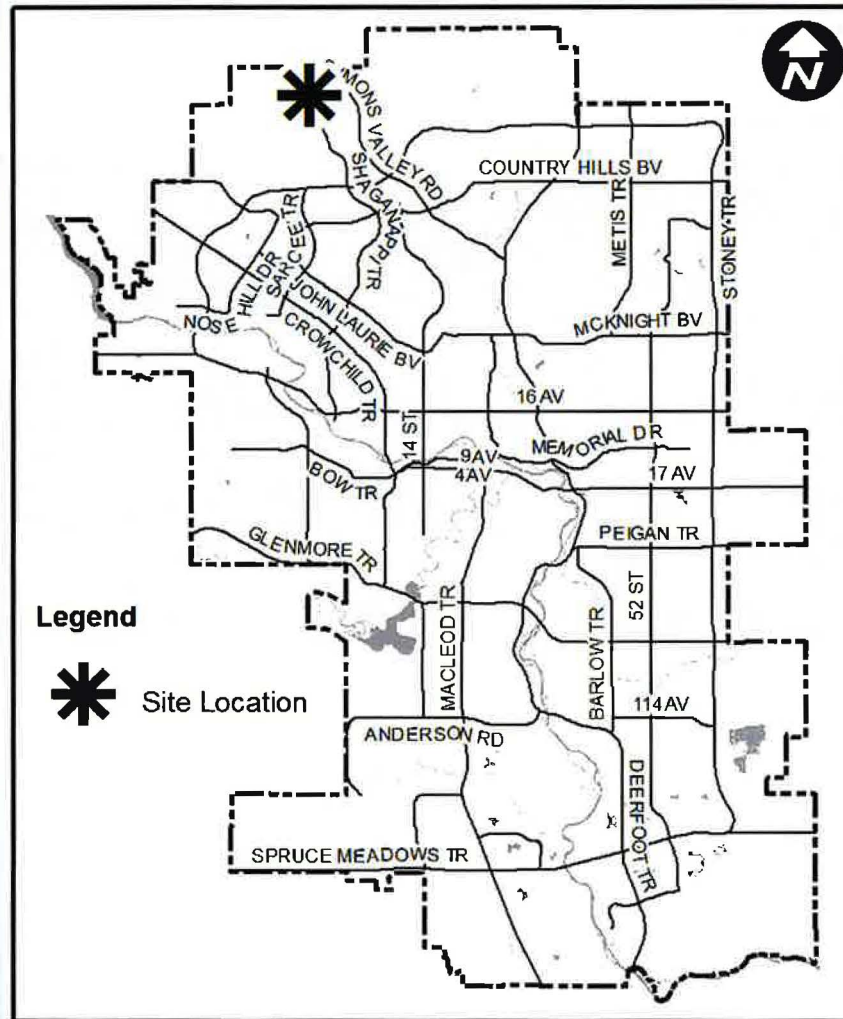

### Existing Community Names: 02K & 02L

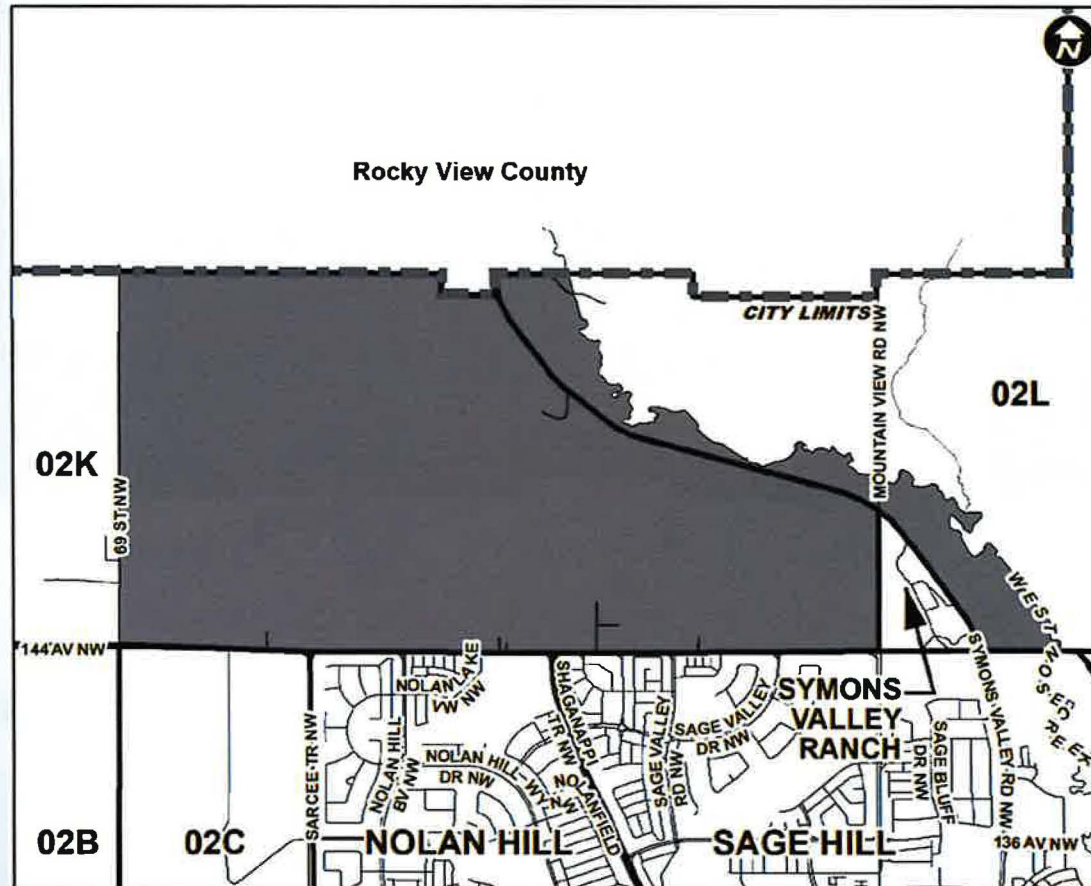



### MAP 4: COMMUNITIES AND NEIGHBOURHOODS

Approved: 49P2015  
Amended: 37P2016

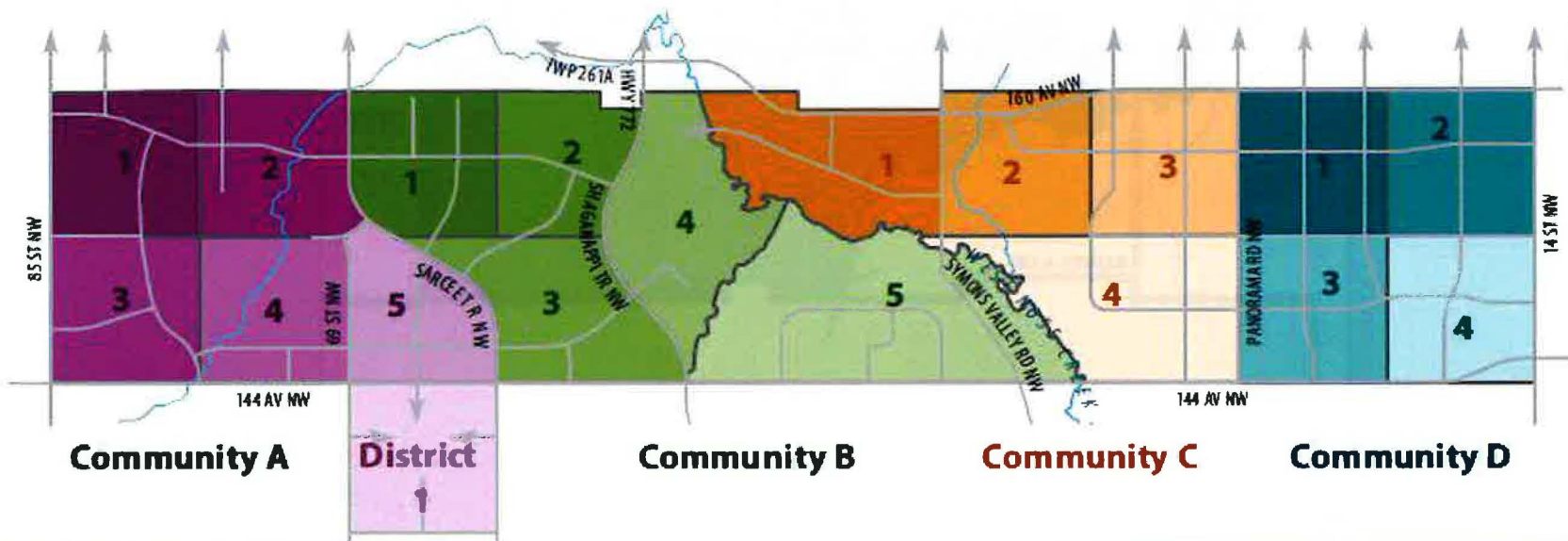

### Proposed Community Name: Glacier Ridge

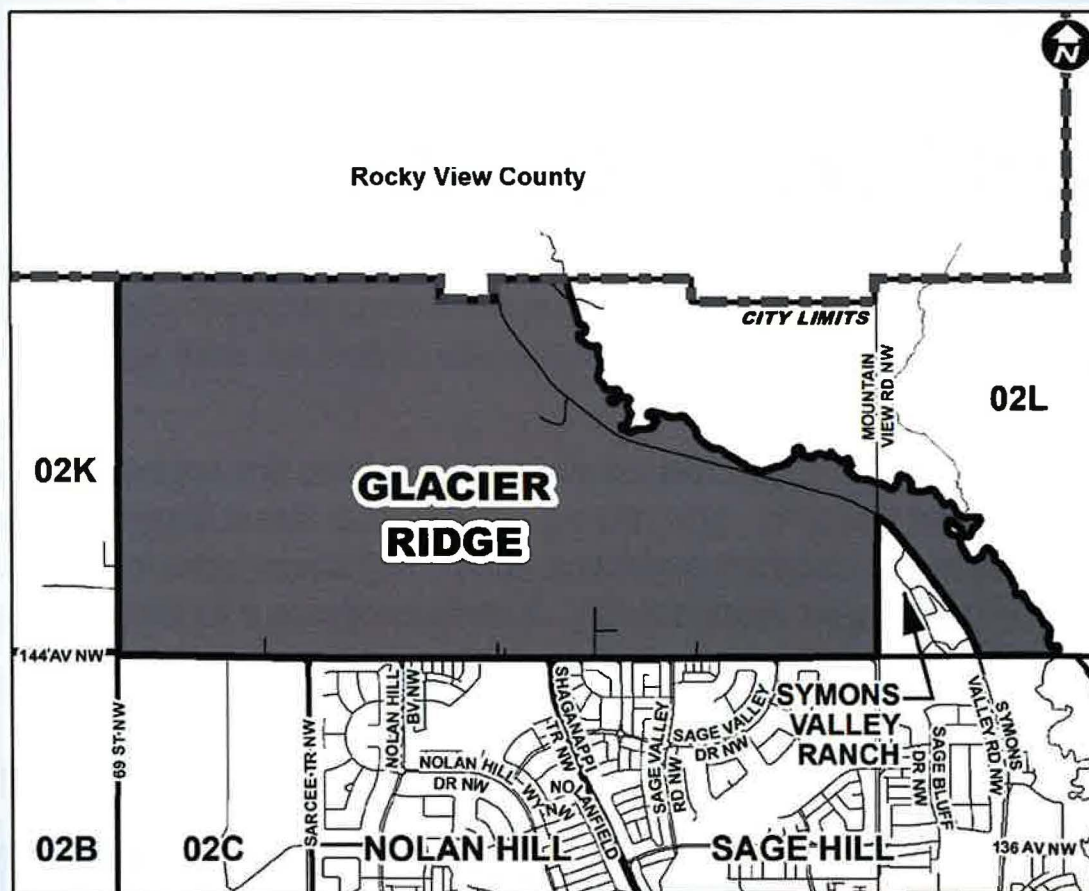



## Section 1.4 of the Glacier Ridge ASP

### 1.4 PLAN AREA ATTRIBUTES

#### TOPOGRAPHY AND NATURAL FEATURES

Glacier Ridge is characterized by a varied topography. Symons Valley, with a variety of sandstone outcroppings forms the boundary where the coulees and rolling terrain of the west half of the Plan Area transitions to gently undulating prairie landscape on the east side. Currently, much of the landscape displays its history of cultivation and ranching with some coulees and creek areas left in a natural or semi-natural state.

Glacial erratics and a glacial scour are located east of the creek. The erratics are part of the 10,000 year old Foothills Erratic Train that stretched in a narrow belt from a rock outcrop in the Mount Edith Cavell area of Jasper National Park over 600 km to southwestern Alberta.

GLACIAL ERRATIC





### Proposed Street Names:

- |            |             |              |
|------------|-------------|--------------|
| • Annette  | • Drystone  | • Oldhorn    |
| • Antler   | • Edith     | • Samson     |
| • Aquila   | • Franchere | • Throne     |
| • Ashlar   | • Maligne   | • Tekarra    |
| • Bastion  | • Majestic  | • Tonquin    |
| • Beauvert | • Marmot    | • Watchtower |
| • Chetamon | • Merlin    |              |



The developer selected the street names to represent geographical features in the Jasper National Park region. See next slide.





# Calgary Planning Commission

## Agenda Item: 5.6

8

Annette (Annette Lake)	Antler (Antler Mountain)	Aquila (Aquila Mountain)
Ashlar (Ashlar Ridge)	Bastion (Bastion Peak)	Beauvert (Beauvert Lake)
Chetamon (Chetamon Mountain)	Drystone (Drystone Creek)	Edith (Mount Edith Cavell)
Franchere (Franchere Peak)	Majestic (Majestic Mountain)	Maligne (Maligne Lake & Maligne Mountain)
Marmot (Marmot Mountain)	Merlin (Mount Merlin)	Oldhorn (Oldhorn Mountain)
Samson (Samson Peak)	Tekarra (Mount Tekarra)	Throne (Throne Mountain)
Tonquin (Tonquin Mountain pass & Tonquin Valley)	Watchtower (Mount Watchtower)	





**Do not use street types  
Crescent Place & Street with the name Marmot,  
and  
do not use street types  
Court , Place & Way with Merlin.**

# Calgary Planning Commission

## Agenda Item: 5.6

