

PROPOSED

CPC2018-1304
ATTACHMENT 2

BYLAW NUMBER 12D2019

**BEING A BYLAW OF THE CITY OF CALGARY
TO AMEND THE LAND USE BYLAW 1P2007
(LAND USE AMENDMENT
LOC2018-0168/CPC2018-1304)**

WHEREAS it is desirable to amend the Land Use Bylaw Number 1P2007 to change the land use designation of certain lands within the City of Calgary;

AND WHEREAS Council has held a public hearing as required by Section 692 of the *Municipal Government Act*, R.S.A. 2000, c.M-26 as amended;

NOW, THEREFORE, THE COUNCIL OF THE CITY OF CALGARY ENACTS AS FOLLOWS:

1. The Land Use Bylaw, being Bylaw 1P2007 of the City of Calgary, is hereby amended by deleting that portion of the Land Use District Map shown as shaded on Schedule "A" to this Bylaw and substituting therefor that portion of the Land Use District Map shown as shaded on Schedule "B" to this Bylaw, including any land use designation, or specific land uses and development guidelines contained in the said Schedule "B".
2. This Bylaw comes into force on the date it is passed.

READ A FIRST TIME ON _____

READ A SECOND TIME ON _____

READ A THIRD TIME ON _____

MAYOR

SIGNED ON _____

CITY CLERK

SIGNED ON _____

**AMENDMENT LOC2018-0168/CPC2018-1304
BYLAW NUMBER 12D2019**

SCHEDULE A

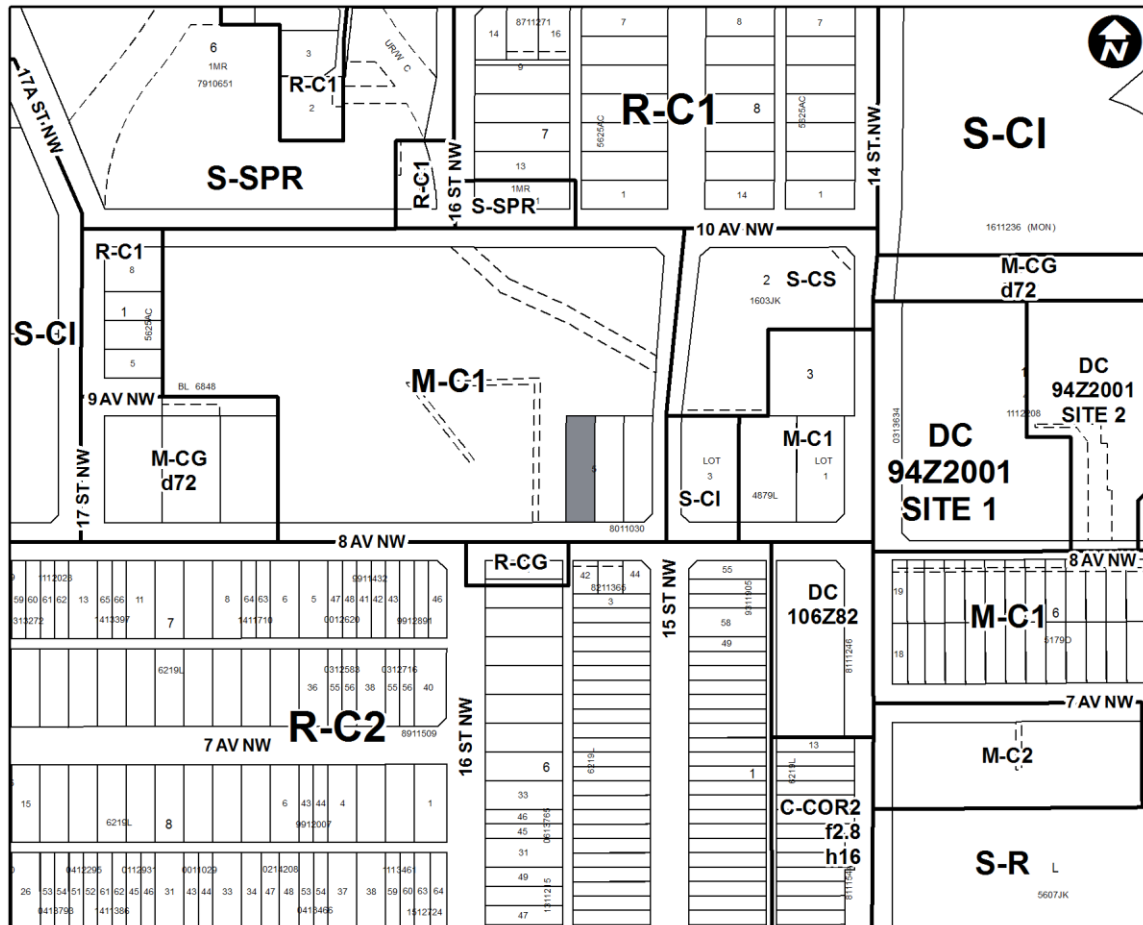

**AMENDMENT LOC2018-0168/CPC2018-1304
BYLAW NUMBER 12D2019**

The map displays a grid of lots with various zoning designations. A specific lot is highlighted with a black arrow and labeled 'DC'. The map includes a north arrow in the top right corner. Key streets shown are 17th St NW, 16th St NW, 15th St NW, 14th St NW, 10th Ave NW, 8th Ave NW, 7th Ave NW, and 3rd Ave NW. Zoning designations include S-SPR, R-C1, S-CL, M-C1, DC, M-CG d72, S-CI, R-C2, R-CG, S-R, C-COR2 f2.8 h16, and S-CL. A specific lot is highlighted with a black arrow and labeled 'DC'.

Page 3 of 4

PROPOSED

AMENDMENT LOC2018-0168/CPC2018-1304
BYLAW NUMBER 12D2019

Reference to Bylaw 1P2007

- 3 Within this Direct Control District, a reference to a section of Bylaw 1P2007 is deemed to be a reference to the section as amended from time to time.

Permitted Uses

- 4 The **permitted uses** of the Multi-Residential – Contextual Low Profile (M-C1) District of Bylaw 1P2007 are the **permitted uses** of this Direct Control District.

Discretionary Uses

- 5 The **discretionary uses** of the Multi-Residential – Contextual Low Profile (M-C1) District of Bylaw 1P2007 are the **discretionary uses** in this Direct Control District with the addition of:

- (a) **Counselling Service;**
- (b) **Medical Clinic;**
- (c) **Office; and**
- (d) **Retail and Consumer Service.**

Bylaw 1P2007 District Rules

- 6 Unless otherwise specified, the rules of the Multi-Residential – Contextual Low Profile (M-C1) District of Bylaw 1P2007 apply in this Direct Control District.

Retail and Consumer Service Additional Rules

- 7 A **Retail and Consumer Service use** must only be approved as an ancillary **use** to the **uses** listed in Section 5 (a), (b) and (c) of this Direct Control District.