

Proposed Land Use Plan

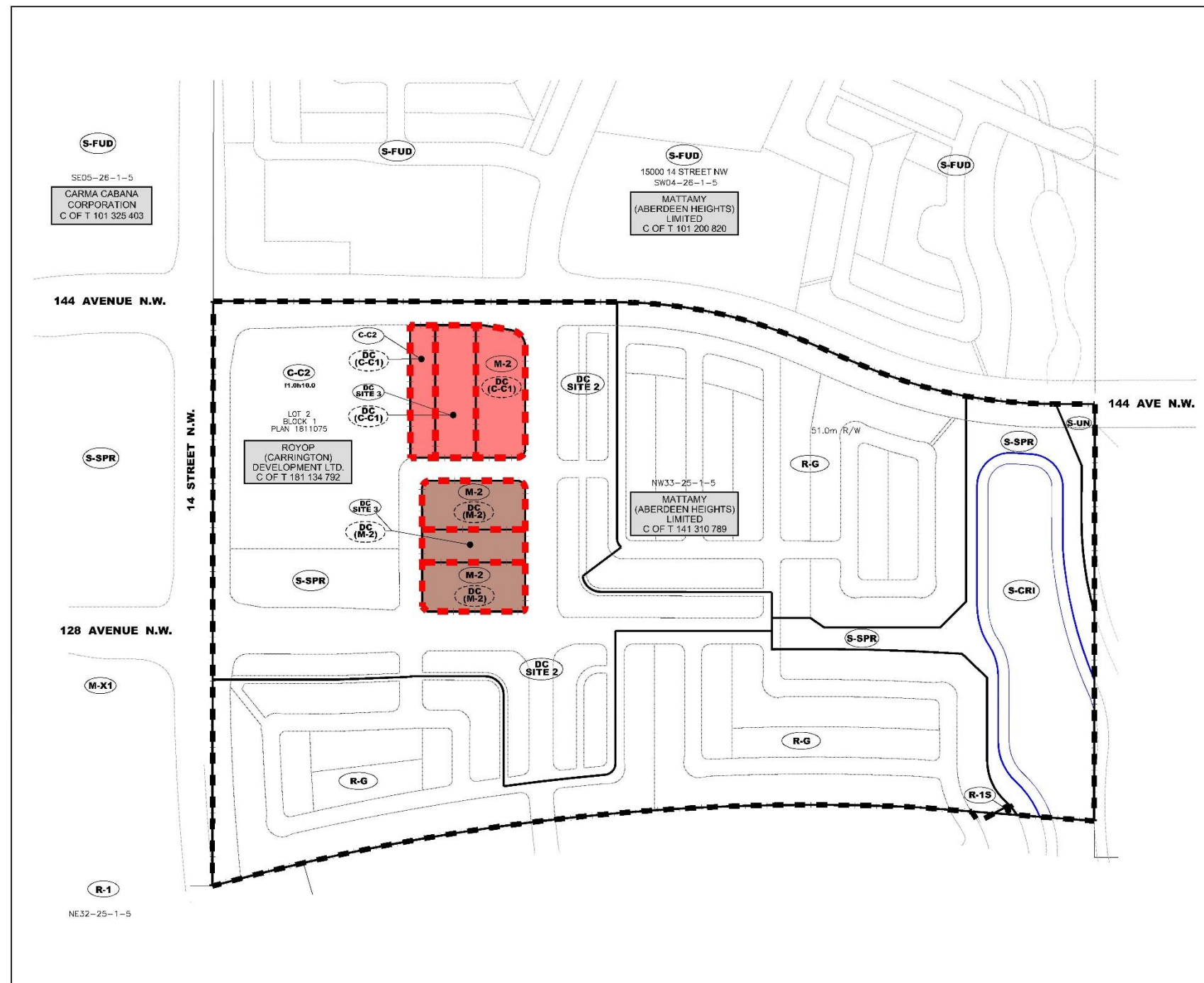

CONTEXT PLAN



LAND USE LEGEND

- LAND USE AMENDMENT BOUNDARY (2.37 ha / 5.85 ac.)
- PREVIOUS LAND USE AMENDMENT BOUNDARY
- DC SITE 2 LAND USE IN CURRENT BYLAW (117D2015)
- DC C-C1 PROPOSED LAND USE IN BYLAW (1P2007)
- Land Owner LAND OWNER

LOCATION PLAN



LAND USE STATISTICS

	ha.	ac.	%
DC SITE 3 TO DC(C-C1)	0.45	1.11	18.99
C-C2 TO DC(C-C1)	0.28	0.69	11.81
M-2 TO DC(C-C1)	0.53	1.31	22.37
M-2 TO DC(M-2)	0.83	2.05	35.02
DC SITE 3 TO DC(M-2)	0.28	0.69	11.81
TOTAL	2.37	5.85	100.00

Notes

1. Information outside of the Land Use Amendment Plan boundary is provided for information purposes only.
2. Plan subject to change without notice.
3. Lands are contained within the Keystone Hills ASP (15P2012)

PROPOSED PLAN ONLY
SUBJECT TO REVIEW AND APPROVAL
BY CPC AND CITY COUNCIL

URBAN
systems

#101-134 - 11th Avenue SE
Calgary, Alberta | T2G 0X5
T 403.291.1193 | F 403.291.1374
www.urbansystems.com

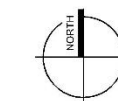

SCALE 1:4000

2800.0008.61
Date: 2019/05/22
LAND USE AMENDMENT

PLN-LU-01



CARRINGTON LAND USE AMENDMENT

CITY OF CALGARY

LEGAL DESCRIPTION: Parts of S.W. 4-26-1-5 and N.W. 33-25-1-5 MUNICIPAL ADDRESS: 15000 14 ST NW; 14400 14 ST NW; 14120 14 ST NW