



LOC2023-0151 Opposition

**Public Hearing Meeting of Council
May 7, 2024**

[SaveNoseCreek.com](https://www.SaveNoseCreek.com)

4 Areas of Advocacy



Watershed

**Community
GreenSpace**

History

Biodiversity

SaveNoseCreek.com

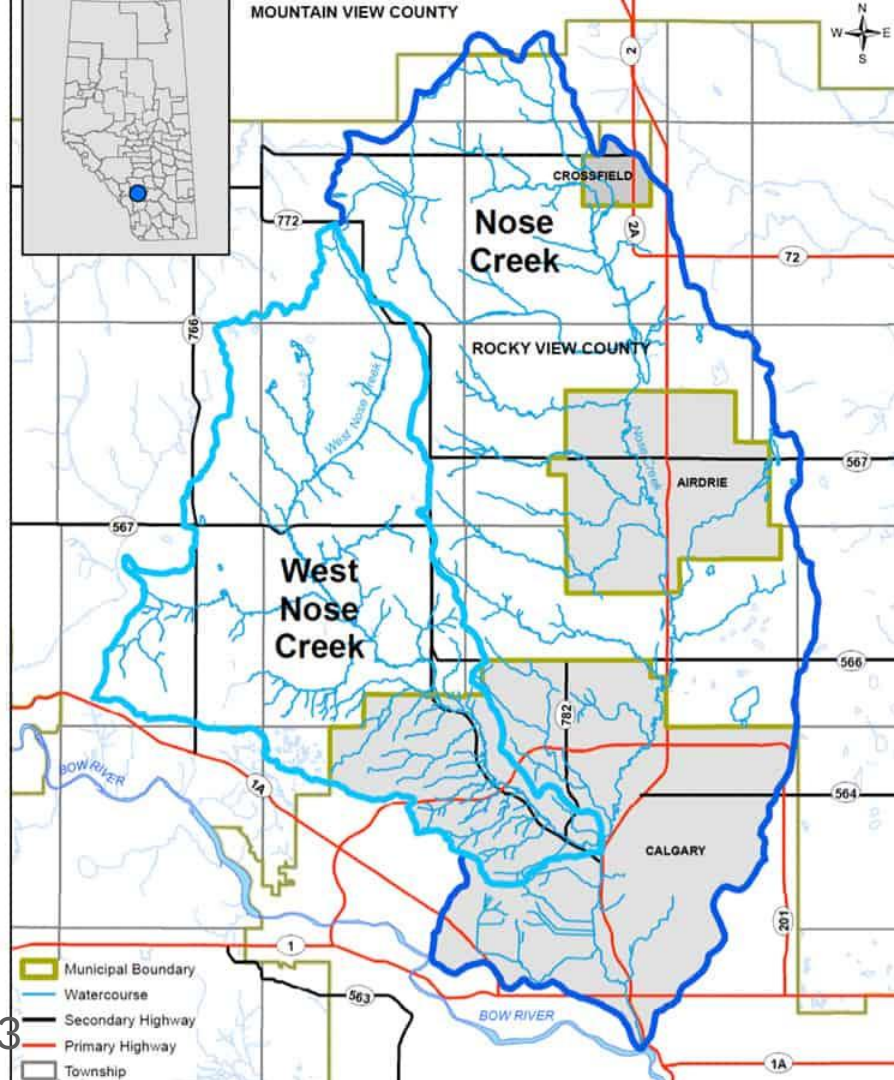

Nose Creek Watershed



Watershed Facts

- Watershed area = 989 km²
- Calgary area = 825.3 km²

West Nose Creek Facts

- Starts around Madden, AB
- 2018 Study Shows:
 - ◆ 37% healthy
 - ◆ 13% unhealthy
 - ◆ 50% healthy (with problems)

SaveNoseCreek.com

Nose Creek Watershed Partnership



Partners

- Bow River Basin Council
- Calgary
- Airdrie
- Rocky View County
- Crossfield
- Calgary Airport Authority

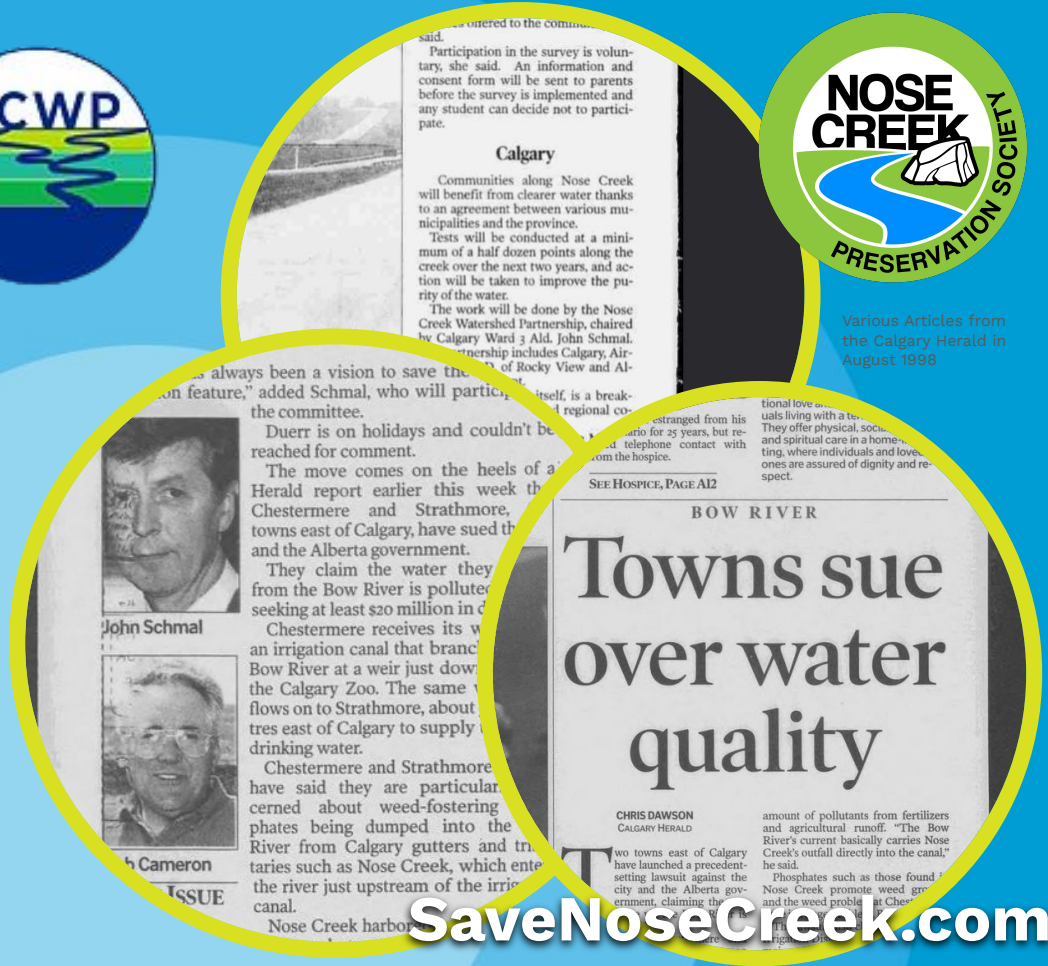

SaveNoseCreek.com

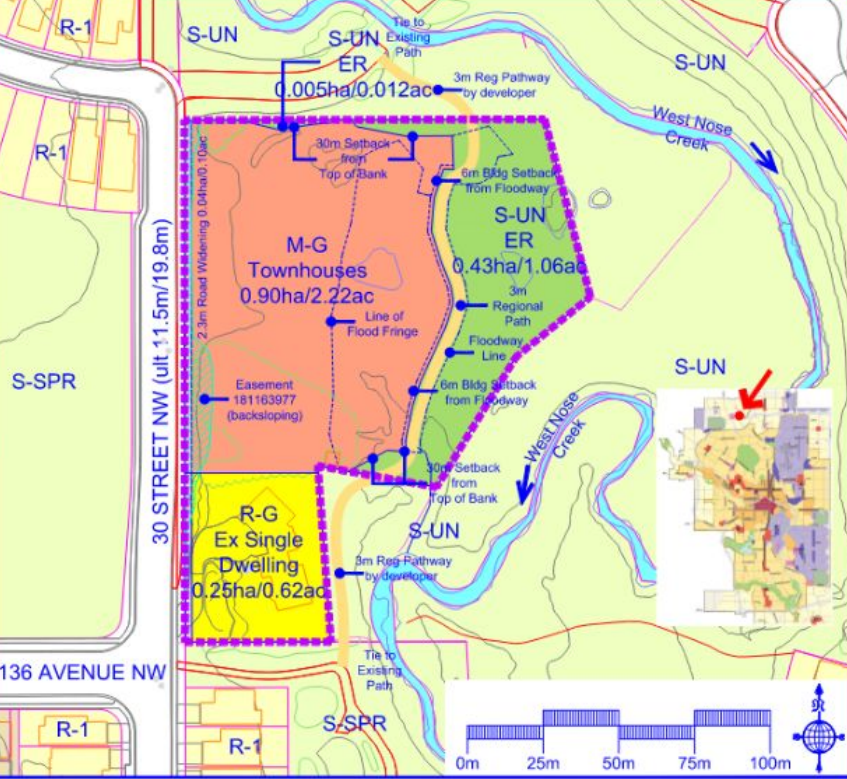

Alberta Government
Flood Hazard Maps
for the area.

Application Setbacks

- Only uses Floodway for S-UN
- Includes 1 in 100-year Flood Fringe in M-G
- Could support if Flood Fringe was S-UN

SaveNoseCreek.com



Calgary Setback Policy



- Weak / Non-Existent
- 60m Setback “Guideline” not being enforced
- No Policy to enforce “Guideline”

Waterbody	Substrate	Minimum Setback	Modifiers
Nose Creek Upstream of the confluence with West Nose Creek	Glacial till	30 m	If the average cross fall slope of a defined setback area is more than 5%, increase the width of the setback by 1.5 m for every 1% of slope greater than 5%
West Nose Creek			
All other permanent creeks	Coarse textured sands and gravels, alluvial sediments	60 m	None
Nose Creek Downstream of the confluence with West Nose Creek	All soil types	50 m	If the average cross fall slope of a defined setback area is more than 5%, increase the width of the setback by 1.5 m for every 1% of slope greater than 5%



60m line segments to show actual Riparian Setback length agreed to in the Nose Creek Watershed Partnership.

Ref: Nose Creek Watershed Water Management Plan (2018) -Page 33
Nose Creek Watershed Partnership

SaveNoseCreek.com